

**Qty. Description**

1 CRI 20-5 A-FGJ-A-V-HQQV



Note! Product picture may differ from actual product

Product No.: [96500611](#)

Vertical, multistage centrifugal pump with inlet and outlet ports on same the level (inline). Pump materials in contact with the liquid are in stainless steel. A cartridge shaft seal ensures high reliability, safe handling, and easy access and service. Power transmission is via a rigid split coupling. Pipe connection is via combined DIN-ANSI-JIS flanges.

The pump is fitted with a 3-phase, fan-cooled asynchronous motor.

**Liquid:**

Pumped liquid: Water  
Liquid temperature range: -20 .. 90 °C  
Selected liquid temperature: 20 °C  
Density: 998.2 kg/m³

**Technical:**

Pump speed on which pump data are based: 2919 rpm  
Rated flow: 21 m³/h  
Rated head: 58 m  
Pump orientation: Vertical  
Shaft seal arrangement: Single  
Primary shaft seal: HQQV  
Code for shaft seal: HQQV  
Approvals: CE,EAC,UKCA,SEPRO  
Approvals for drinking water: WRAS,ACS  
Curve tolerance: ISO9906:2012 3B

**Materials:**

Base: Stainless steel  
EN 1.4408  
AISI 316  
Impeller: Stainless steel  
EN 1.4301  
AISI 304  
Bearing: SIC

**Installation:**

Maximum ambient temperature: 60 °C  
Maximum operating pressure: 16 bar  
Max pressure at stated temp: 16 bar / 90 °C  
16 bar / -20 °C  
Type of connection: DIN / ANSI / JIS  
Size of inlet connection: DN 50  
2 inch  
Size of outlet connection: DN 50  
2 inch  
Pressure rating for connection: PN 25



Company name:

Created by:

Phone:

Date:

01/10/2025

Qty.	Description
------	-------------

1	Flange rating inlet: 300 lb Flange size for motor: FF265  Electrical data: Motor standard: IEC Motor type: 132SC Rated power - P2: 5.5 kW Power (P2) required by pump: 5.5 kW Mains frequency: 50 Hz Rated voltage: 3 x 380-415D V Rated current: 11 A Starting current: 1080-1180 % Cos phi - power factor: 0.87-0.82 Rated speed: 2920-2940 rpm IE Efficiency class: IE3 Motor efficiency at full load: 89.2 % Motor efficiency at 3/4 load: 90.0-89.8 % Motor efficiency at 1/2 load: 89.6-88.4 % Number of poles: 2 Enclosure class (IEC 34-5): 55 Dust/Jetting Insulation class (IEC 85): F Motor No: 85U17417  Controls: Frequency converter: None  Others: Terminal box position: 6 Minimum efficiency index, MEI ≥: 0.70 Net weight: 87 kg Gross weight: 109 kg Shipping volume: 0.285 m <sup>3</sup>
---	--

## 96500611 CRI 20-5 A-FGJ-A-V-HQQV 50 Hz

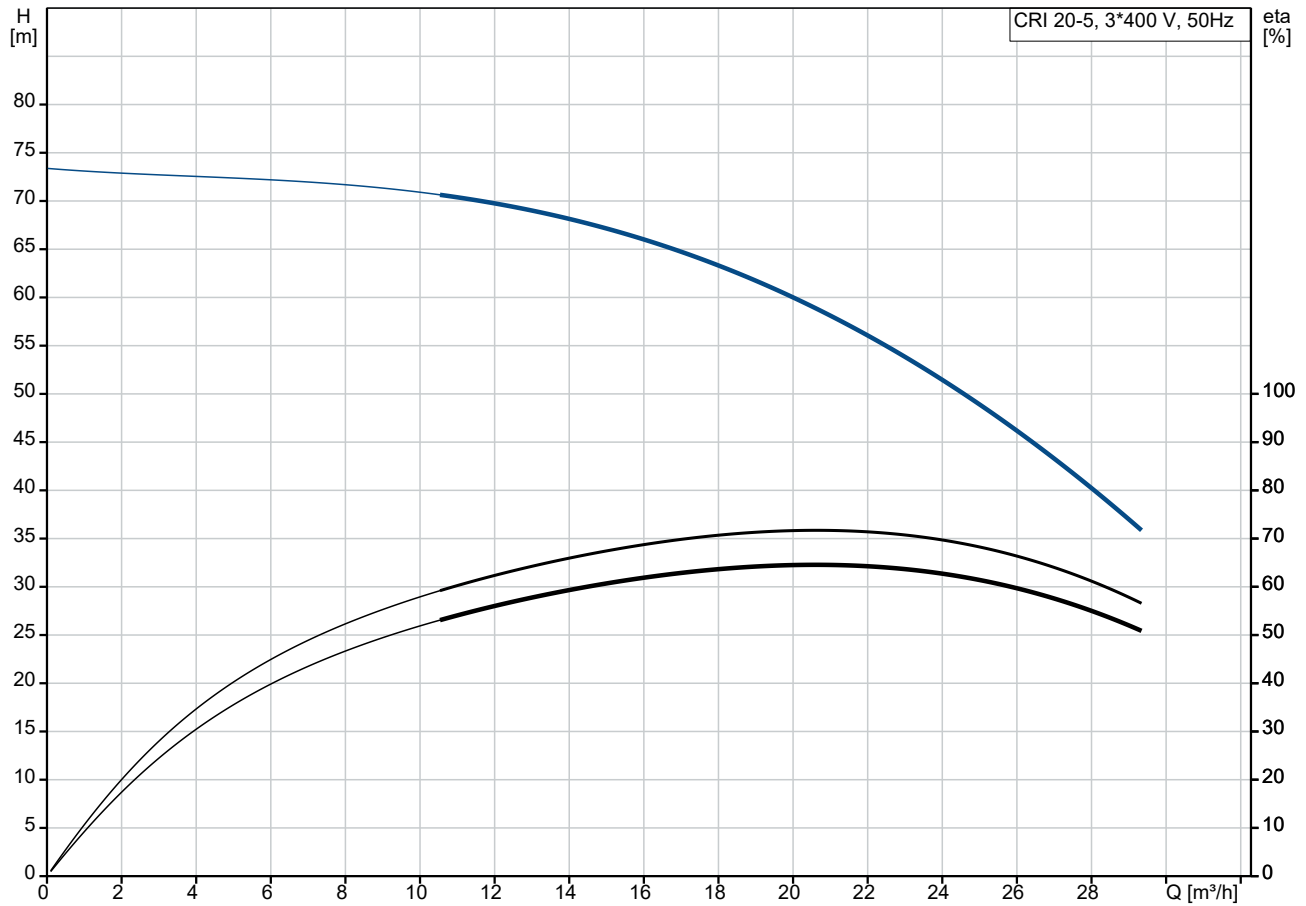

Pumped liquid = Water  
 Liquid temperature during operation = 20 °C  
 Density = 998.2 kg/m³

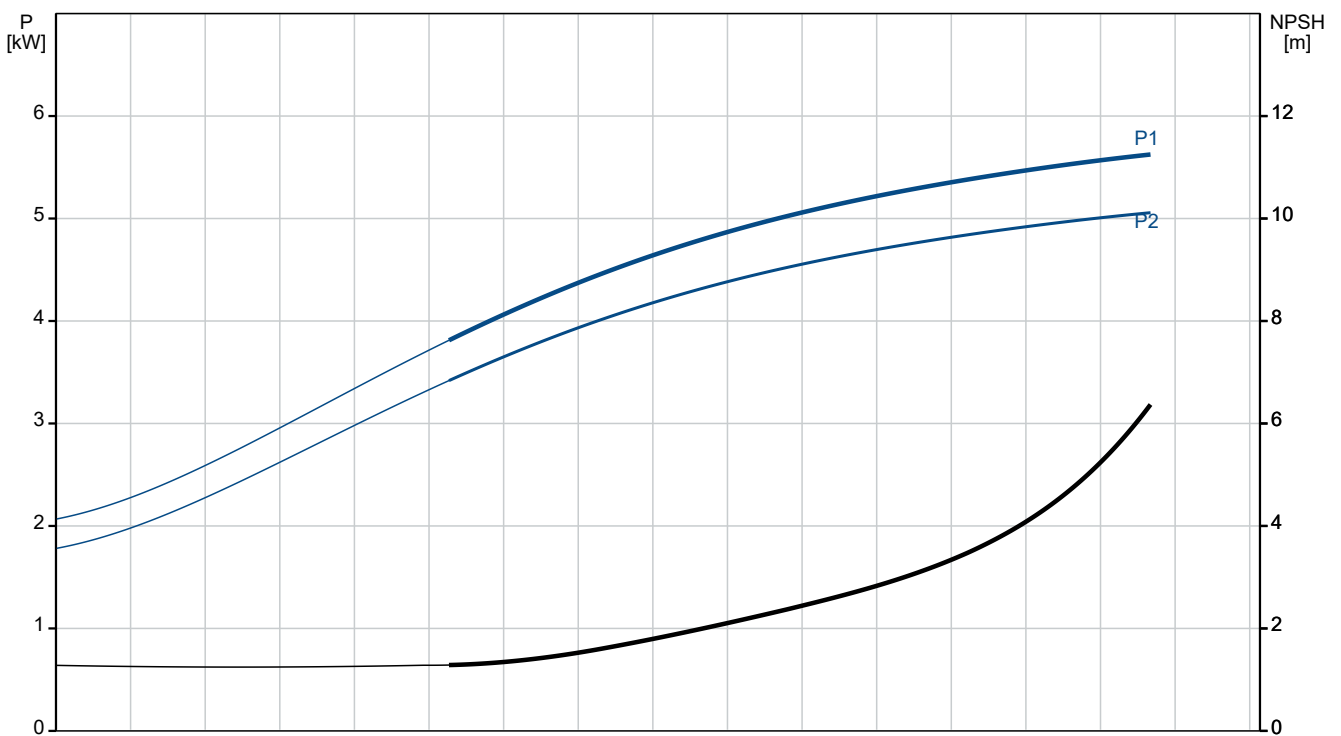

Description	Value
<b>General information:</b>	
Product name:	CRI 20-5 A-FGJ-A-V-HQQV
Product No:	96500611
EAN number:	5700396205281
Price:	
<b>Technical:</b>	
Pump speed on which pump data are based:	2919 rpm
Rated flow:	21 m³/h
Rated head:	58 m
Maximum head:	73.4 m
Stages:	5
Impellers:	5
Number of reduced-diameter impellers:	0
Low NPSH:	N
Pump orientation:	Vertical
Shaft seal arrangement:	Single
Primary shaft seal:	HQQV
Code for shaft seal:	HQQV
Approvals:	CE,EAC,UKCA,SEPRO
Approvals for drinking water:	WRAS,ACS
Curve tolerance:	ISO9906:2012 3B
Pump version:	A
Model:	A
<b>Materials:</b>	
Base:	Stainless steel EN 1.4408 AISI 316
Impeller:	Stainless steel EN 1.4301 AISI 304
Material code:	A
Code for rubber:	V
Bearing:	SIC
<b>Installation:</b>	
Maximum ambient temperature:	60 °C
Maximum operating pressure:	16 bar
Max pressure at stated temp:	16 bar / 90 °C 16 bar / -20 °C
Type of connection:	DIN / ANSI / JIS
Size of inlet connection:	DN 50 2 inch
Size of outlet connection:	DN 50 2 inch
Pressure rating for connection:	PN 25
Flange rating inlet:	300 lb
Flange size for motor:	FF265
Connect code:	FGJ
<b>Liquid:</b>	
Pumped liquid:	Water
Liquid temperature range:	-20 .. 90 °C
Selected liquid temperature:	20 °C
Density:	998.2 kg/m³
<b>Electrical data:</b>	
Motor standard:	IEC
Motor type:	132SC
Rated power - P2:	5.5 kW

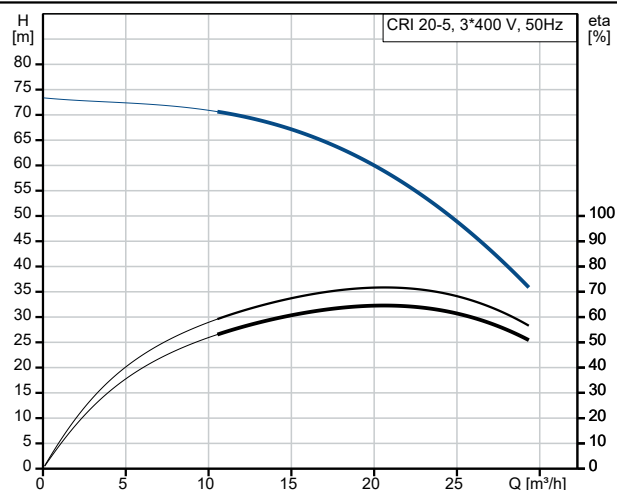

Pumped liquid = Water  
Liquid temperature during operation = 20 °C  
Density = 998.2 kg/m³

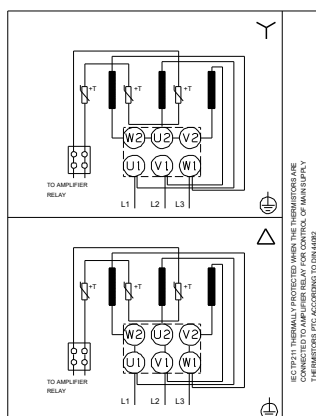
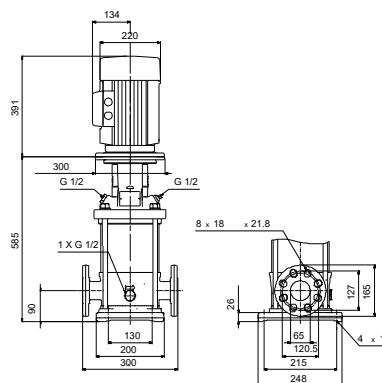
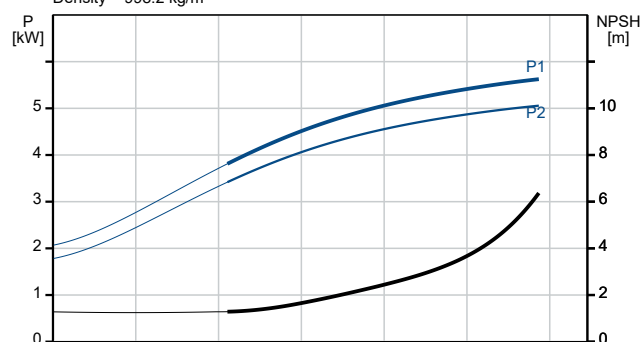



Company name:

Created by:

Phone:

Date:

01/10/2025

Description	Value
Power (P2) required by pump:	5.5 kW
Mains frequency:	50 Hz
Rated voltage:	3 x 380-415D V
Rated current:	11 A
Starting current:	1080-1180 %
Cos phi - power factor:	0.87-0.82
Rated speed:	2920-2940 rpm
IE Efficiency class:	IE3
Motor efficiency at full load:	89.2 %
Motor efficiency at 3/4 load:	90.0-89.8 %
Motor efficiency at 1/2 load:	89.6-88.4 %
Number of poles:	2
Enclosure class (IEC 34-5):	55 Dust/Jetting
Insulation class (IEC 85):	F
Built-in motor protection:	PTC
Motor No:	85U17417
<b>Controls:</b>	
Frequency converter:	None
<b>Others:</b>	
Terminal box position:	6
Minimum efficiency index, MEI ≥:	0.70
Net weight:	87 kg
Gross weight:	109 kg
Shipping volume:	0.285 m³

## 96500611 CRI 20-5 A-FGJ-A-V-HQQV 50 Hz

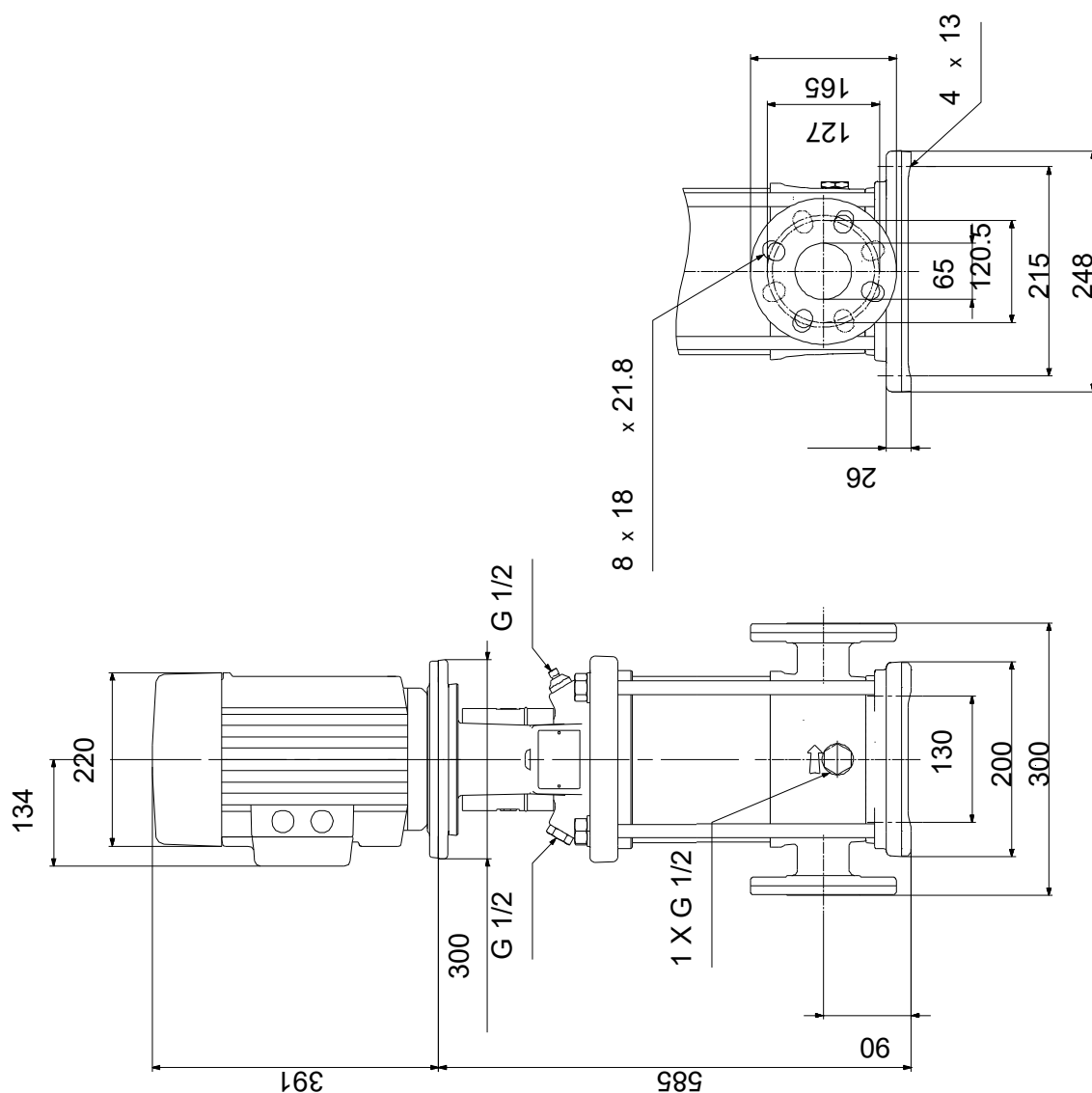

Note! All units are in [mm] unless others are stated.  
Disclaimer: This simplified dimensional drawing does not show all details.

## 96500611 CRI 20-5 A-FGJ-A-V-HQQV 50 Hz

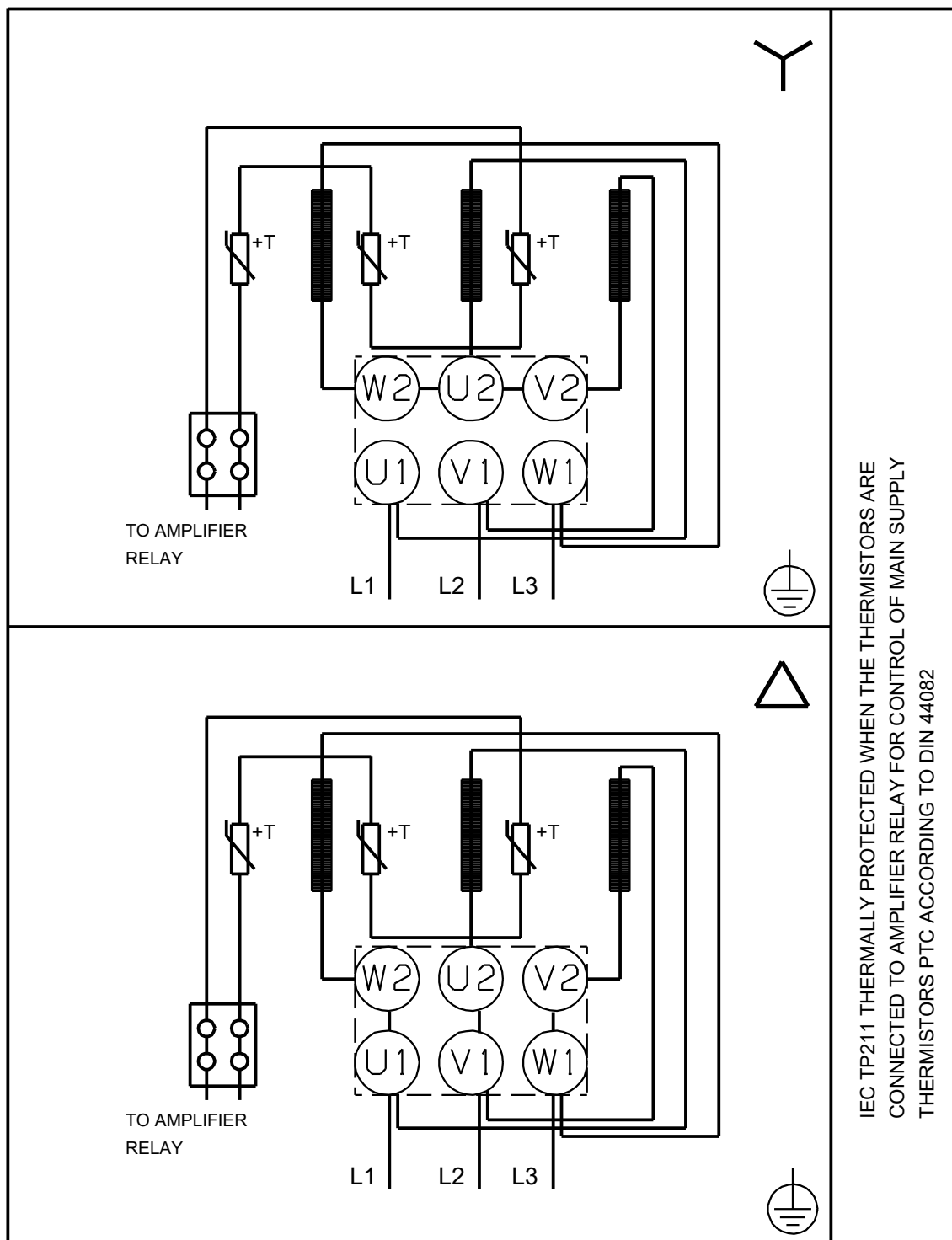

Note! All units are in [mm] unless others are stated.