

Qty. Description

1 ALPHA1 15-50 N 130



Note! Product picture may differ from actual product

Product No.: On request

Grundfos ALPHA1 pumps are high-efficiency circulators, designed for circulating liquids in heating systems. With an energy efficiency index (EEI) at the ErP benchmark for most efficient circulators it contributes to energy savings.

The ideal choice for basic functionality needs.

Features

- Intuitive one-button operation makes selection of any control mode simple
 No external motor protection required reducing installation time
 High-torque start improves startup under harsh conditions
 Maintenance free and noiseless due to canned-rotor design and use of robust components
 ALPHA plug makes electrical installation quick, safe and easy
 Insulating shells are supplied with pumps to minimize heat loss in heating systems

The pump also features three control modes - each with three settings

- proportional-pressure control
 constant-pressure control
 constant-curve mode

The display shows the actual power consumption in Watts. LEDs indicate the actual operating status.

The pump has a ceramic shaft and radial bearings, carbon thrust bearing, stainless-steel rotor can, bearing plate and rotor cladding, composite impeller, all of which contribute to long life.

The pump is self-venting through the system, which contributes to easy commissioning. The compact design featuring pump head with integrated control box and control panel fits into most common installations.

The pump housing is made of stainless steel for applications where the media requires this, e.g. avoiding corrosion when used in domestic hot-water systems.

The motor is a synchronous permanent-magnet/compact-stator motor characterized by high efficiency. The pump speed is controlled by an integrated frequency converter incorporated in the control box.

Liquid:

Pumped liquid: Water
 Liquid temperature range: 2 .. 110 °C
 Selected liquid temperature: 60 °C
 Density at selected liquid temperature: 983.2 kg/m³

Technical:

TF class: 110
 Approvals on nameplate: CE, VDE

Materials:

Qty.	Description
	<p>Pump housing: Stainless steel EN 1561 EN-GJL-150 ASTM A351 CF8</p> <p>Impeller: PES</p> <p>Installation: Range of ambient temperature: 0 .. 40 °C Maximum operating pressure: 10 bar Pipe connection: G 1 1/2 Pressure rating: PN 10 Port-to-port length: 130 mm</p> <p>Electrical data: Power input - P1: 3 .. 26 W Mains frequency: 50 Hz Rated voltage: 1 x 230 V Maximum current consumption: 0.04 .. 0.24 A Enclosure class (IEC 34-5): X4D Insulation class (IEC 85): F</p> <p>Others: Energy (EEI): 0.20 Net weight: 1.98 kg Gross weight: 2.15 kg Shipping volume: 0.004 m³ Country of origin: DK Custom tariff no.: 84137030</p>

On request ALPHA1 15-50 N 130 50 Hz

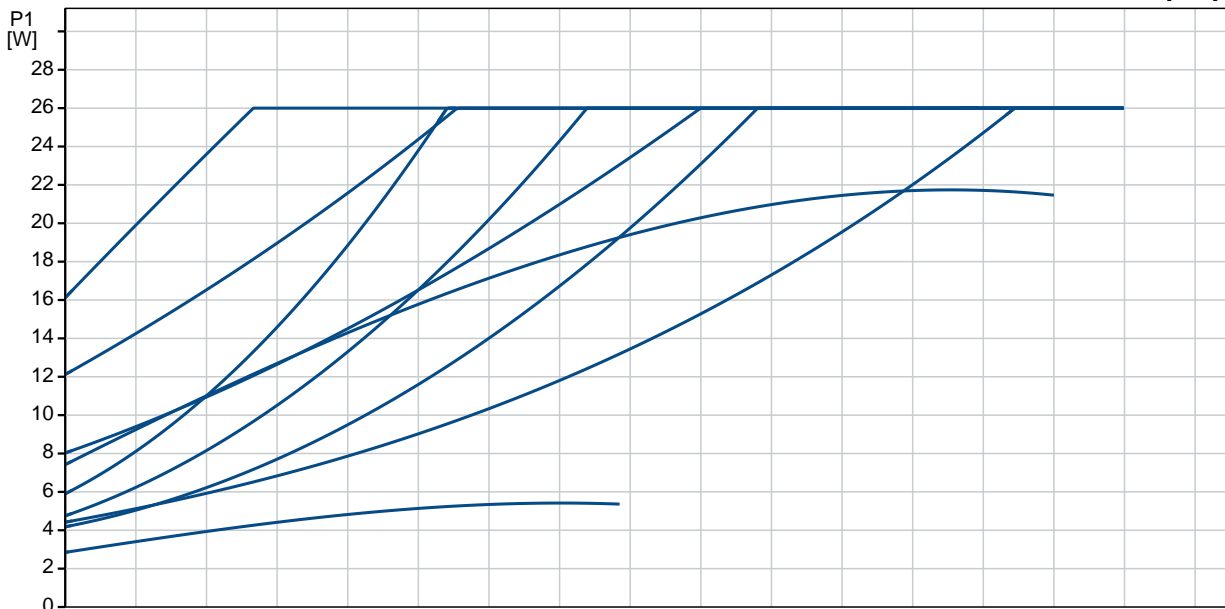
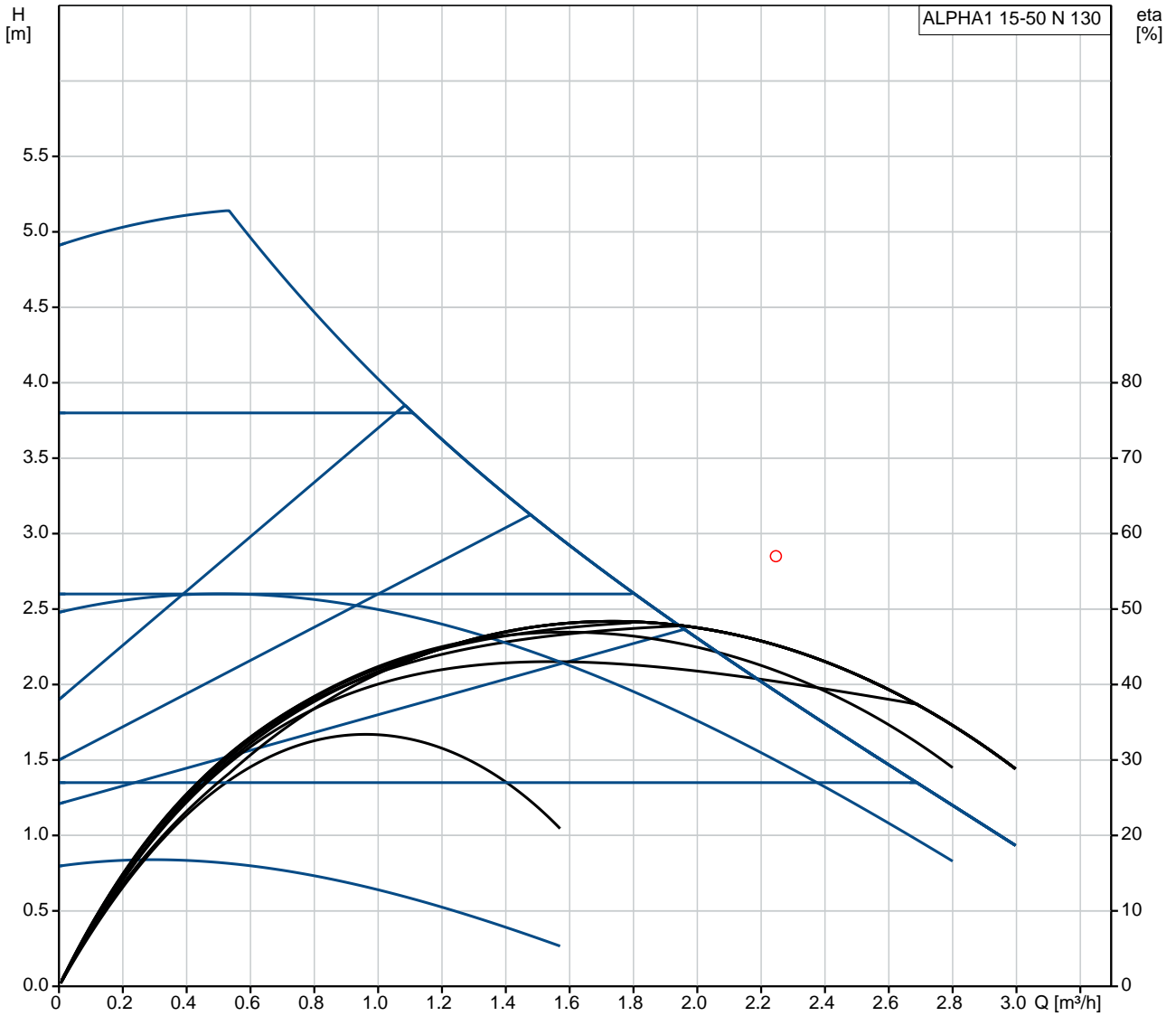

Description	Value
General information:	
Product name:	ALPHA1 15-50 N 130
Product No:	On request
EAN number:	On request
	On request
Technical:	
Head max:	50 dm
TF class:	110
Approvals on nameplate:	CE, VDE
Model:	B
Materials:	
Pump housing:	Stainless steel
	EN 1561 EN-GJL-150
	ASTM A351 CF8
Impeller:	PES
Installation:	
Range of ambient temperature:	0 .. 40 °C
Maximum operating pressure:	10 bar
Pipe connection:	G 1 1/2
Pressure rating:	PN 10
Port-to-port length:	130 mm
Liquid:	
Pumped liquid:	Water
Liquid temperature range:	2 .. 110 °C
Selected liquid temperature:	60 °C
Density at selected liquid temperature:	983.2 kg/m ³
Electrical data:	
Power input - P1:	3 .. 26 W
Mains frequency:	50 Hz
Rated voltage:	1 x 230 V
Maximum current consumption:	0.04 .. 0.24 A
Enclosure class (IEC 34-5):	X4D
Insulation class (IEC 85):	F
Motor protec:	NONE
Thermal protec:	ELEC
Controls:	
Aut. night:	N
Pos term box:	6H
Others:	
Energy (EEI):	0.20
Net weight:	1.98 kg
Gross weight:	2.15 kg
Shipping volume:	0.004 m ³
Sales region:	GB
Country of origin:	DK
Custom tariff no.:	84137030

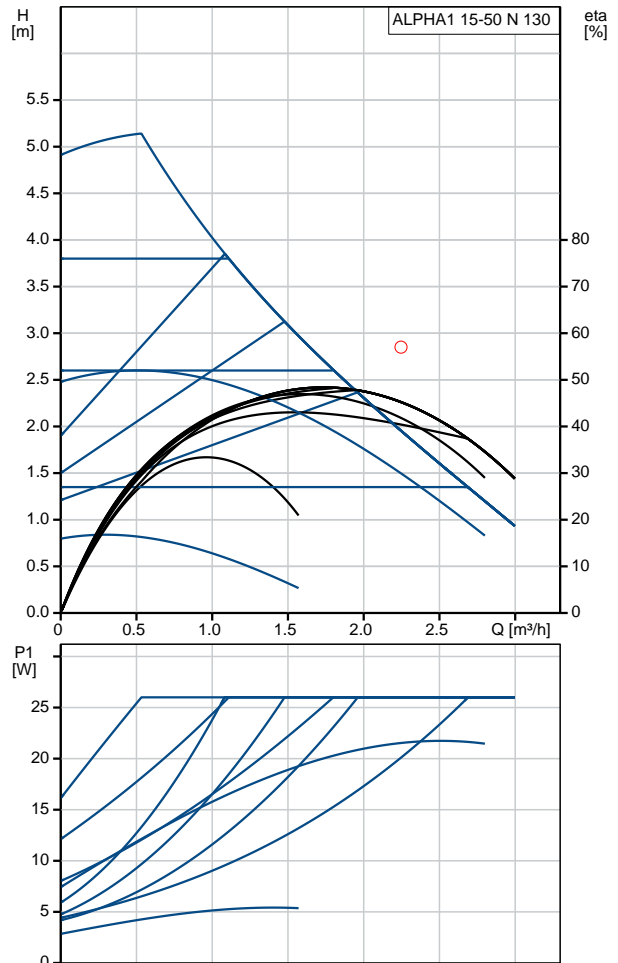

On request ALPHA1 15-50 N 130 50 Hz

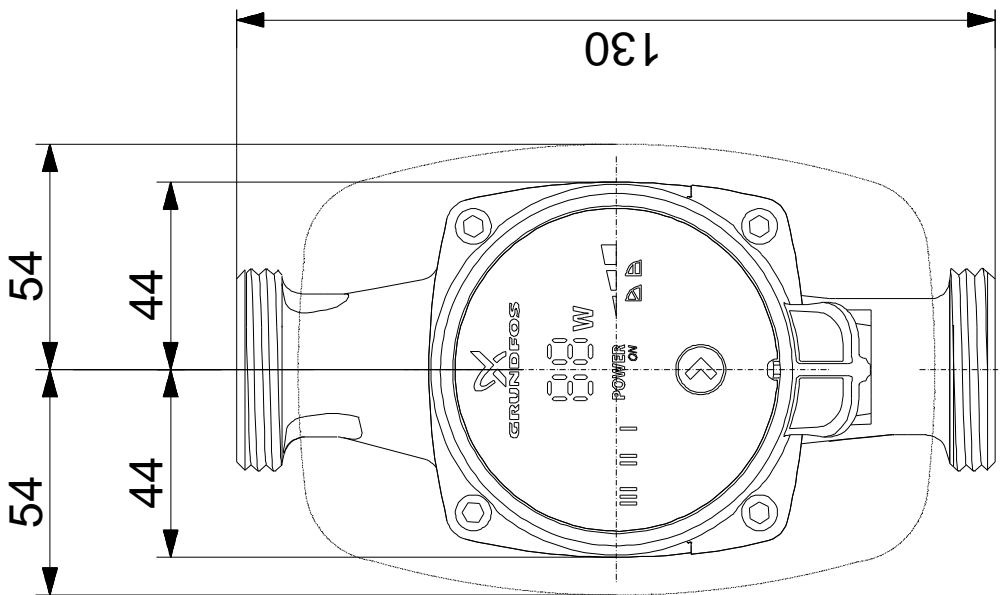
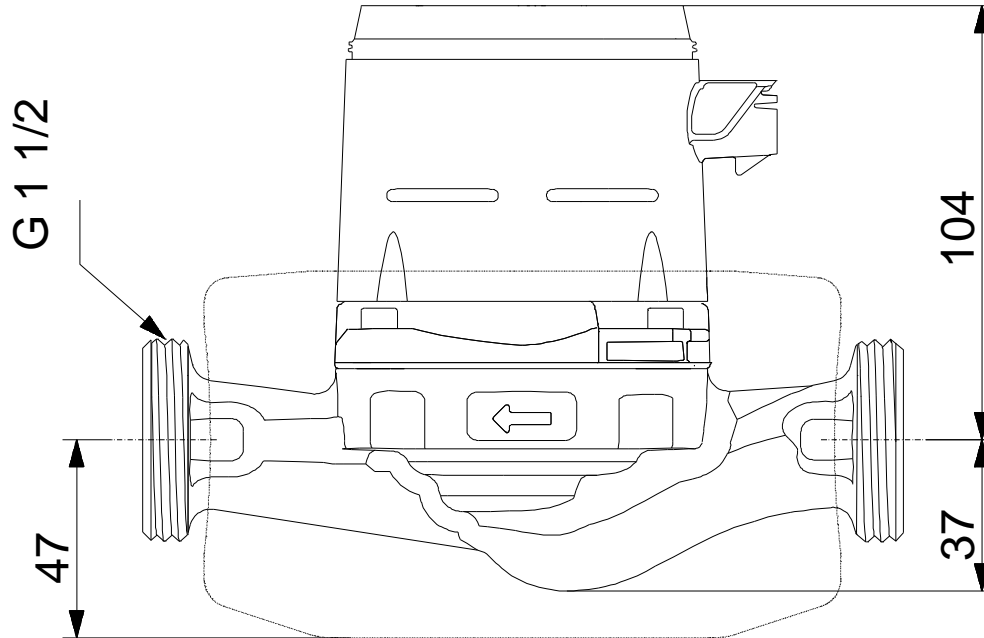

Note! All units are in [mm] unless others are stated.
Disclaimer: This simplified dimensional drawing does not show all details.

On request ALPHA1 15-50 N 130 50 Hz

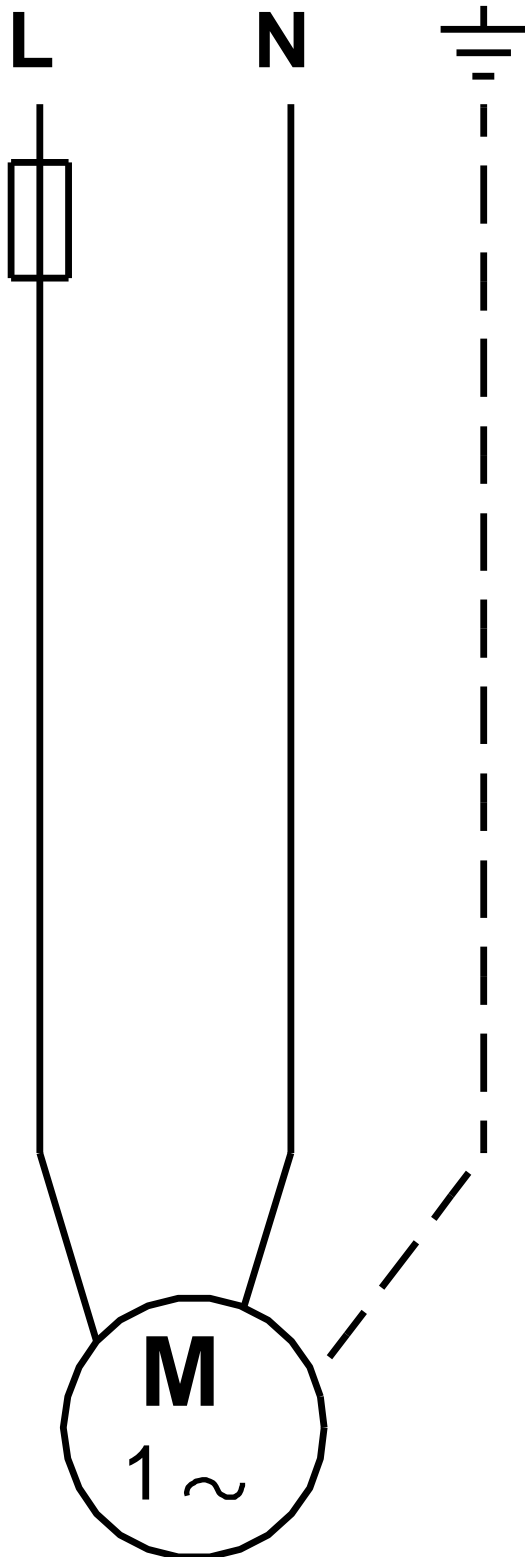

Note! All units are in [mm] unless others are stated.