

| Position | Qty. | Description | | | | | | | | | | |
|---------------------------|-------------------------|---|----------------|-------|---------------------------|------------|--------------|-------|----------|-------------------------|----------------------|----------|
| | 1 | <p data-bbox="320 338 542 367">CMBE 10-54 AVBE</p> <div data-bbox="343 432 662 835" style="text-align: center;">  </div> <p data-bbox="710 875 1193 902" style="text-align: center;">Note! Product picture may differ from actual product</p> <p data-bbox="320 907 587 936">Product No.: 98382190</p> <p data-bbox="320 965 981 1261">The Grundfos CME Booster is a compact booster system for water supply in domestic applications. The integrated speed controller enables the CME Booster to keep constant pressure in the pipe system. A pressure sensor monitoring changes in the water consumption will signal to the speed controller to change the motor speed to adapt performance to the new state. The CME Booster is very easy to install. When the pipework has been installed, it is all a matter of plugging the unit into a socket, and the system is operational.</p> <p data-bbox="320 1265 651 1294">The CME Booster consists of:</p> <ul data-bbox="320 1299 858 1413" style="list-style-type: none"> • CME pump with integrated frequency converter • 5-way valve • expansion tank • pressure gauge <p data-bbox="320 1442 422 1471">Features</p> <ul data-bbox="320 1476 821 1621" style="list-style-type: none"> • Constant pressure, integrated speed control • compact • robust, stainless steel • easy installation • dry run protection <p data-bbox="320 1650 528 1680">Thermal protection</p> <p data-bbox="320 1684 957 1798">CME Booster pumps require no external motor protection. The MGE motor incorporates thermal protection against slow overloading and blocking (IEC 34.11: TP 211).</p> <p data-bbox="320 1856 406 1886">Liquid:</p> <table data-bbox="320 1890 821 2004"> <tr> <td>Pumped liquid:</td> <td>Water</td> </tr> <tr> <td>Liquid temperature range:</td> <td>0 .. 60 °C</td> </tr> <tr> <td>Liquid temp:</td> <td>20 °C</td> </tr> <tr> <td>Density:</td> <td>998.2 kg/m³</td> </tr> </table> <p data-bbox="320 2033 446 2063">Technical:</p> <table data-bbox="320 2067 790 2096"> <tr> <td>Speed for pump data:</td> <td>3868 rpm</td> </tr> </table> | Pumped liquid: | Water | Liquid temperature range: | 0 .. 60 °C | Liquid temp: | 20 °C | Density: | 998.2 kg/m ³ | Speed for pump data: | 3868 rpm |
| Pumped liquid: | Water | | | | | | | | | | | |
| Liquid temperature range: | 0 .. 60 °C | | | | | | | | | | | |
| Liquid temp: | 20 °C | | | | | | | | | | | |
| Density: | 998.2 kg/m ³ | | | | | | | | | | | |
| Speed for pump data: | 3868 rpm | | | | | | | | | | | |

98382190 CMBE 10-54 50 Hz

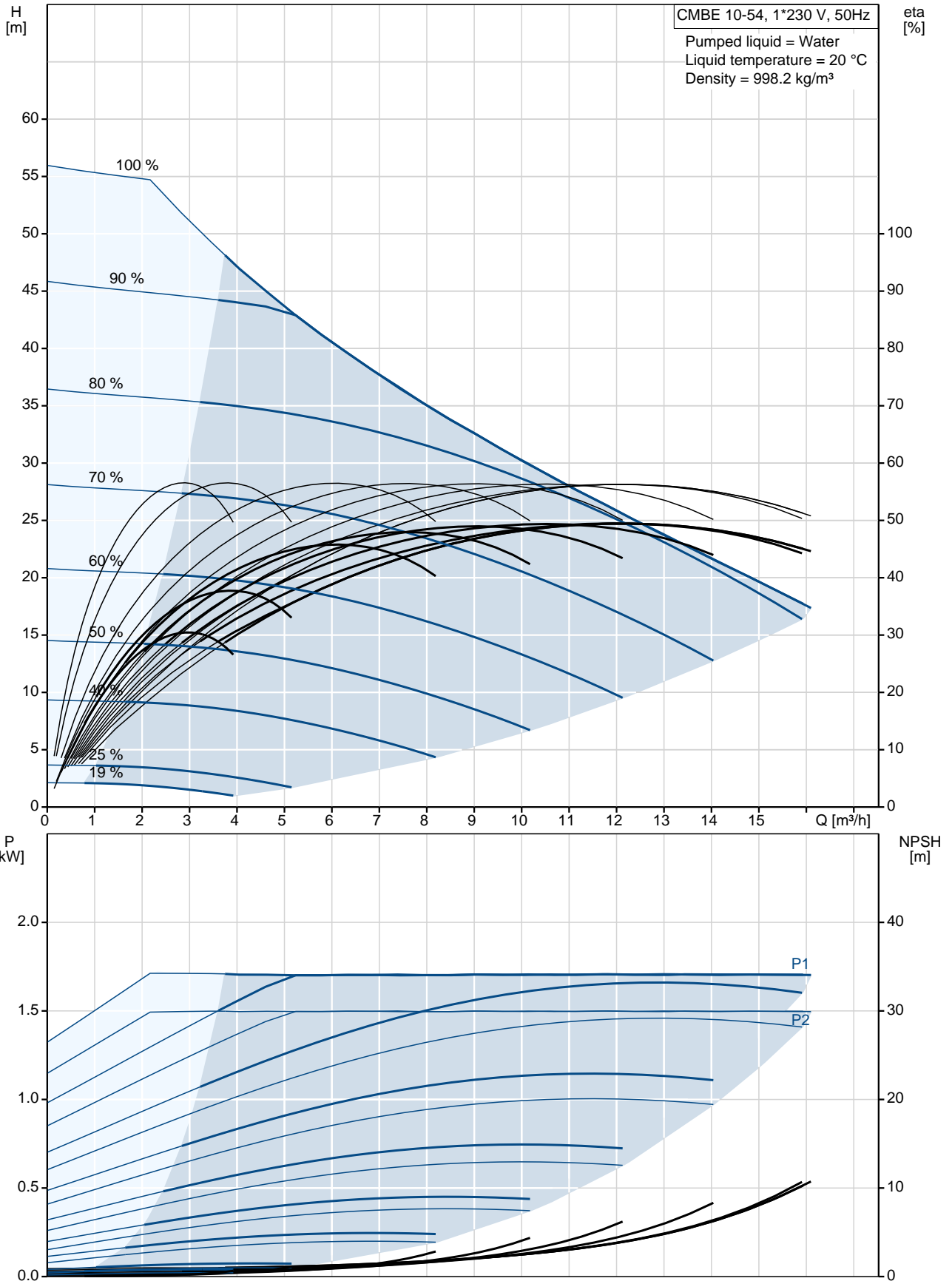

| Description | Value |
|-------------|-------|
|-------------|-------|

General information:

| | |
|---------------|-----------------|
| Product name: | CMBE 10-54 AVBE |
| Product No: | 98382190 |
| EAN number: | 5711494037926 |
| Price: | On request |

Technical:

| | |
|-------------------------|--------------------------------|
| Speed for pump data: | 3868 rpm |
| Rated flow: | 12 m ³ /h |
| Rated head: | 35.4 m |
| Impellers: | 2 |
| Primary shaft seal: | AVBE |
| Approvals and markings: | CE |
| Curve tolerance: | ISO9906:2012 3B |
| Model: | A |
| Start pressure: | Integrated Frequency converter |

Materials:

| | |
|---------------|--|
| Pump housing: | Stainless steel 304 |
| Impeller: | Stainless steel DIN W.-Nr. 1.4301 AISI 304 |
| Rubber: | EPDM |

Installation:

| | |
|------------------------------|----------|
| Maximum ambient temperature: | 55 °C |
| Pump inlet: | Rp 1 1/2 |
| Pump outlet: | Rp 1 1/2 |

Liquid:

| | |
|---------------------------|-------------------------|
| Pumped liquid: | Water |
| Liquid temperature range: | 0 .. 60 °C |
| Liquid temp: | 20 °C |
| Density: | 998.2 kg/m ³ |

Electrical data:

| | |
|------------------------------|---------------|
| Rated power - P2: | 1.5 kW |
| Mains frequency: | 50 Hz |
| Rated voltage: | 1 x 200-240 V |
| Maximum current consumption: | 9,10-7,60 A |
| p max system: | 10 bar |
| Rated speed: | 360-4000 rpm |
| Enclosure class (IEC 34-5): | IP55 |
| Insulation class (IEC 85): | F |
| Type of cable plug: | NONE |
| Mains cable: | 1.5 m |

Tank:

| | |
|--------------|-----|
| Tank volume: | 2 l |
|--------------|-----|

Others:

| | |
|------------------|----------|
| Net weight: | 31.6 kg |
| Gross weight: | 35.1 kg |
| Config. file no: | 98442578 |

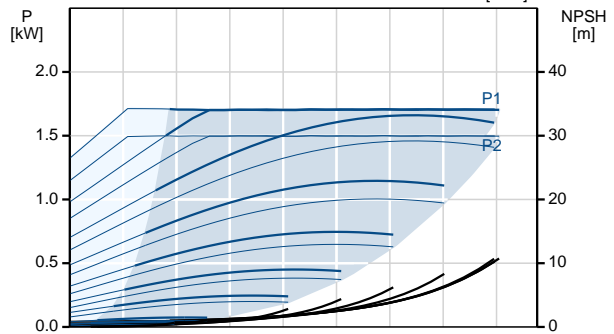
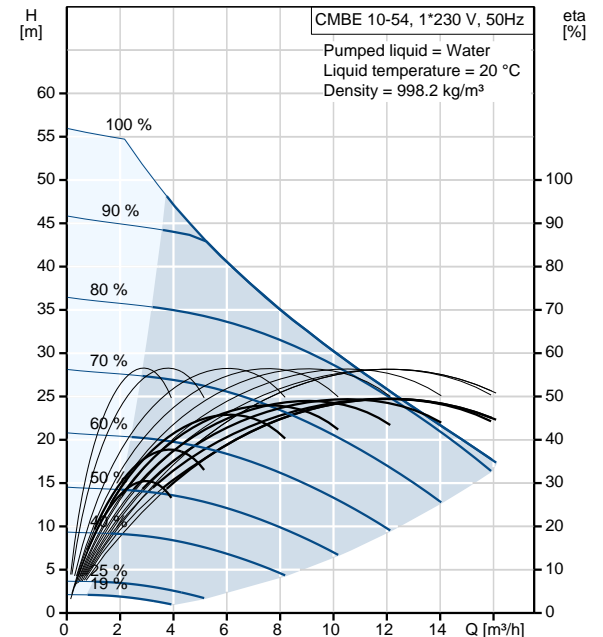

98382190 CMBE 10-54 50 Hz

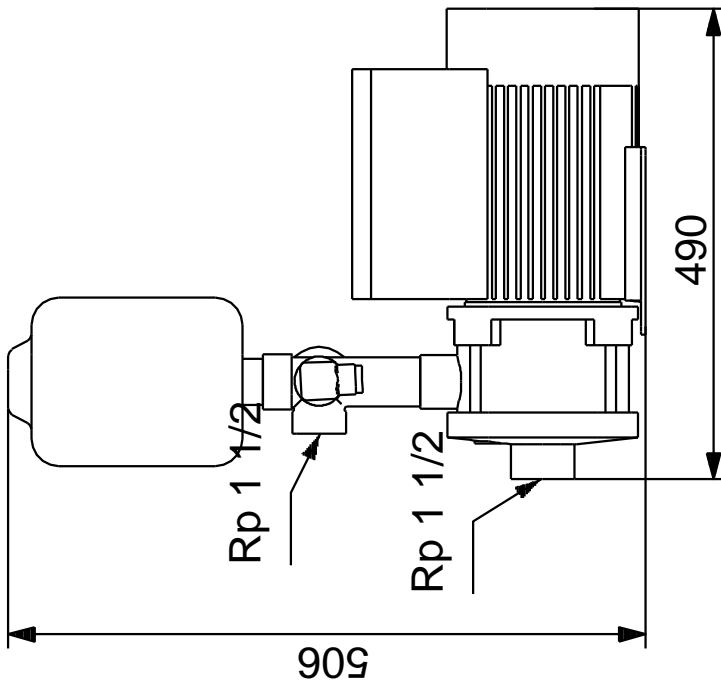
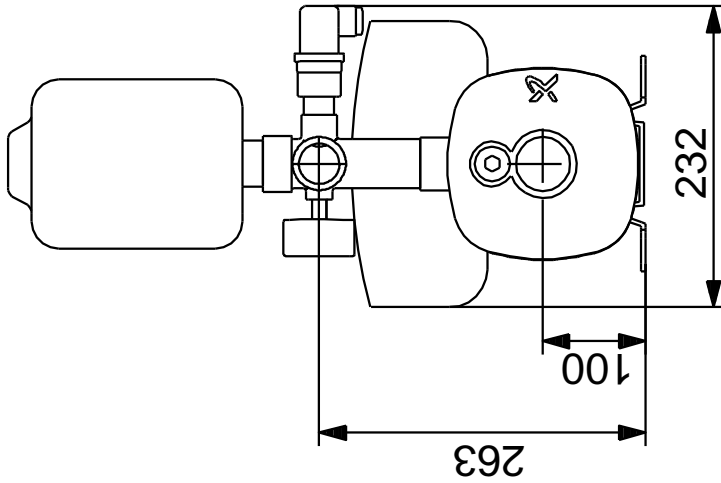

Note! All units are in [mm] unless others are stated.
Disclaimer: This simplified dimensional drawing does not show all details.

98382190 CMBE 10-54 50 Hz

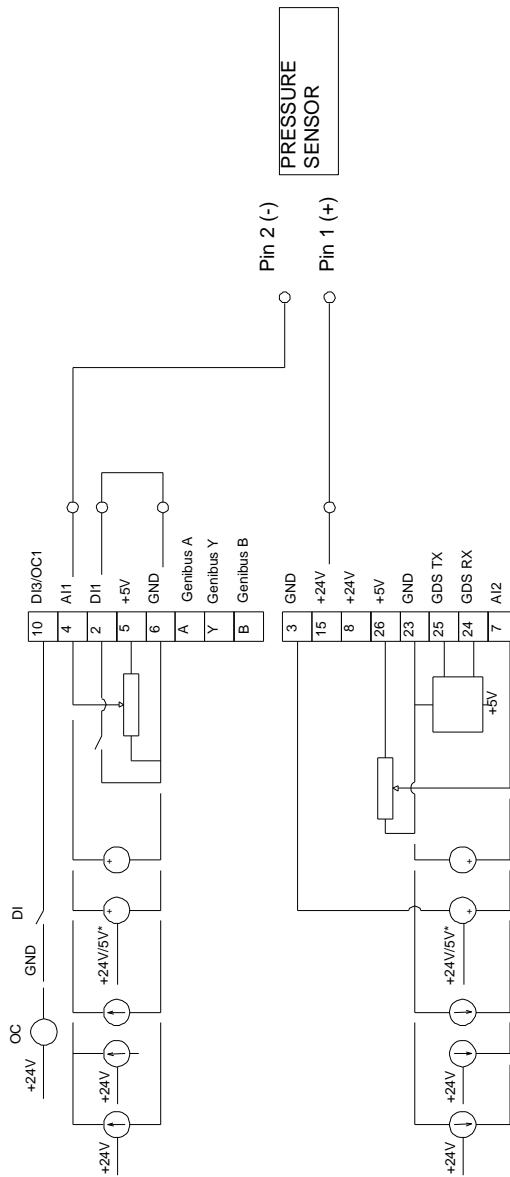
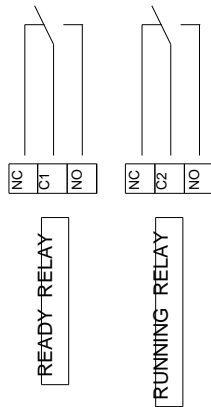
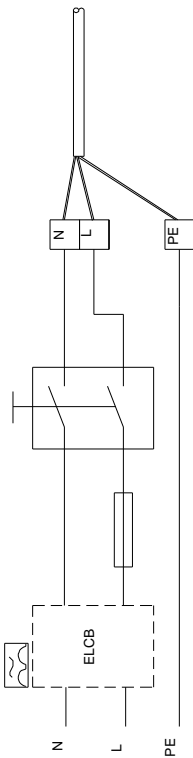
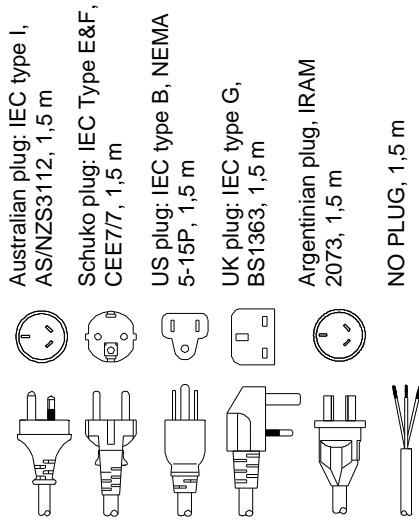

Note! All units are in [mm] unless others are stated.