

Position	Qty.	Description
	1	<p>TP 25-50/2 A-O-A-BQQE</p>  <p>Product No.: 98346587</p> <p>Single-stage, close-coupled, volute pump with in-line suction and discharge ports of identical diameter. The pump is of the top-pull-out design, i.e. the power head (motor, pump head and impeller) can be removed for maintenance or service while the pump housing remains in the pipework.</p> <p>The pump is fitted with an unbalanced rubber bellows seal. The shaft seal is according to EN 12756. Pipework connection is via PN 10 union connections (ISO 228-1).</p> <p>The pump is fitted with a fan-cooled asynchronous motor.</p> <p>Liquid: Pumped liquid: Water Liquid temperature range: -25 .. 120 °C Liquid temperature during operation: 20 °C Density: 998.2 kg/m³</p> <p>Technical: Speed for pump data: 2800 rpm Rated flow: 3.72 m³/h Rated head: 2.7 m Actual impeller diameter: 68 mm Primary shaft seal: BQQE Curve tolerance: ISO9906:2012 3B</p> <p>Materials: Pump housing: Cast iron EN-JL1020 ASTM A48-25B Impeller: Composite PES/PP 30% GF</p> <p>Installation: Range of ambient temperature: -30 .. 40 °C Maximum operating pressure: 10 bar Flange standard: UNION Pipe connection: G 1 1/2 Pressure rating: PN 10 Port-to-port length: 180 mm Flange size for motor: FT75</p> <p>Electrical data: Motor type: 71A IE Efficiency class: NA Rated power - P2: 0.12 kW Power (P2) required by pump: 0.12 kW Mains frequency: 50 Hz Rated voltage: 1 x 220-240 V Rated current: 1,36-1,57 A Starting current: 400-370 % Cos phi - power factor: 0,77</p>



Company name:

Created by:

Phone:

Date:

03/11/2017

Position	Qty.	Description
		Rated speed: 2815-2835 rpm Motor efficiency at full load: 52.3-53.2 % Number of poles: 2 Enclosure class (IEC 34-5): 55 Dust/Jetting Insulation class (IEC 85): F Others: Minimum efficiency index, MEI : --.- ErP status: EuP Standalone/Prod. Net weight: 9.4 kg Gross weight: 11.4 kg Shipping volume: 0.02 m ³ Danish: VVS NO 38 1800.050

98346587 TP 25-50/2 50 Hz

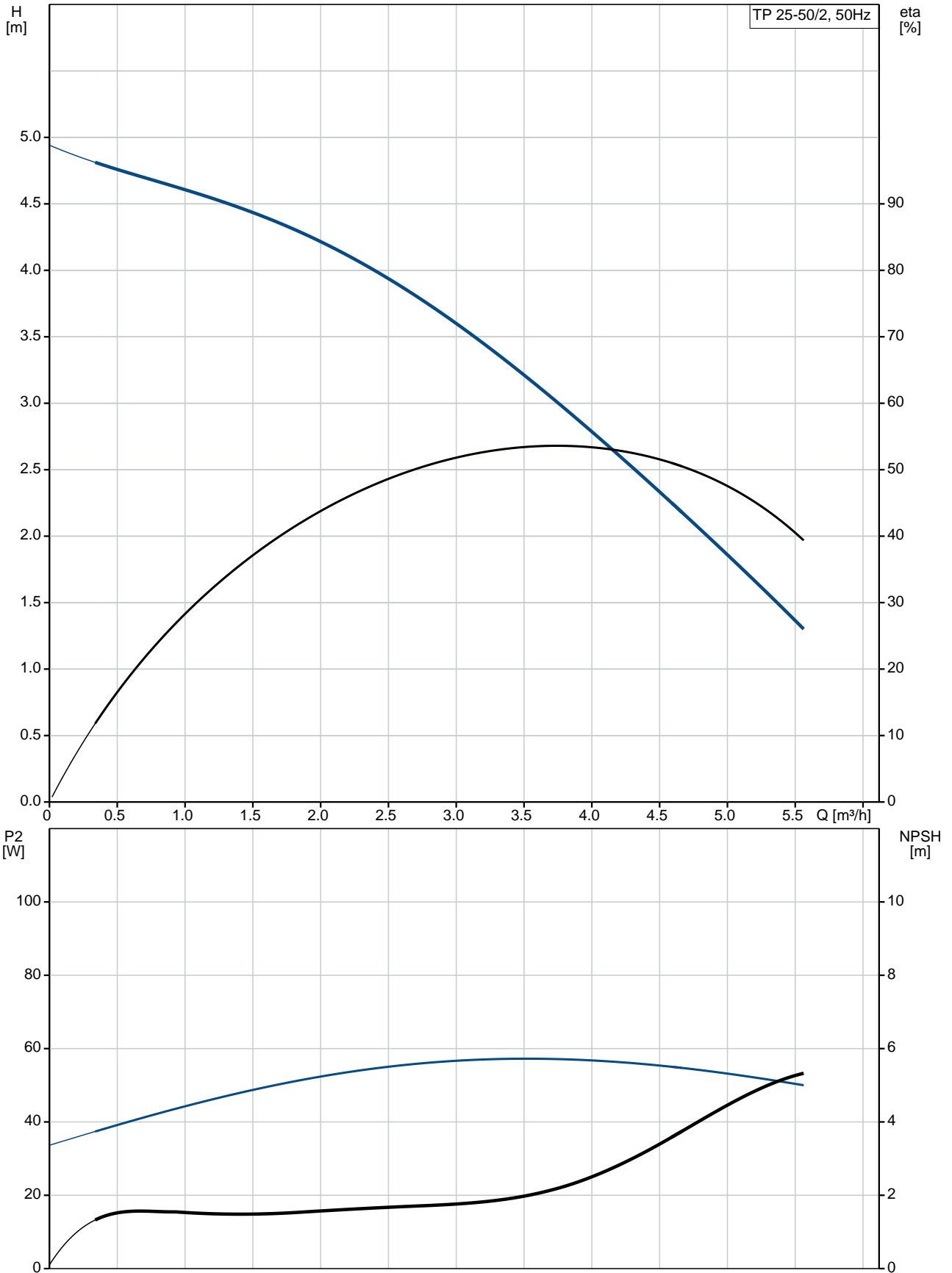

Description	Value
General information:	
Product name:	TP 25-50/2 A-O-A-BQQE
Product No:	98346587
EAN number:	5711493379881
Technical:	
Speed for pump data:	2800 rpm
Rated flow:	3.72 m ³ /h
Rated head:	2.7 m
Head max:	50 dm
Actual impeller diameter:	68 mm
Primary shaft seal:	BQQE
Curve tolerance:	ISO9906:2012 3B
Pump version:	A
Model:	B
Materials:	
Pump housing:	Cast iron EN-JL1020 ASTM A48-25B
Impeller:	Composite PES/PP 30% GF
Material code:	A
Installation:	
Range of ambient temperature:	-30 .. 40 °C
Maximum operating pressure:	10 bar
Flange standard:	UNION
Connect code:	O
Pipe connection:	G 1 1/2
Pressure rating:	PN 10
Port-to-port length:	180 mm
Flange size for motor:	FT75
Liquid:	
Pumped liquid:	Water
Liquid temperature range:	-25 .. 120 °C
Liquid temperature during operation:	20 °C
Density:	998.2 kg/m ³
Electrical data:	
Motor type:	71A
IE Efficiency class:	NA
Rated power - P2:	0.12 kW
Power (P2) required by pump:	0.12 kW
Mains frequency:	50 Hz
Rated voltage:	1 x 220-240 V
Rated current:	1,36-1,57 A
Starting current:	400-370 %
Cos phi - power factor:	0,77
Rated speed:	2815-2835 rpm
Motor efficiency at full load:	52.3-53.2 %
Number of poles:	2
Enclosure class (IEC 34-5):	55 Dust/Jetting
Insulation class (IEC 85):	F
Motor protec:	PTO
Motor No:	98714251
Others:	
Minimum efficiency index, MEI :	--.-

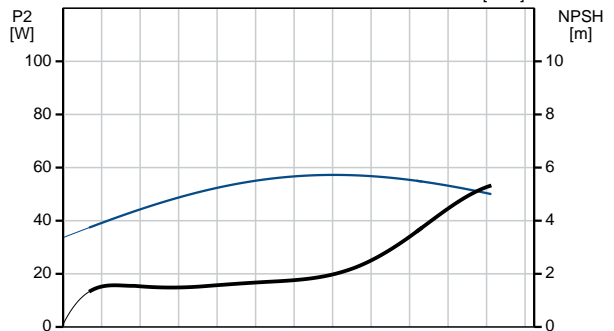
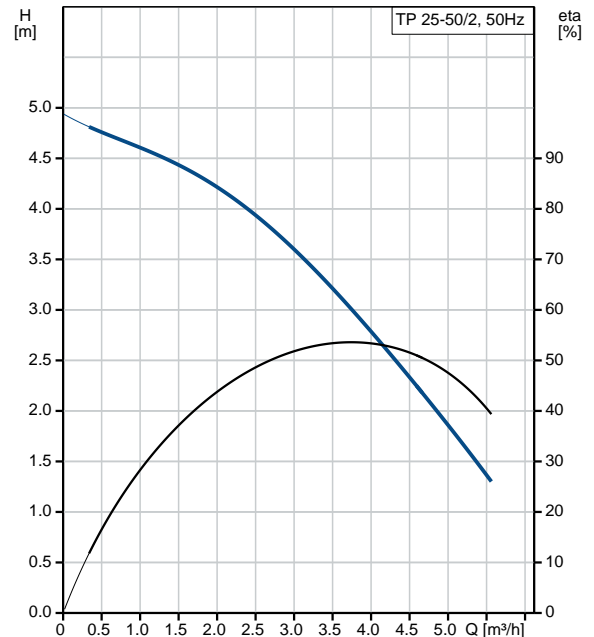



Company name:

Created by:

Phone:

Date: 03/11/2017

Description	Value
ErP status:	EuP Standalone/Prod.
Net weight:	9.4 kg
Gross weight:	11.4 kg
Shipping volume:	0.02 m ³
Danish:	VVS NO 38 1800.050

98346587 TP 25-50/2 50 Hz

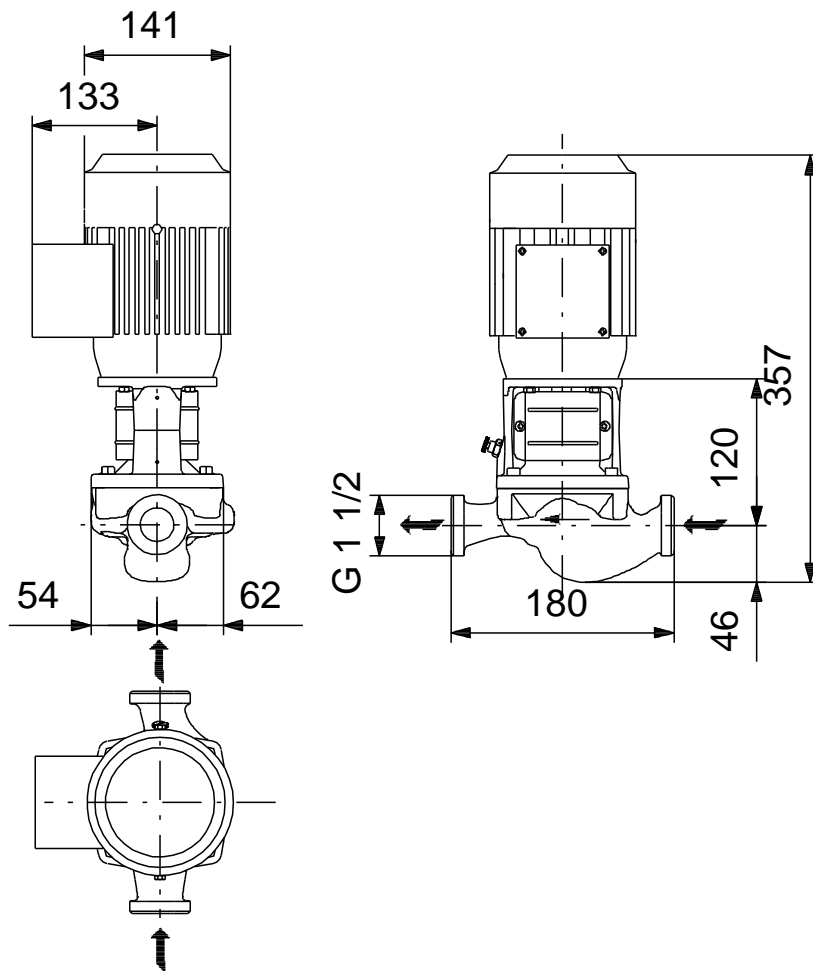

Note! All units are in [mm] unless others are stated.
Disclaimer: This simplified dimensional drawing does not show all details.

98346587 TP 25-50/2 50 Hz

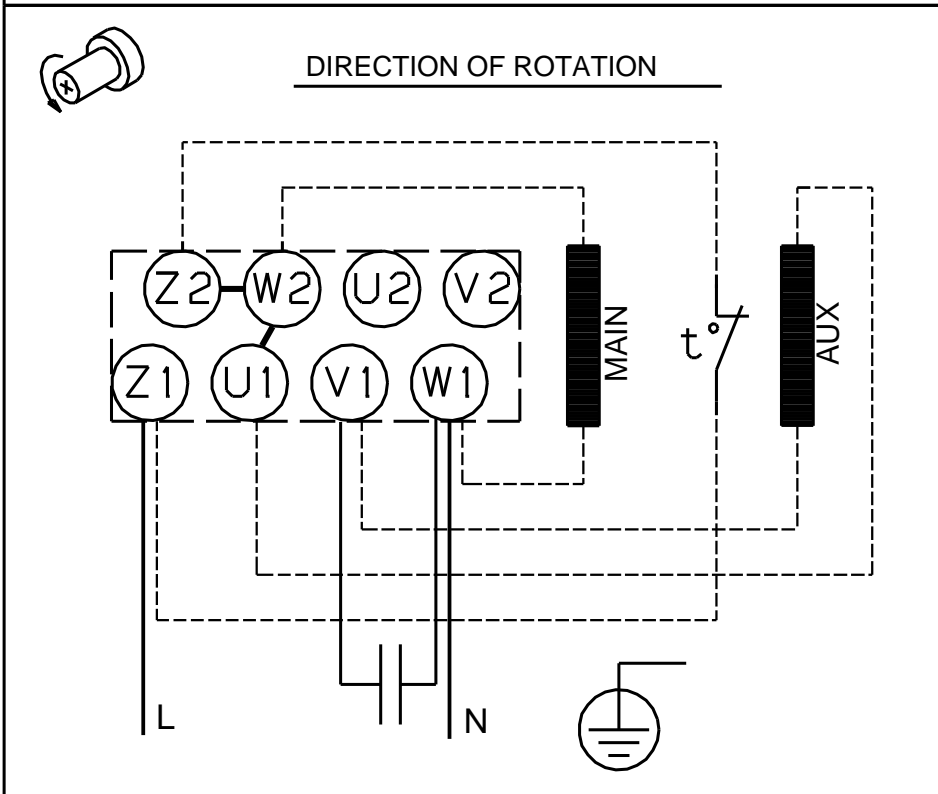
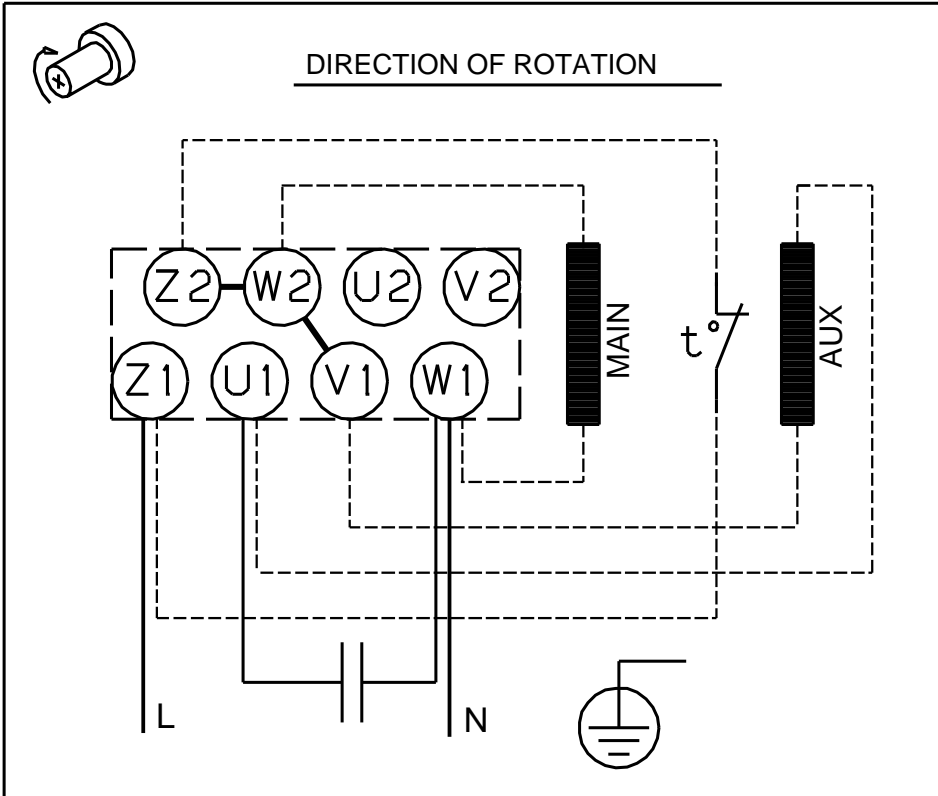

Note! All units are in [mm] unless others are stated.