

Qty. Description

1 **SP 360-6F G**



Note! Product picture may differ from actual product

Product No.: [96431022](#)

Multi-stage submersible pump for raw water supply, groundwater lowering, pressure boosting and various industrial jobs.

The pump is suitable for pumping clean, thin, non-aggressive liquids without solid particles or fibres.

Pump: The pump is made entirely of Cast iron DIN W.-Nr. EN-JL1040 and suitable for horizontal installation.

The pump is fitted with a built-in non-return valve.

Phase: The motor is a 3-phase motor with sand shield, liquid-lubricated bearings and pressure equalizing diaphragm.

Performance test according to ISO9906 2012 Grade 3B is available on request.

Liquid:

Pumped liquid: Water
 Maximum liquid temperature: 40 °C
 Max liquid t at 0.15 m/sec: 30 °C
 Selected liquid temperature: 20 °C
 Density: 998.2 kg/m³

Technical:

Type of impeller: F
 Shaft seal for motor: CER/CARBON
 Curve tolerance: ISO9906:2012 3B
 Motor version: T35

Materials:

Pump: Cast iron
 EN-JL1040
Impeller: Zinc-free bronze
 DIN W.-Nr. 2.1050.01
Motor: Cast iron
 DIN W.-Nr. 0.6025
 ASTM 35-40

Installation:

Flange standard: DIN
 Pump outlet: DN175
 Motor diameter: 12 inch

Electrical data:

Motor type: MMS12000
 Rated power - P2: 250 kW
 Mains frequency: 50 Hz



Company name:

Created by:

Phone:

Date:

12/11/2020

| Qty. | Description |
|------|---|
| | <p>Rated voltage: 3 x 380-400-415 V Rated current: 515-505-510 A Cos phi - power factor: 0.89-0.85-0.81 Rated speed: 2920-2920-2930 rpm Start. method: direct-on-line Enclosure class (IEC 34-5): IP68 Built-in temp. transmitter: no Motor No: 96430686 Windings: PE2/PA</p> <p>Others: Net weight: 1060 kg Shipping volume: 0.967 m³</p> |

96431022 SP 360-6F G 50 Hz

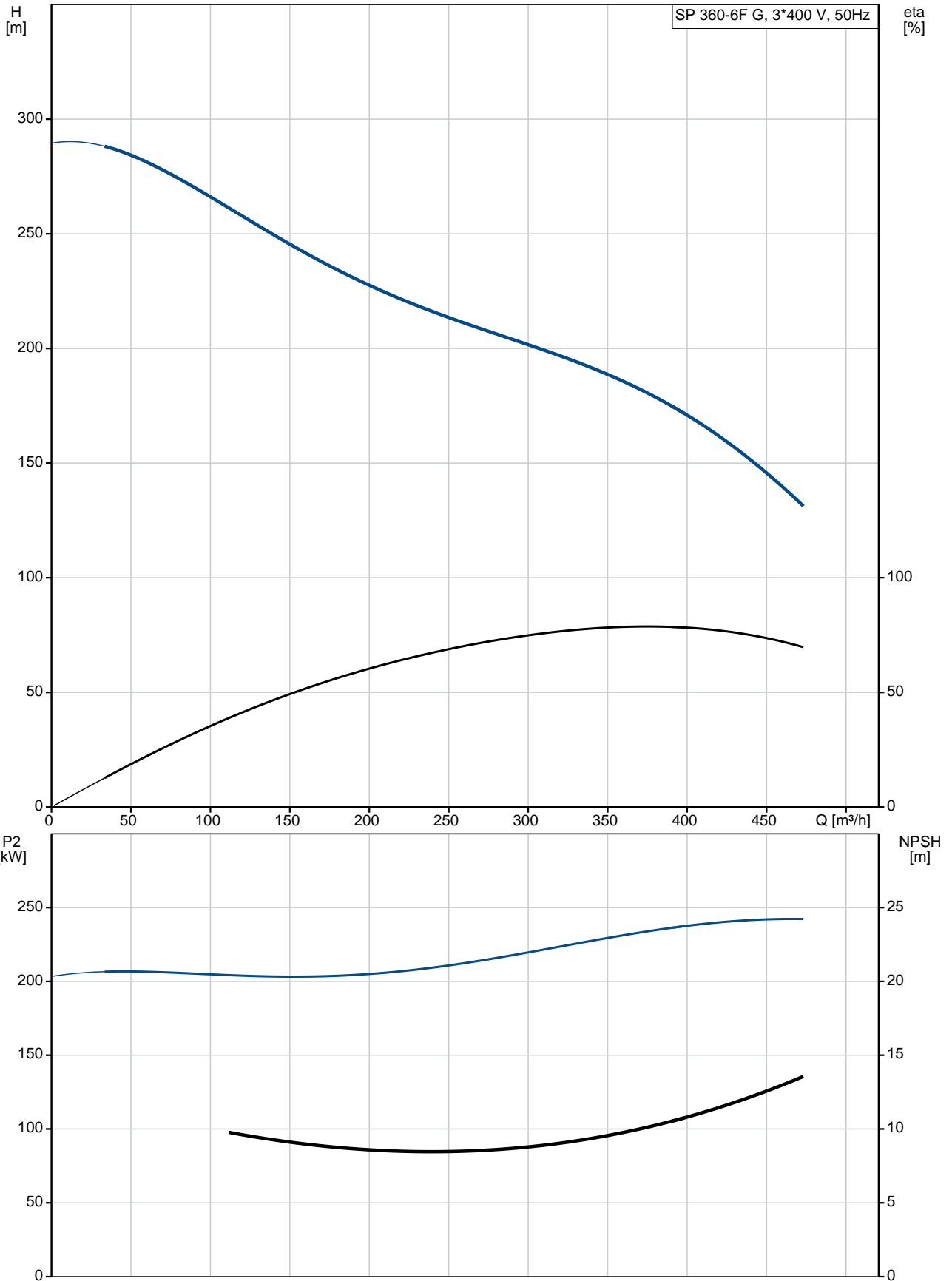

| Description | Value |
|------------------------------|-------------------------------------|
| General information: | |
| Product name: | SP 360-6F G |
| Product No: | 96431022 |
| EAN number: | 5700393033573 |
| Technical: | |
| Stages: | 6 |
| Type of impeller: | F |
| Shaft seal for motor: | CER/CARBON |
| Curve tolerance: | ISO9906:2012 3B |
| Pump No: | 96430924 |
| Valve: | pump with built-in non-return valve |
| Motor version: | T35 |
| Materials: | |
| Pump: | Cast iron |
| Pump: | EN-JL1040 |
| Impeller: | Zinc-free bronze |
| Impeller: | DIN W.-Nr. 2.1050.01 |
| Motor: | Cast iron |
| Motor: | DIN W.-Nr. 0.6025 |
| Motor: | ASTM 35-40 |
| Installation: | |
| Flange standard: | DIN |
| Pump outlet: | DN175 |
| Motor diameter: | 12 inch |
| Liquid: | |
| Pumped liquid: | Water |
| Maximum liquid temperature: | 40 °C |
| Max liquid t at 0.15 m/sec: | 30 °C |
| Selected liquid temperature: | 20 °C |
| Density: | 998.2 kg/m ³ |
| Electrical data: | |
| Motor type: | MMS12000 |
| Applic. motor: | GRUNDFOS |
| Rated power - P2: | 250 kW |
| Mains frequency: | 50 Hz |
| Rated voltage: | 3 x 380-400-415 V |
| Rated current: | 515-505-510 A |
| Cos phi - power factor: | 0.89-0.85-0.81 |
| Rated speed: | 2920-2920-2930 rpm |
| Start. method: | direct-on-line |
| Enclosure class (IEC 34-5): | IP68 |
| Motor protec: | NONE |
| Thermal protec: | external |
| Built-in temp. transmitter: | no |
| Motor No: | 96430686 |
| Windings: | PE2/PA |
| Others: | |
| Net weight: | 1060 kg |
| Shipping volume: | 0.967 m ³ |

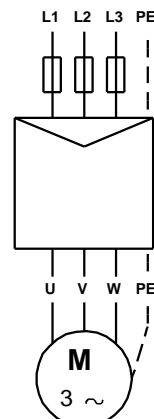
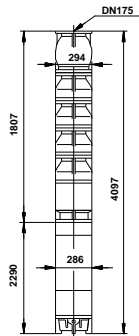
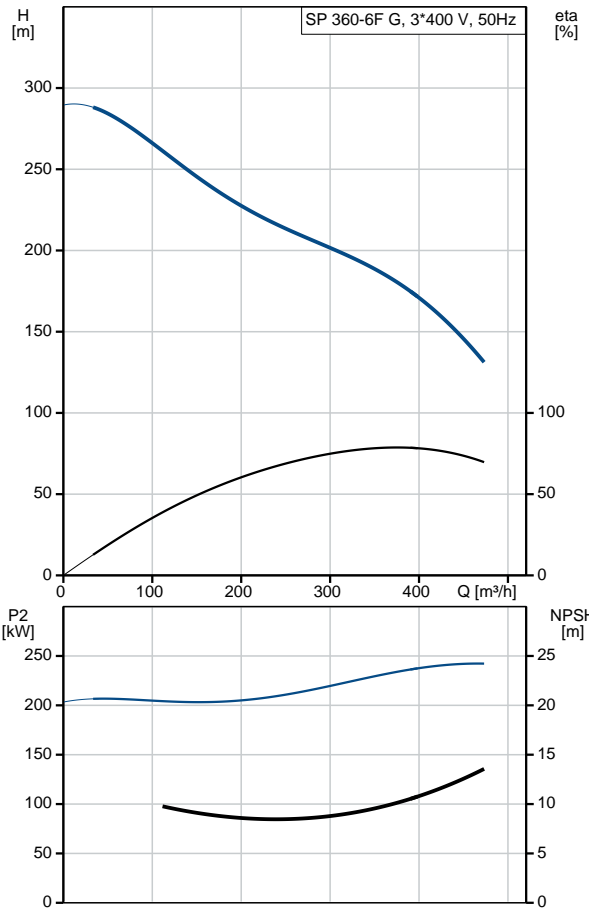

96431022 SP 360-6F G 50 Hz

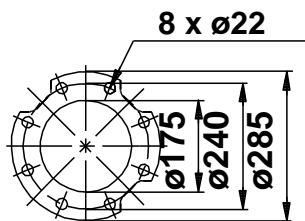
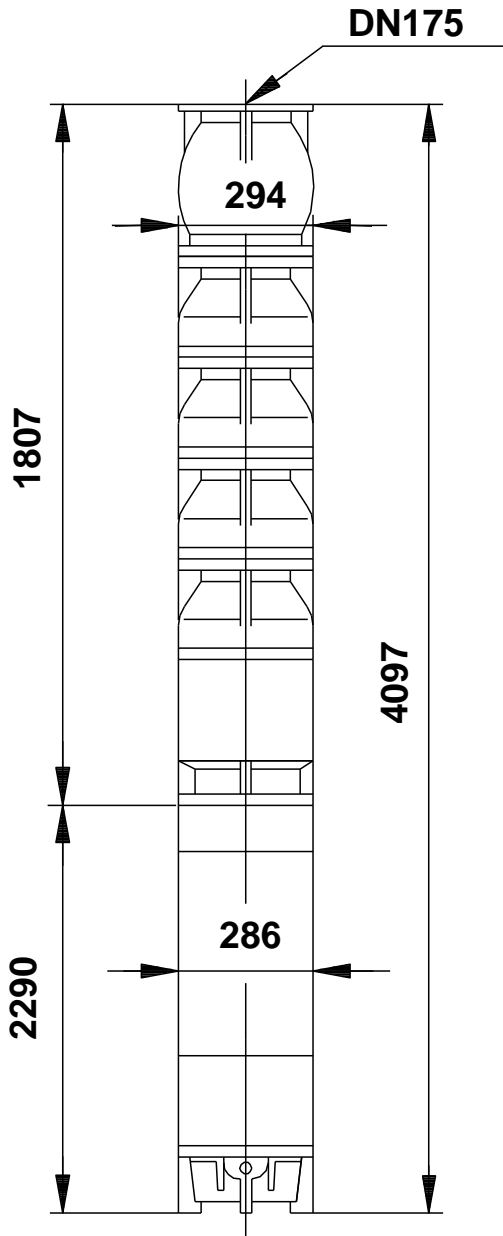

Note! All units are in [mm] unless others are stated.
Disclaimer: This simplified dimensional drawing does not show all details.

96431022 SP 360-6F G 50 Hz

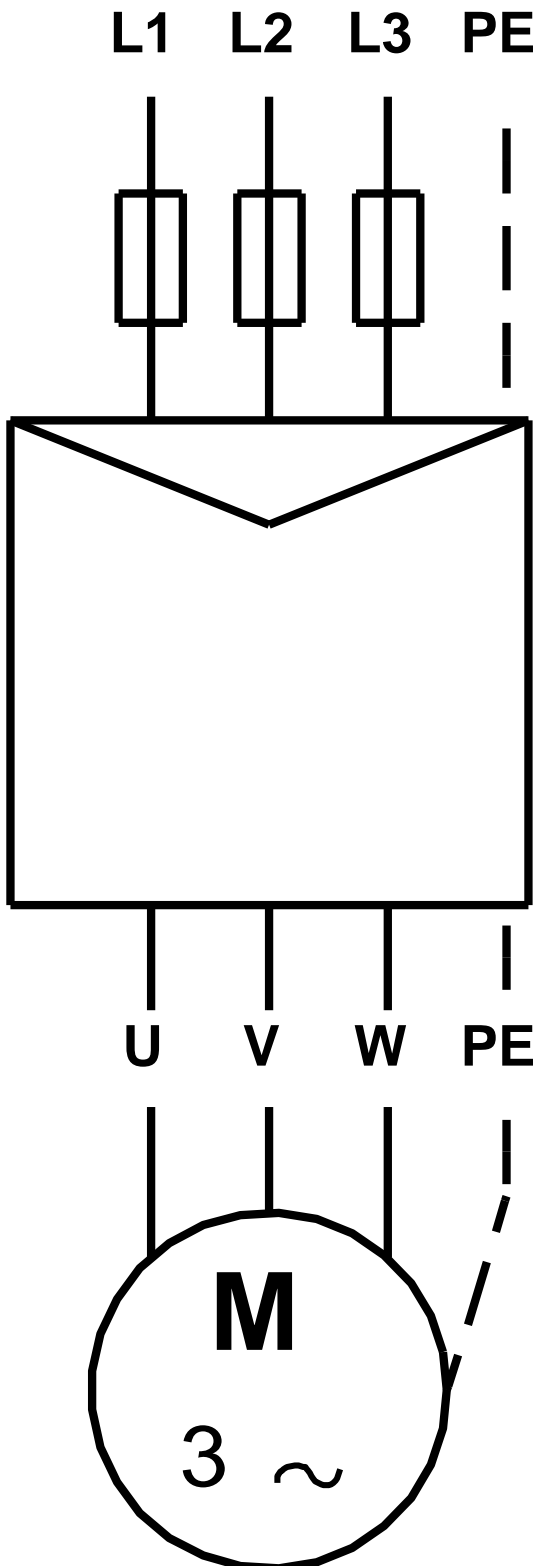

Note! All units are in [mm] unless others are stated.