

Qty.	Description
1	<p data-bbox="199 338 352 367"><b>SP 300-7D G</b></p>  <p data-bbox="592 770 1075 795"><b>Note! Product picture may differ from actual product</b></p> <p data-bbox="199 801 464 831">Product No.: <a href="#">96431001</a></p> <p data-bbox="199 833 1453 884">Multi-stage submersible pump for raw water supply, groundwater lowering, pressure boosting and various industrial jobs.</p> <p data-bbox="199 889 1287 918">The pump is suitable for pumping clean, thin, non-aggressive liquids without solid particles or fibres.</p> <p data-bbox="199 949 1430 1001">Pump: The pump is made entirely of Cast iron DIN W.-Nr. EN-JL1040 and suitable for horizontal installation.</p> <p data-bbox="199 1008 743 1037">The pump is fitted with a built-in non-return valve.</p> <p data-bbox="199 1068 1414 1120">Phase: The motor is a 3-phase motor with sand shield, liquid-lubricated bearings and pressure equalizing diaphragm.</p> <p data-bbox="199 1126 1070 1155">Performance test according to ISO9906 2012 Grade 3B is available on request.</p> <p data-bbox="199 1184 699 1361">Liquid:  Pumped liquid: Water  Maximum liquid temperature: 40 °C  Max liquid t at 0.15 m/sec: 30 °C  Selected liquid temperature: 20 °C  Density: 998.2 kg/m<sup>3</sup></p> <p data-bbox="199 1393 764 1541">Technical:  Type of impeller: D  Shaft seal for motor: CER/CARBON  Curve tolerance: ISO9906:2012 3B  Motor version: T35</p> <p data-bbox="199 1572 802 1807">Materials:  Pump: Cast iron  EN-JL1040  Impeller: Zinc-free bronze  DIN W.-Nr. 2.1050.01  Motor: Cast iron  DIN W.-Nr. 0.6025  ASTM 35-40</p> <p data-bbox="199 1839 647 1955">Installation:  Flange standard: DIN  Pump outlet: DN175  Motor diameter: 12 inch</p> <p data-bbox="199 1986 695 2103">Electrical data:  Motor type: MMS12000  Rated power - P2: 250 kW  Mains frequency: 50 Hz</p>



Company name:

Created by:

Phone:

Date:

12/11/2020

Qty.	Description
------	-------------

Rated voltage:	3 x 380-400-415 V
Rated current:	515-505-510 A
Cos phi - power factor:	0.89-0.85-0.81
Rated speed:	2920-2920-2930 rpm
Start. method:	direct-on-line
Enclosure class (IEC 34-5):	IP68
Built-in temp. transmitter:	no
Motor No:	96430686
Windings:	PE2/PA

Others:

Net weight:	1090 kg
Shipping volume:	0.886 m <sup>3</sup>
Country of origin:	IT
Custom tariff no.:	84137029

## 96431001 SP 300-7D G 50 Hz

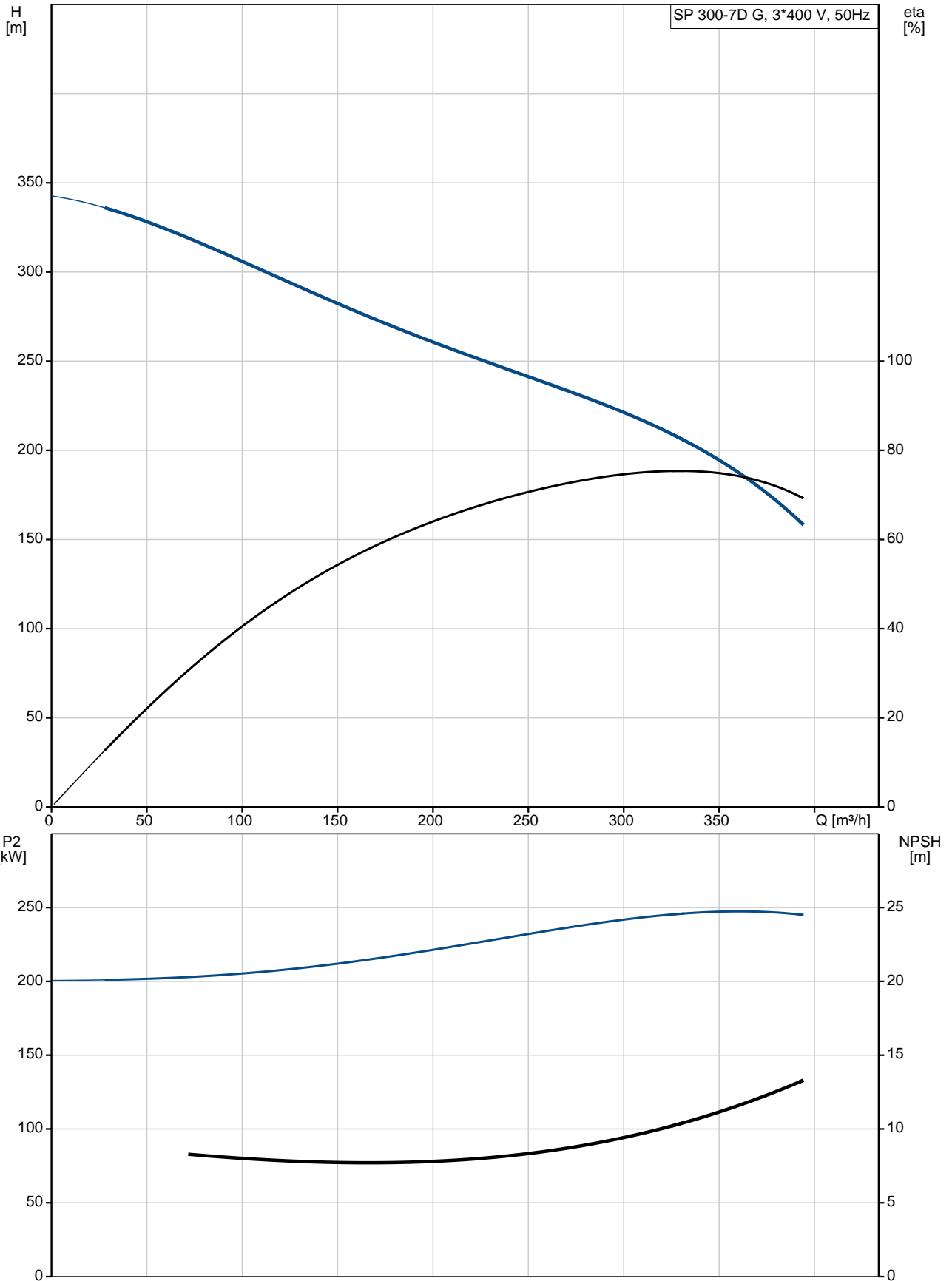

Description	Value
<b>General information:</b>	
Product name:	SP 300-7D G
Product No:	96431001
EAN number:	5700393033368
<b>Technical:</b>	
Stages:	7
Type of impeller:	D
Shaft seal for motor:	CER/CARBON
Curve tolerance:	ISO9906:2012 3B
Pump No:	96430903
Valve:	pump with built-in non-return valve
Motor version:	T35
<b>Materials:</b>	
Pump:	Cast iron
Pump:	EN-JL1040
Impeller:	Zinc-free bronze
Impeller:	DIN W.-Nr. 2.1050.01
Motor:	Cast iron
Motor:	DIN W.-Nr. 0.6025
Motor:	ASTM 35-40
<b>Installation:</b>	
Flange standard:	DIN
Pump outlet:	DN175
Motor diameter:	12 inch
<b>Liquid:</b>	
Pumped liquid:	Water
Maximum liquid temperature:	40 °C
Max liquid t at 0.15 m/sec:	30 °C
Selected liquid temperature:	20 °C
Density:	998.2 kg/m <sup>3</sup>
<b>Electrical data:</b>	
Motor type:	MMS12000
Applic. motor:	GRUNDFOS
Rated power - P2:	250 kW
Mains frequency:	50 Hz
Rated voltage:	3 x 380-400-415 V
Rated current:	515-505-510 A
Cos phi - power factor:	0.89-0.85-0.81
Rated speed:	2920-2920-2930 rpm
Start. method:	direct-on-line
Enclosure class (IEC 34-5):	IP68
Motor protec:	NONE
Thermal protec:	external
Built-in temp. transmitter:	no
Motor No:	96430686
Windings:	PE2/PA
<b>Others:</b>	
Net weight:	1090 kg
Shipping volume:	0.886 m <sup>3</sup>
Country of origin:	IT
Custom tariff no.:	84137029

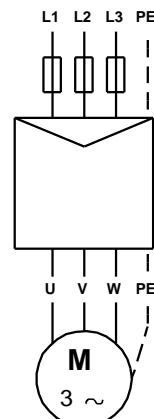
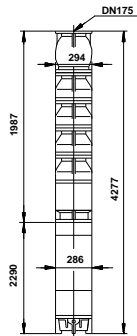
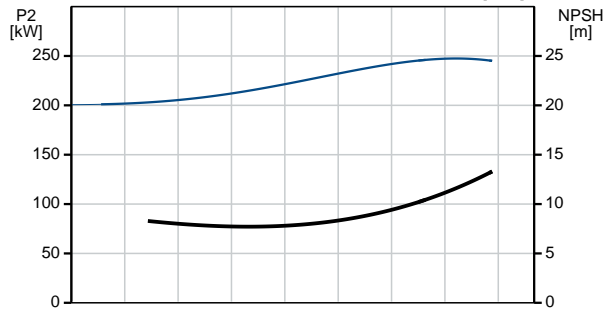
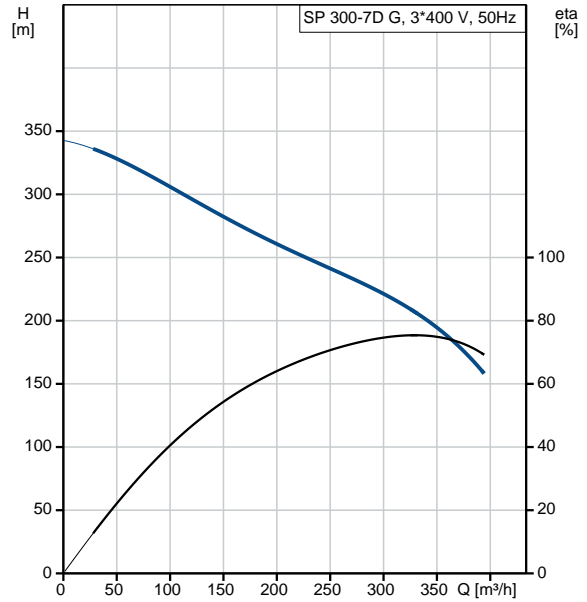

## 96431001 SP 300-7D G 50 Hz

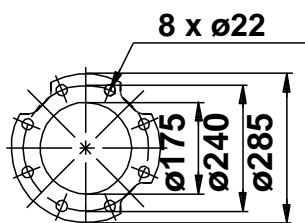
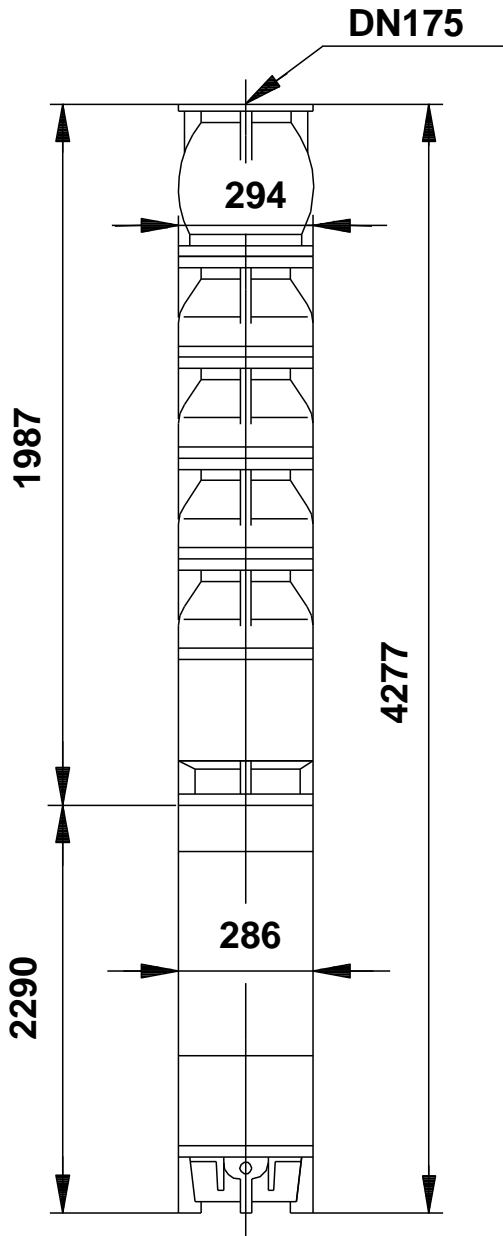

Note! All units are in [mm] unless others are stated.  
Disclaimer: This simplified dimensional drawing does not show all details.

96431001 SP 300-7D G 50 Hz

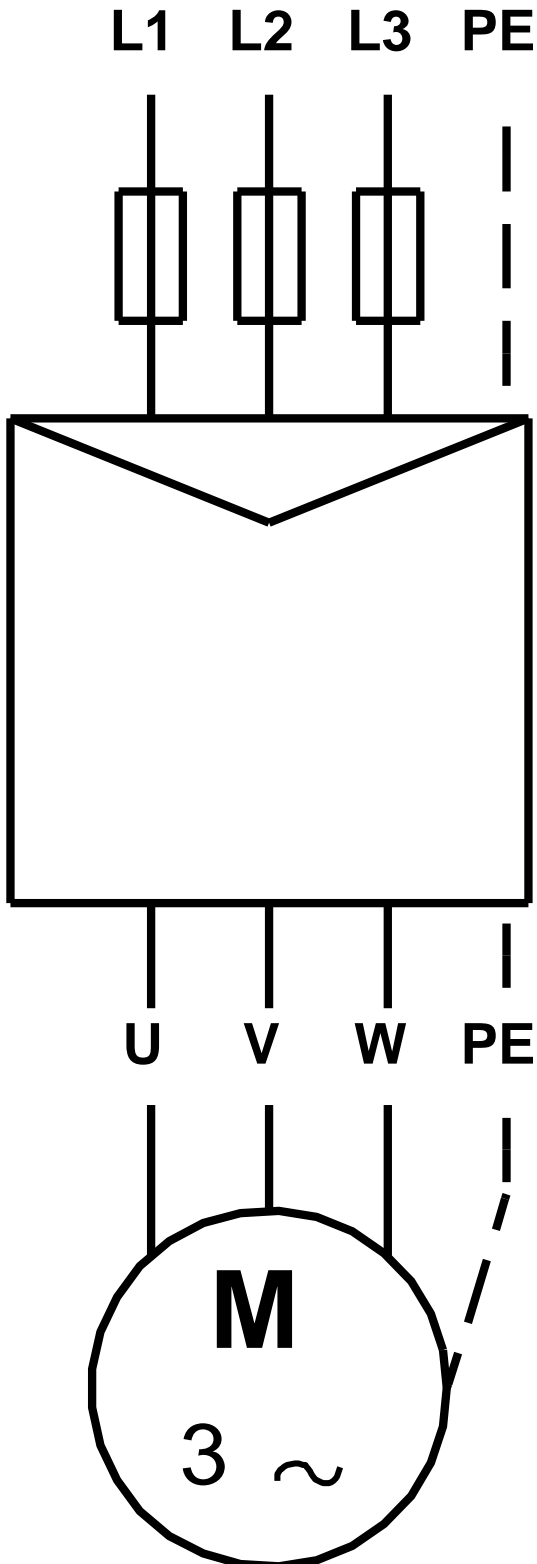

Note! All units are in [mm] unless others are stated.