

Qty.	Description
1	<p data-bbox="199 338 352 369"><b>SP 300-6A G</b></p>  <p data-bbox="592 770 1075 795"><b>Note! Product picture may differ from actual product</b></p> <p data-bbox="199 801 469 831">Product No.: <a href="#">96431000</a></p> <p data-bbox="199 831 1453 884">Multi-stage submersible pump for raw water supply, groundwater lowering, pressure boosting and various industrial jobs.</p> <p data-bbox="199 887 1287 918">The pump is suitable for pumping clean, thin, non-aggressive liquids without solid particles or fibres.</p> <p data-bbox="199 947 1431 1001">Pump: The pump is made entirely of Cast iron DIN W.-Nr. EN-JL1040 and suitable for horizontal installation.</p> <p data-bbox="199 1005 745 1037">The pump is fitted with a built-in non-return valve.</p> <p data-bbox="199 1066 1415 1120">Phase: The motor is a 3-phase motor with sand shield, liquid-lubricated bearings and pressure equalizing diaphragm.</p> <p data-bbox="199 1124 1072 1155">Performance test according to ISO9906 2012 Grade 3B is available on request.</p> <p data-bbox="199 1184 277 1216">Liquid:</p> <p data-bbox="199 1216 635 1247">Pumped liquid: Water</p> <p data-bbox="199 1247 632 1279">Maximum liquid temperature: 40 °C</p> <p data-bbox="199 1279 632 1310">Max liquid t at 0.15 m/sec: 30 °C</p> <p data-bbox="199 1310 632 1341">Selected liquid temperature: 20 °C</p> <p data-bbox="199 1341 699 1373">Density: 998.2 kg/m<sup>3</sup></p> <p data-bbox="199 1402 319 1433">Technical:</p> <p data-bbox="199 1433 584 1464">Type of impeller: A</p> <p data-bbox="199 1464 732 1496">Shaft seal for motor: CER/CARBON</p> <p data-bbox="199 1496 764 1527">Curve tolerance: ISO9906:2012 3B</p> <p data-bbox="199 1527 611 1559">Motor version: T35</p> <p data-bbox="199 1588 312 1619">Materials:</p> <p data-bbox="199 1619 692 1659">Pump: Cast iron EN-JL1040</p> <p data-bbox="199 1659 802 1722">Impeller: Zinc-free bronze DIN W.-Nr. 2.1050.01</p> <p data-bbox="199 1722 772 1807">Motor: Cast iron DIN W.-Nr. 0.6025 ASTM 35-40</p> <p data-bbox="199 1836 330 1868">Installation:</p> <p data-bbox="199 1868 611 1899">Flange standard: DIN</p> <p data-bbox="199 1899 647 1930">Pump outlet: DN175</p> <p data-bbox="199 1930 647 1962">Motor diameter: 12 inch</p> <p data-bbox="199 1991 368 2022">Electrical data:</p> <p data-bbox="199 2022 695 2054">Motor type: MMS12000</p> <p data-bbox="199 2054 652 2085">Rated power - P2: 250 kW</p> <p data-bbox="199 2085 635 2116">Mains frequency: 50 Hz</p>



Company name:

Created by:

Phone:

Date:

12/11/2020

Qty.	Description
------	-------------

Rated voltage:	3 x 380-400-415 V
Rated current:	515-505-510 A
Cos phi - power factor:	0.89-0.85-0.81
Rated speed:	2920-2920-2930 rpm
Start. method:	direct-on-line
Enclosure class (IEC 34-5):	IP68
Built-in temp. transmitter:	no
Motor No:	96430686
Windings:	PE2/PA

Others:	
Net weight:	1060 kg
Shipping volume:	0.846 m <sup>3</sup>

## 96431000 SP 300-6A G 50 Hz

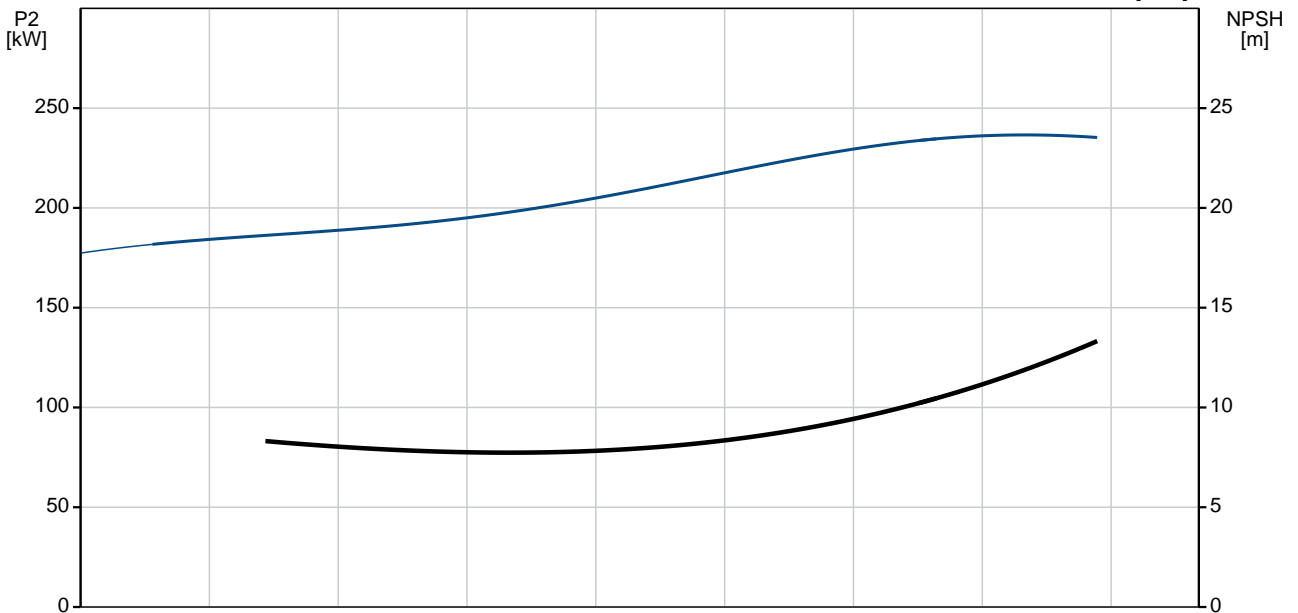
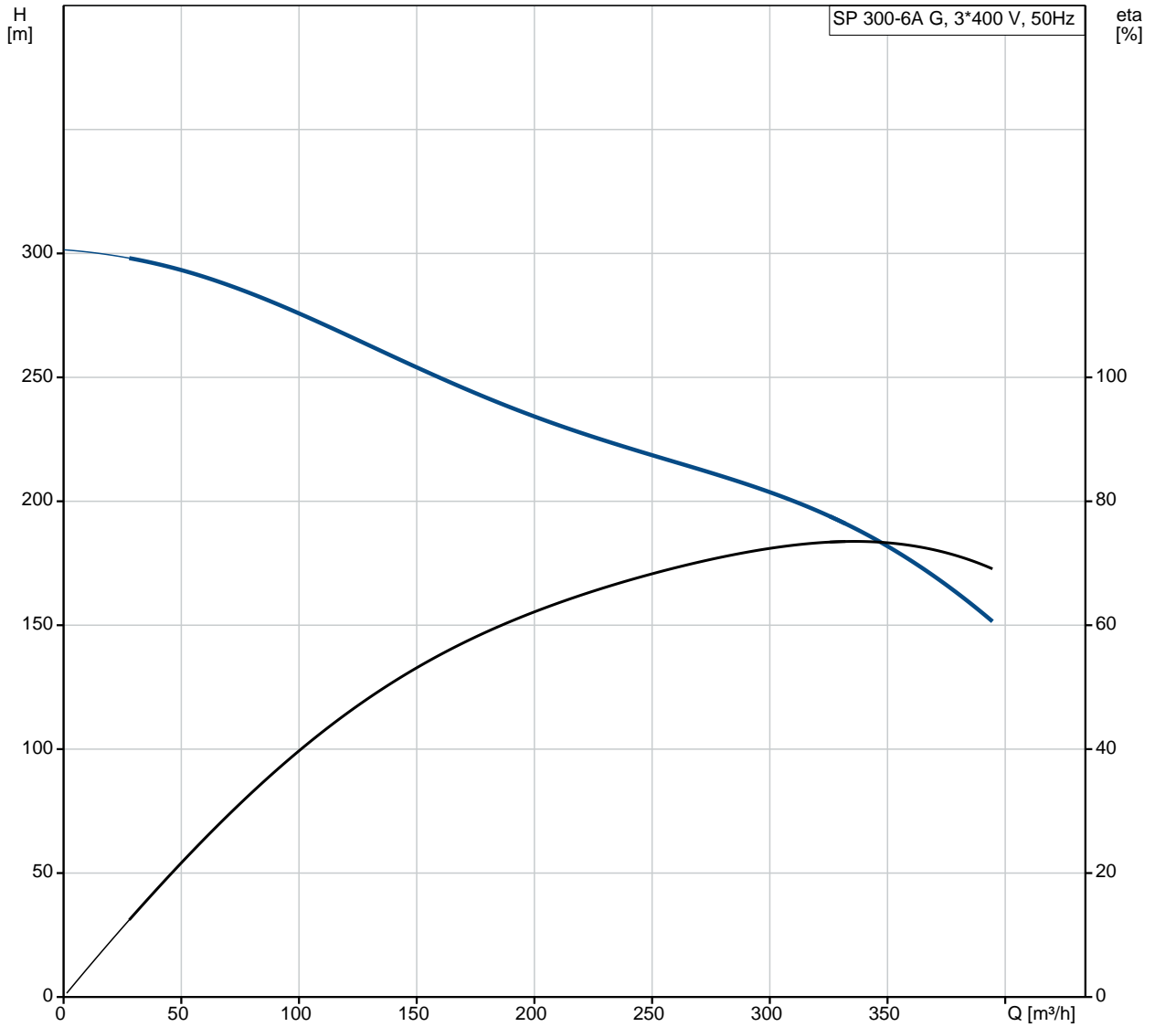

Description	Value
<b>General information:</b>	
Product name:	SP 300-6A G
Product No:	96431000
EAN number:	5700393033351
<b>Technical:</b>	
Stages:	6
Type of impeller:	A
Shaft seal for motor:	CER/CARBON
Curve tolerance:	ISO9906:2012 3B
Pump No:	96430902
Valve:	pump with built-in non-return valve
Motor version:	T35
<b>Materials:</b>	
Pump:	Cast iron
Pump:	EN-JL1040
Impeller:	Zinc-free bronze
Impeller:	DIN W.-Nr. 2.1050.01
Motor:	Cast iron
Motor:	DIN W.-Nr. 0.6025
Motor:	ASTM 35-40
<b>Installation:</b>	
Flange standard:	DIN
Pump outlet:	DN175
Motor diameter:	12 inch
<b>Liquid:</b>	
Pumped liquid:	Water
Maximum liquid temperature:	40 °C
Max liquid t at 0.15 m/sec:	30 °C
Selected liquid temperature:	20 °C
Density:	998.2 kg/m <sup>3</sup>
<b>Electrical data:</b>	
Motor type:	MMS12000
Applic. motor:	GRUNDFOS
Rated power - P2:	250 kW
Mains frequency:	50 Hz
Rated voltage:	3 x 380-400-415 V
Rated current:	515-505-510 A
Cos phi - power factor:	0.89-0.85-0.81
Rated speed:	2920-2920-2930 rpm
Start. method:	direct-on-line
Enclosure class (IEC 34-5):	IP68
Motor protec:	NONE
Thermal protec:	external
Built-in temp. transmitter:	no
Motor No:	96430686
Windings:	PE2/PA
<b>Others:</b>	
Net weight:	1060 kg
Shipping volume:	0.846 m <sup>3</sup>

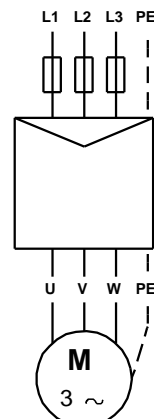
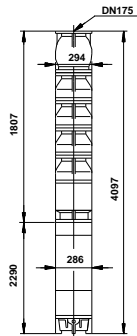
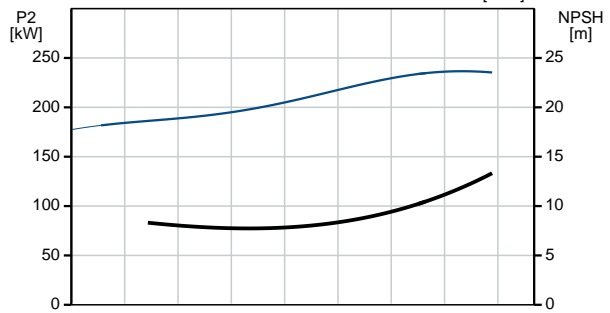
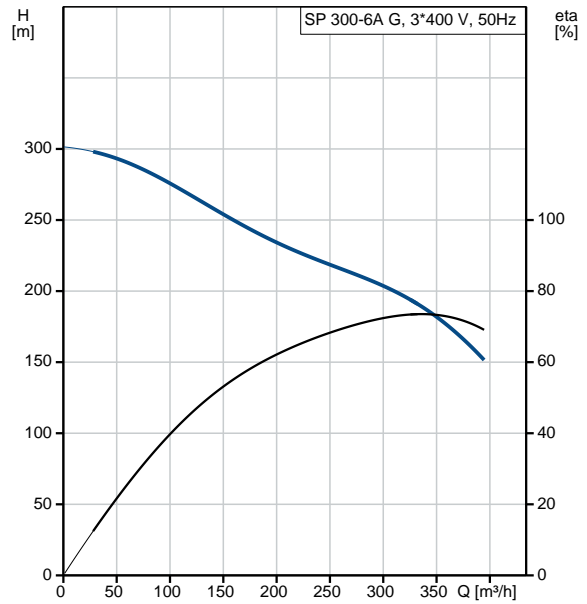

## 96431000 SP 300-6A G 50 Hz

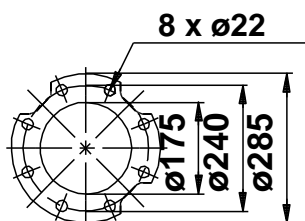
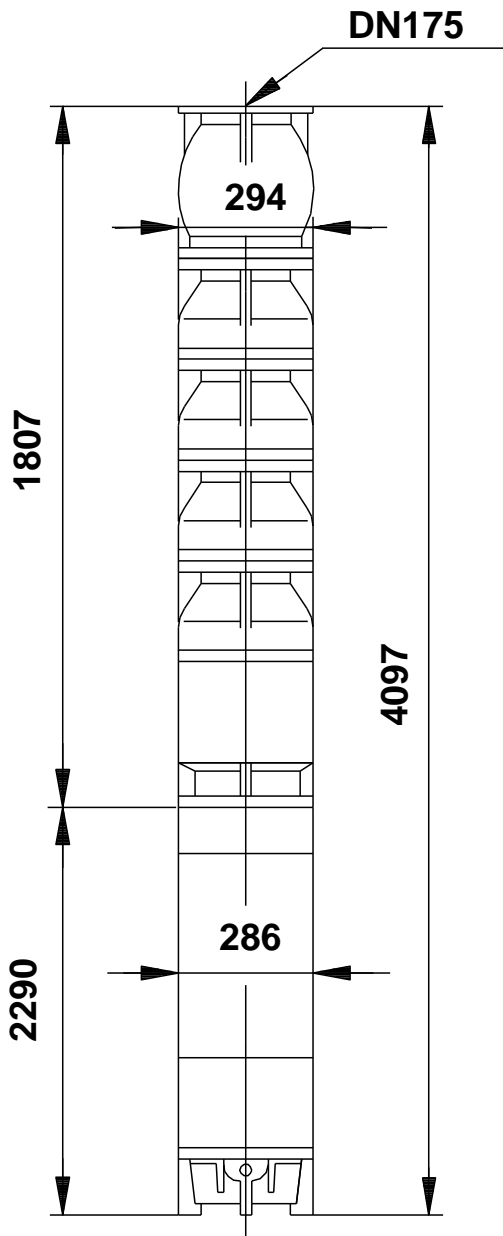

Note! All units are in [mm] unless others are stated.  
Disclaimer: This simplified dimensional drawing does not show all details.

**96431000 SP 300-6A G 50 Hz**

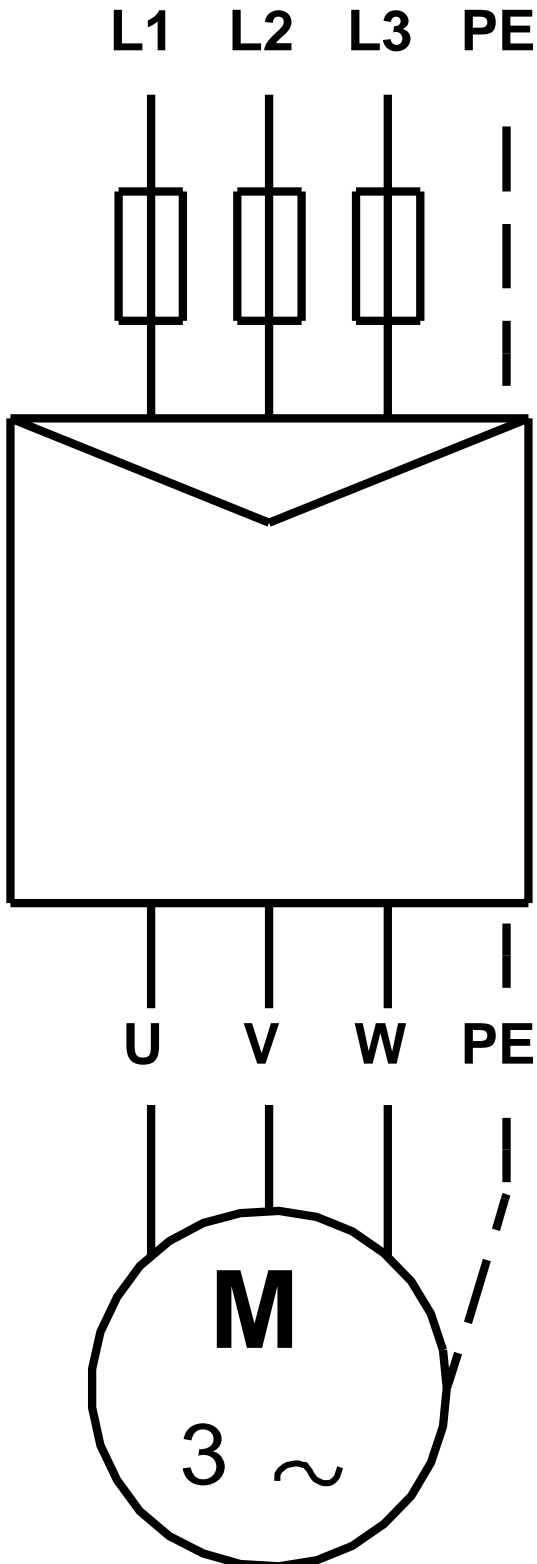

Note! All units are in [mm] unless others are stated.