

Qty.	Description
1	<p data-bbox="199 336 351 369"><b>SP 300-5D G</b></p>  <p data-bbox="590 772 1077 795"><b>Note! Product picture may differ from actual product</b></p> <p data-bbox="199 801 470 828">Product No.: <a href="#">96430997</a></p> <p data-bbox="199 833 1452 884">Multi-stage submersible pump for raw water supply, groundwater lowering, pressure boosting and various industrial jobs.</p> <p data-bbox="199 889 1284 918">The pump is suitable for pumping clean, thin, non-aggressive liquids without solid particles or fibres.</p> <p data-bbox="199 952 1428 996">Pump: The pump is made entirely of Cast iron DIN W.-Nr. EN-JL1040 and suitable for horizontal installation.</p> <p data-bbox="199 1008 742 1034">The pump is fitted with a built-in non-return valve.</p> <p data-bbox="199 1068 1412 1120">Phase: The motor is a 3-phase motor with sand shield, liquid-lubricated bearings and pressure equalizing diaphragm.</p> <p data-bbox="199 1124 1077 1153">Performance test according to ISO9906 2012 Grade 3B is available on request.</p> <p data-bbox="199 1182 702 1361">Liquid:  Pumped liquid: Water  Maximum liquid temperature: 40 °C  Max liquid t at 0.15 m/sec: 25 °C  Selected liquid temperature: 20 °C  Density: 998.2 kg/m<sup>3</sup></p> <p data-bbox="199 1393 766 1541">Technical:  Type of impeller: D  Shaft seal for motor: CER/CARBON  Curve tolerance: ISO9906:2012 3B  Motor version: T30</p> <p data-bbox="199 1572 805 1809">Materials:  Pump: Cast iron  EN-JL1040  Impeller: Zinc-free bronze  DIN W.-Nr. 2.1050.01  Motor: Cast iron  DIN W.-Nr. 0.6025  ASTM 35-40</p> <p data-bbox="199 1841 646 1960">Installation:  Flange standard: DIN  Pump outlet: DN175  Motor diameter: 12 inch</p> <p data-bbox="199 1991 694 2105">Electrical data:  Motor type: MMS12000  Rated power - P2: 190 kW  Mains frequency: 50 Hz</p>



Company name:

Created by:

Phone:

Date:

12/11/2020

Qty.	Description
	<p>Rated voltage: 3 x 380-400-415 V Rated current: 390-390-395 A Cos phi - power factor: 0.88-0.84-0.80 Rated speed: 2920-2930-2930 rpm Start. method: direct-on-line Enclosure class (IEC 34-5): IP68 Built-in temp. transmitter: no Motor No: 96430684 Windings: PVC</p> <p>Others: Net weight: 910 kg Shipping volume: 0.846 m<sup>3</sup></p>

## 96430997 SP 300-5D G 50 Hz

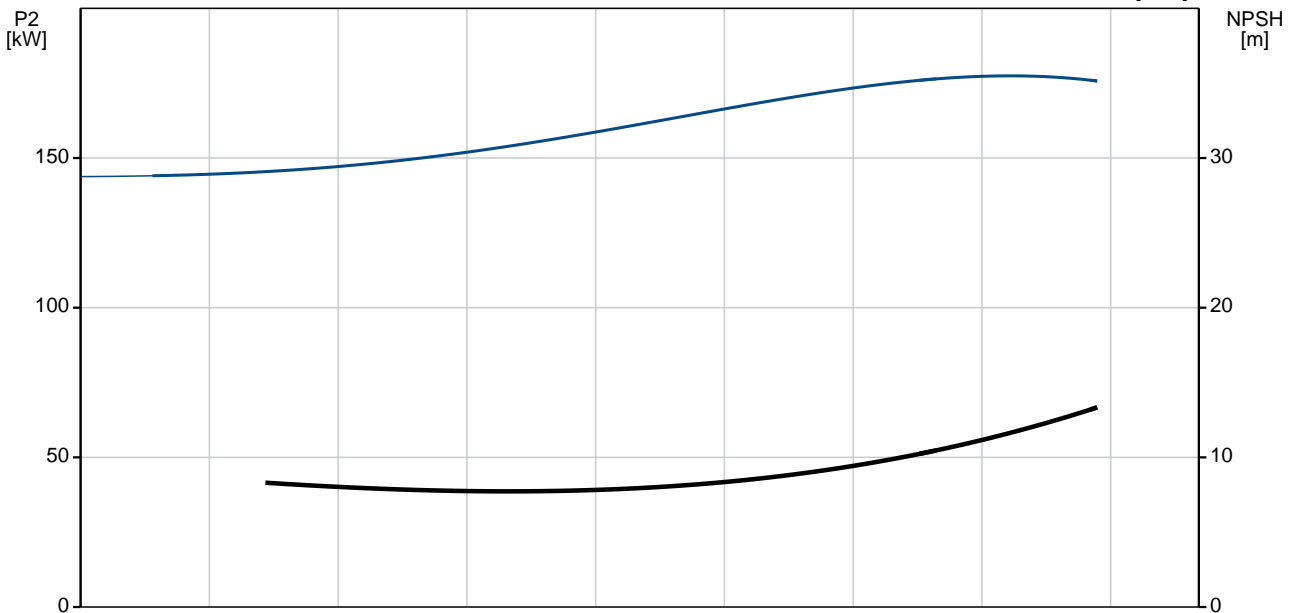
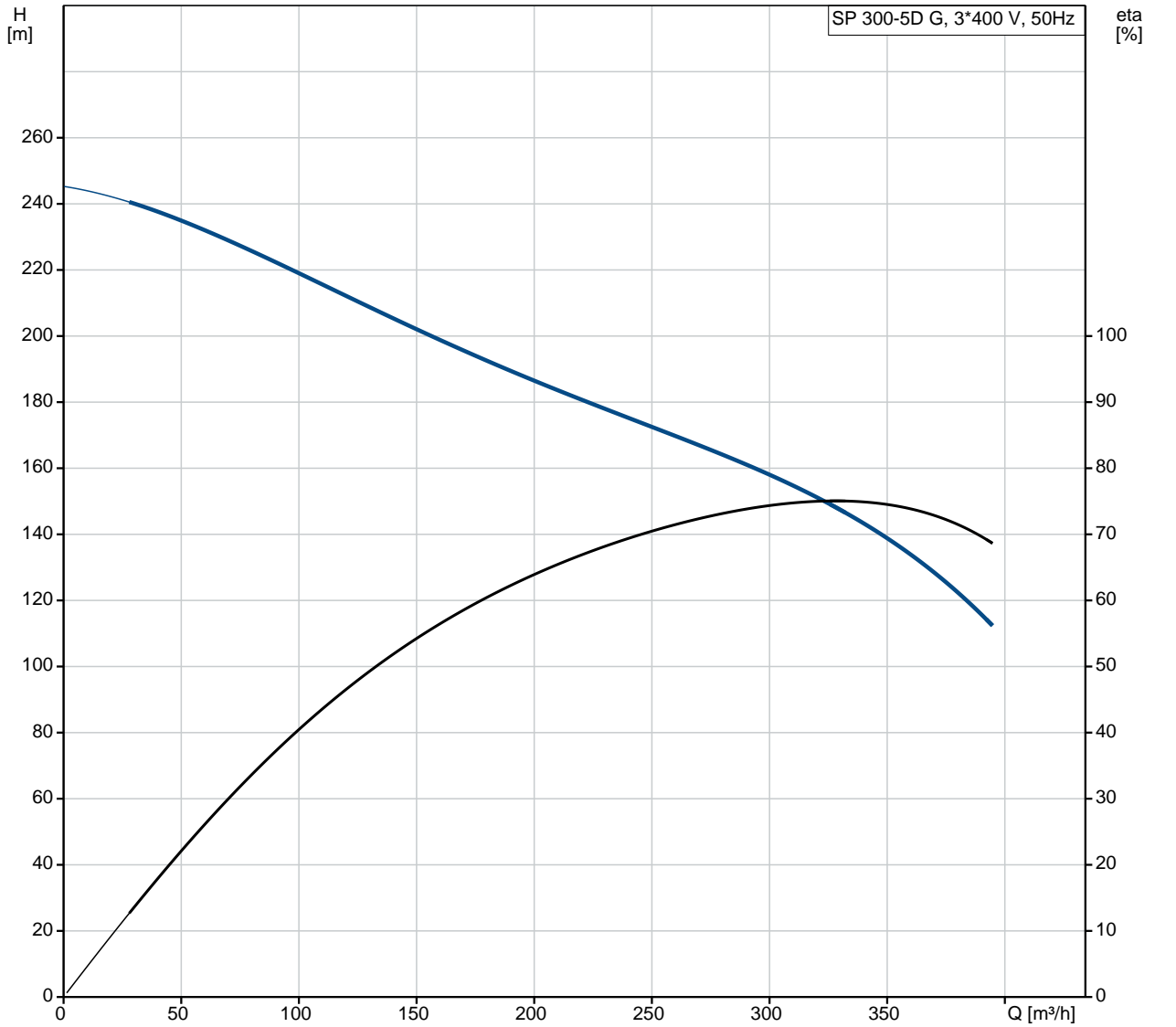

Description	Value
<b>General information:</b>	
Product name:	SP 300-5D G
Product No:	96430997
EAN number:	5700393033320
<b>Technical:</b>	
Stages:	5
Type of impeller:	D
Shaft seal for motor:	CER/CARBON
Curve tolerance:	ISO9906:2012 3B
Pump No:	96430899
Valve:	pump with built-in non-return valve
Motor version:	T30
<b>Materials:</b>	
Pump:	Cast iron
Pump:	EN-JL1040
Impeller:	Zinc-free bronze
Impeller:	DIN W.-Nr. 2.1050.01
Motor:	Cast iron
Motor:	DIN W.-Nr. 0.6025
Motor:	ASTM 35-40
<b>Installation:</b>	
Flange standard:	DIN
Pump outlet:	DN175
Motor diameter:	12 inch
<b>Liquid:</b>	
Pumped liquid:	Water
Maximum liquid temperature:	40 °C
Max liquid t at 0.15 m/sec:	25 °C
Selected liquid temperature:	20 °C
Density:	998.2 kg/m <sup>3</sup>
<b>Electrical data:</b>	
Motor type:	MMS12000
Applic. motor:	GRUNDFOS
Rated power - P2:	190 kW
Mains frequency:	50 Hz
Rated voltage:	3 x 380-400-415 V
Rated current:	390-390-395 A
Cos phi - power factor:	0.88-0.84-0.80
Rated speed:	2920-2930-2930 rpm
Start. method:	direct-on-line
Enclosure class (IEC 34-5):	IP68
Motor protec:	NONE
Thermal protec:	external
Built-in temp. transmitter:	no
Motor No:	96430684
Windings:	PVC
<b>Others:</b>	
Net weight:	910 kg
Shipping volume:	0.846 m <sup>3</sup>

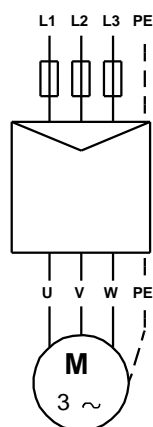
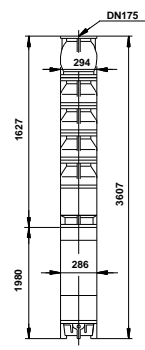
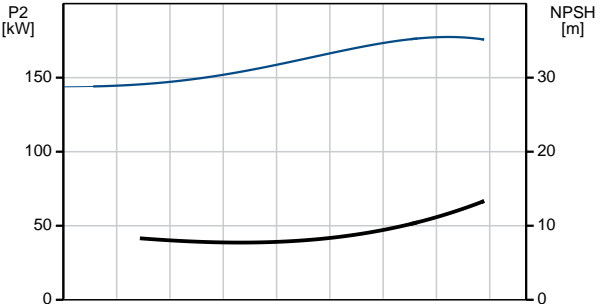
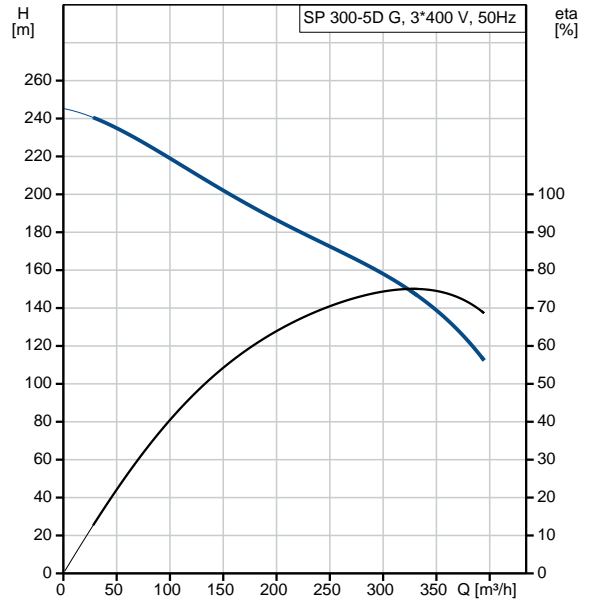

## 96430997 SP 300-5D G 50 Hz

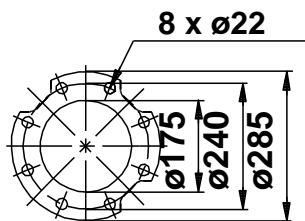
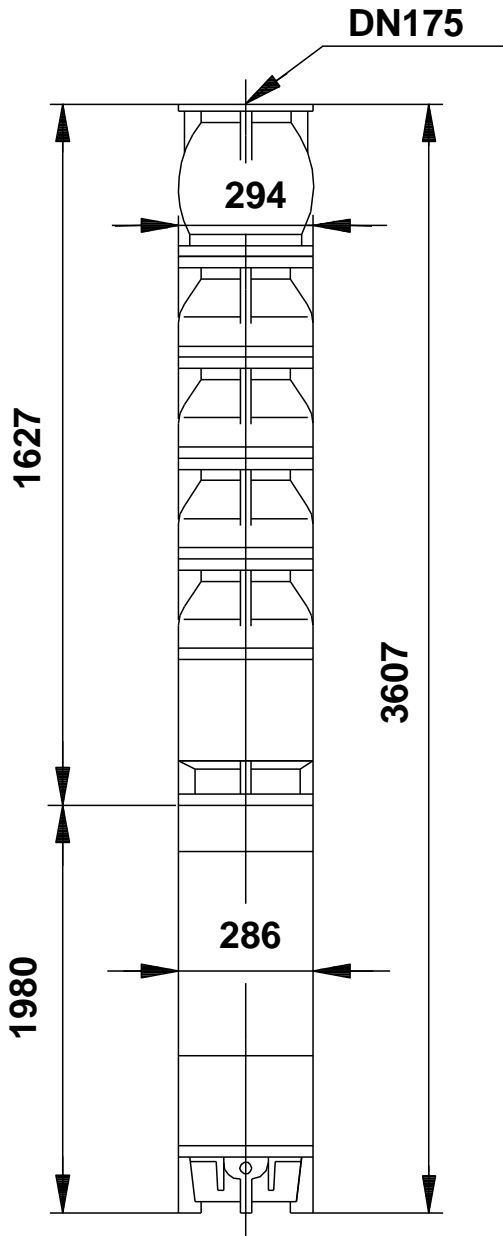

Note! All units are in [mm] unless others are stated.  
Disclaimer: This simplified dimensional drawing does not show all details.

96430997 SP 300-5D G 50 Hz

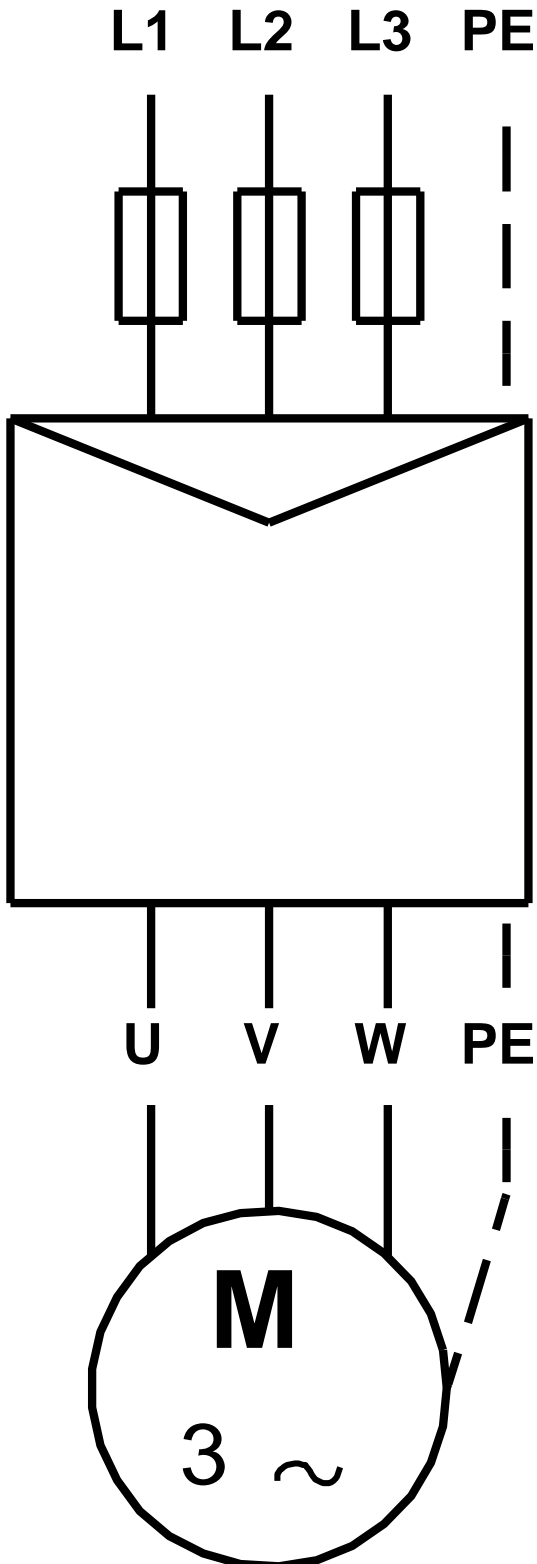

Note! All units are in [mm] unless others are stated.