

Qty.	Description
1	<p>SP 270-2L G</p>  <p style="text-align: center;">Note! Product picture may differ from actual product</p> <p>Product No.: 96430966 Multi-stage submersible pump for raw water supply, groundwater lowering, pressure boosting and various industrial jobs. The pump is suitable for pumping clean, thin, non-aggressive liquids without solid particles or fibres.</p> <p>Pump: The pump is made entirely of Cast iron DIN W.-Nr. EN-JL1040 and suitable for horizontal installation. The pump is fitted with a built-in non-return valve.</p> <p>Phase: The motor is a 3-phase motor with sand shield, liquid-lubricated bearings and pressure equalizing diaphragm. Performance test according to ISO9906 2012 Grade 3B is available on request.</p> <p>Liquid: Pumped liquid: Water Maximum liquid temperature: 40 °C Max liquid t at 0.15 m/sec: 25 °C Selected liquid temperature: 20 °C Density: 998.2 kg/m³</p> <p>Technical: Pump speed on which pump data are based: 2900 rpm Rated flow: 270 m³/h Rated head: 36 m Type of impeller: L Shaft seal for motor: CER/CARBON Curve tolerance: ISO9906:2012 3B Motor version: T30</p> <p>Materials: Pump: Cast iron EN-JL1040 Impeller: Zinc-free bronze DIN W.-Nr. 2.1050.01 Motor: Cast iron DIN W.-Nr. 0.6025 ASTM 35-40</p> <p>Installation: Flange standard: DIN Pump outlet: DN175 Motor diameter: 8 inch</p> <p>Electrical data:</p>



Company name:

Created by:

Phone:

Date:

12/11/2020

Qty.	Description
	<p>Motor type: MMS8000</p> <p>Rated power - P2: 45 kW</p> <p>Mains frequency: 50 Hz</p> <p>Rated voltage: 3 x 380-400-415 V</p> <p>Rated current: 95.5-96.5-96.0 A</p> <p>Cos phi - power factor: 0.88-0.82-0.80</p> <p>Rated speed: 2900-2910-2920 rpm</p> <p>Start. method: direct-on-line</p> <p>Enclosure class (IEC 34-5): IP68</p> <p>Built-in temp. transmitter: no</p> <p>Motor No: 96430671</p> <p>Windings: PVC</p> <p>Others:</p> <p>Net weight: 342 kg</p> <p>Shipping volume: 0.494 m³</p> <p>Country of origin: IT</p> <p>Custom tariff no.: 84137029</p>

96430966 SP 270-2L G 50 Hz

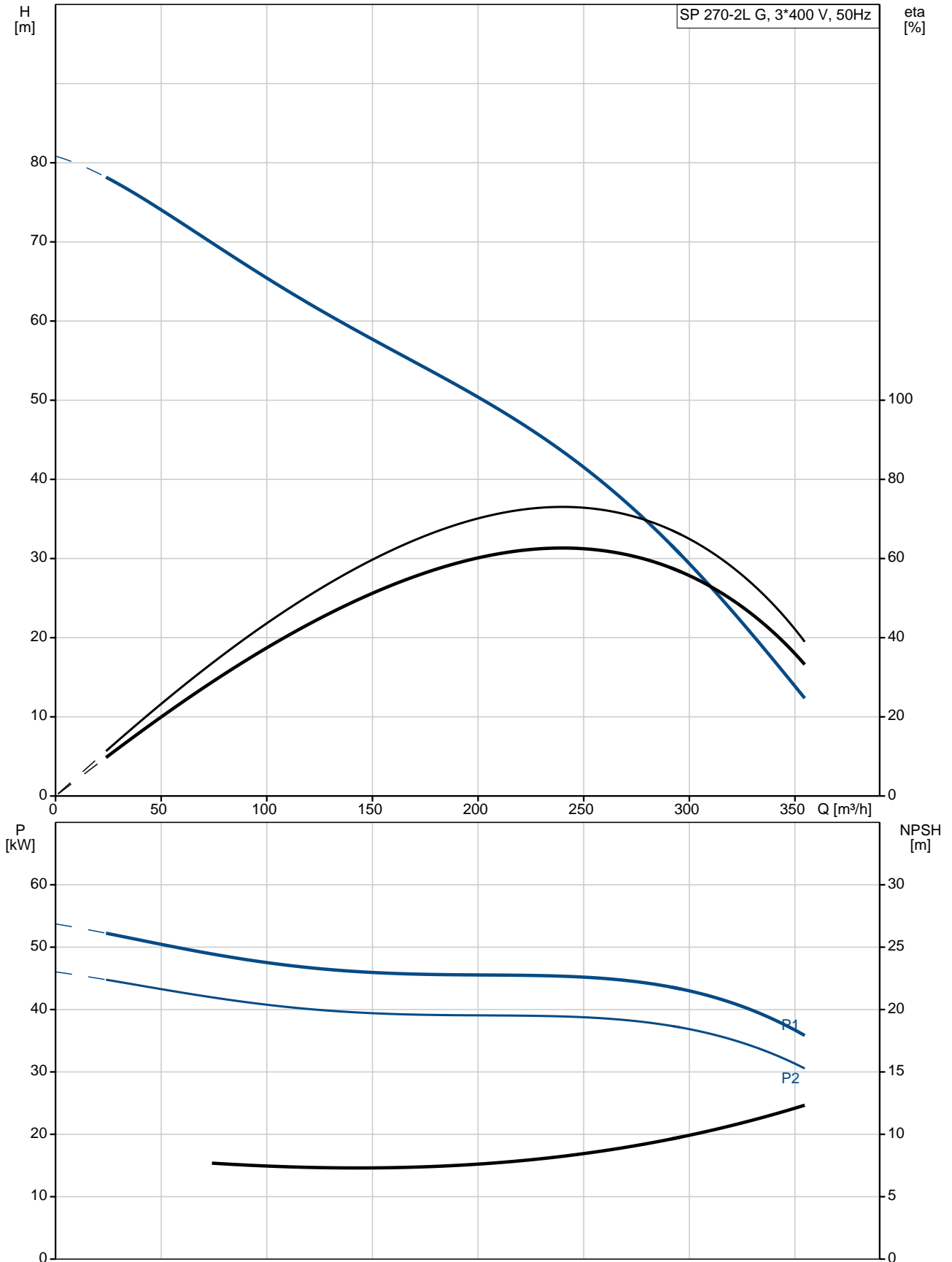

Description	Value
General information:	
Product name:	SP 270-2L G
Product No:	96430966
EAN number:	5700392954251
Technical:	
Pump speed on which pump data are based:	2900 rpm
Rated flow:	270 m ³ /h
Rated head:	36 m
Stages:	2
Type of impeller:	L
Shaft seal for motor:	CER/CARBON
Curve tolerance:	ISO9906:2012 3B
Pump No:	96430857
Model:	A
Valve:	pump with built-in non-return valve
Motor version:	T30
Materials:	
Pump:	Cast iron
Pump:	EN-JL1040
Impeller:	Zinc-free bronze
Impeller:	DIN W.-Nr. 2.1050.01
Motor:	Cast iron
Motor:	DIN W.-Nr. 0.6025
Motor:	ASTM 35-40
Installation:	
Flange standard:	DIN
Pump outlet:	DN175
Motor diameter:	8 inch
Liquid:	
Pumped liquid:	Water
Maximum liquid temperature:	40 °C
Max liquid t at 0.15 m/sec:	25 °C
Selected liquid temperature:	20 °C
Density:	998.2 kg/m ³
Electrical data:	
Motor type:	MMS8000
Applic. motor:	GRUNDFOS
Rated power - P2:	45 kW
Mains frequency:	50 Hz
Rated voltage:	3 x 380-400-415 V
Rated current:	95.5-96.5-96.0 A
Cos phi - power factor:	0.88-0.82-0.80
Rated speed:	2900-2910-2920 rpm
Start. method:	direct-on-line
Enclosure class (IEC 34-5):	IP68
Motor protec:	NONE
Thermal protec:	external
Built-in temp. transmitter:	no
Motor No:	96430671
Windings:	PVC
Others:	
Net weight:	342 kg
Shipping volume:	0.494 m ³
Country of origin:	IT
Custom tariff no.:	84137029

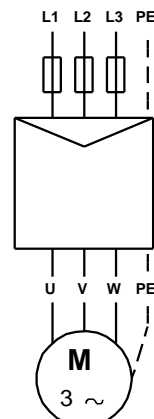
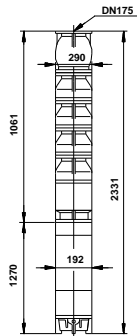
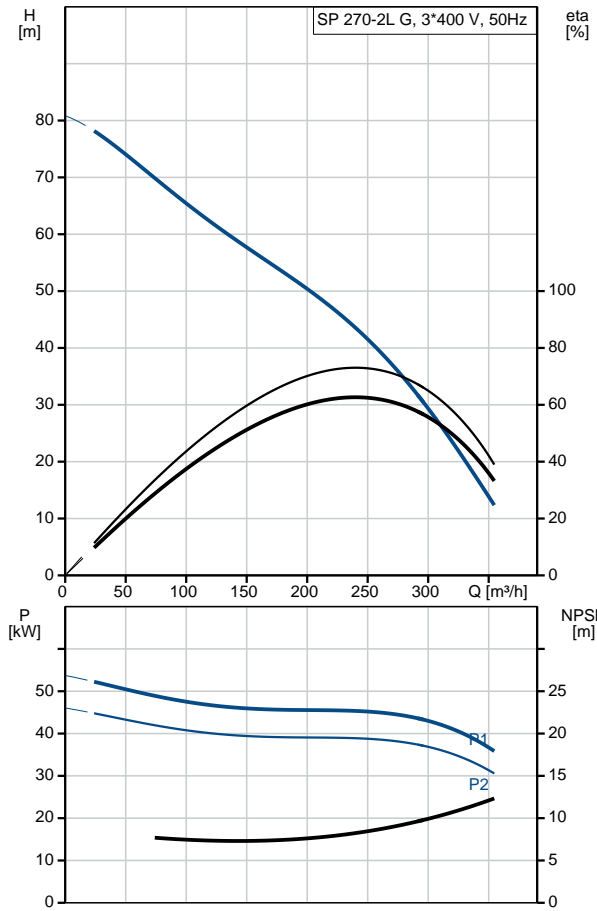

96430966 SP 270-2L G 50 Hz

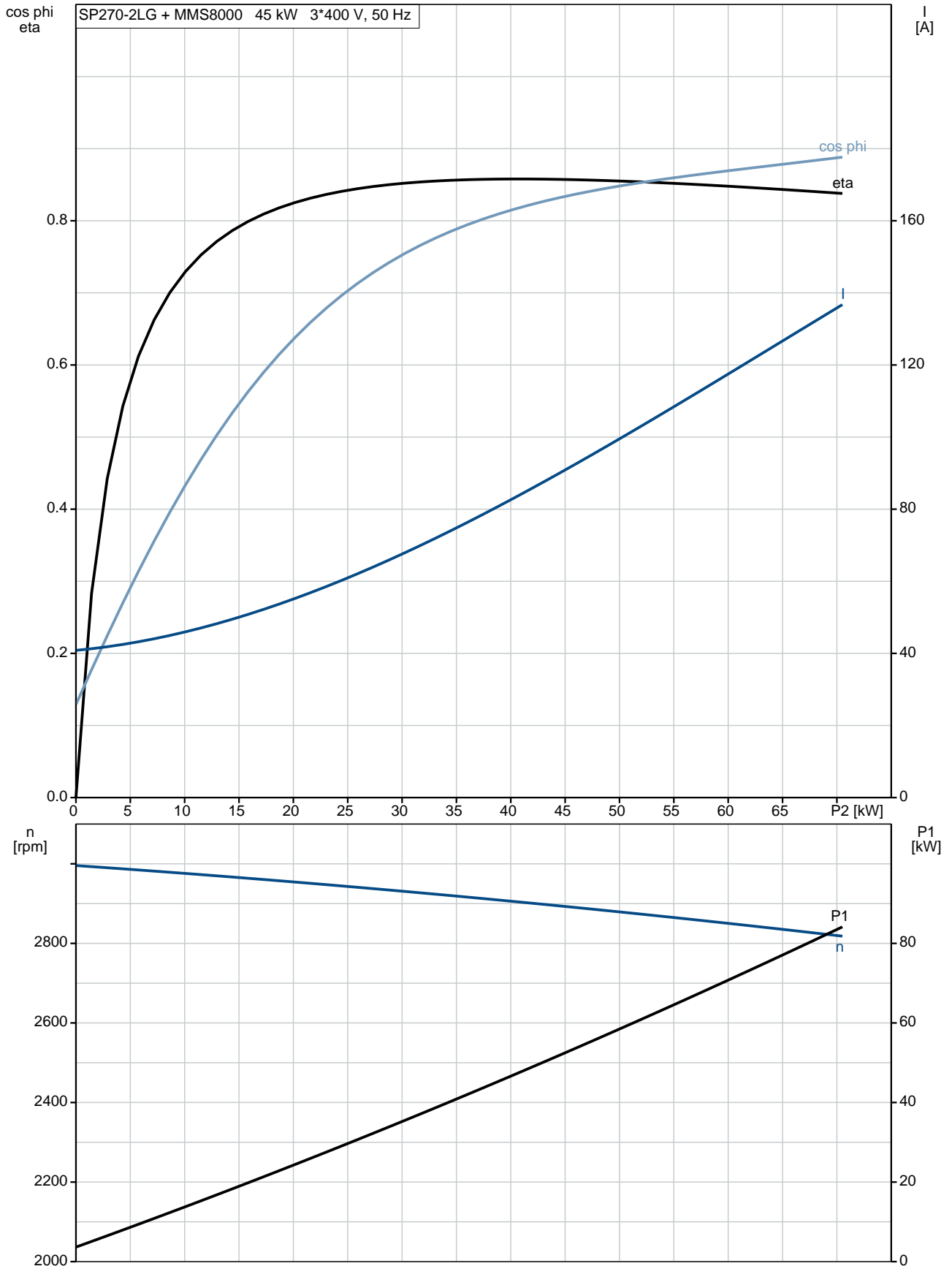

96430966 SP 270-2L G 50 Hz

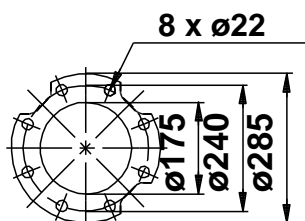
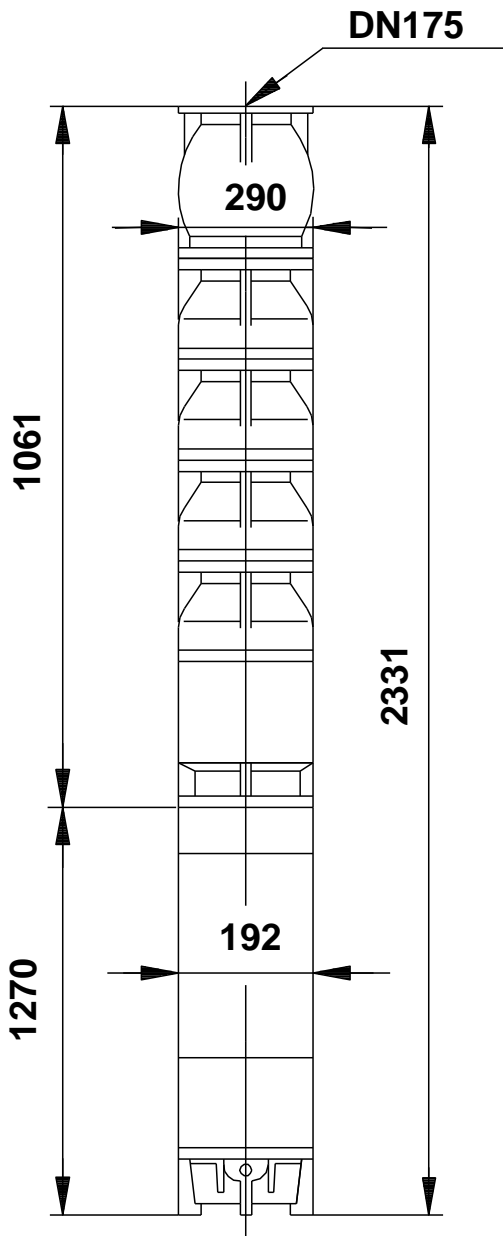

Note! All units are in [mm] unless others are stated.
Disclaimer: This simplified dimensional drawing does not show all details.

96430966 SP 270-2L G 50 Hz

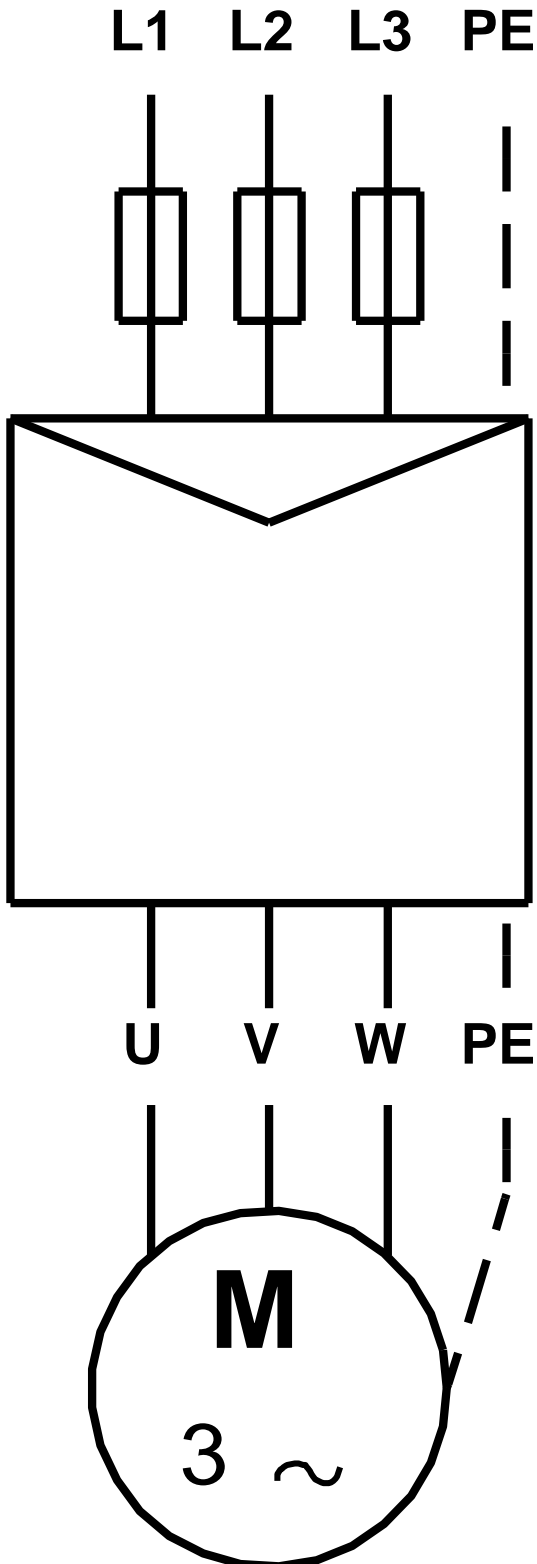

Note! All units are in [mm] unless others are stated.