

Position	Count	Description
	1	<p><b>TPD 150-110/6 A-F-A-BQQE</b></p>  <p>Product No.: <a href="#">96110024</a></p> <p>Single-stage, close-coupled, volute twin-head pump with in-line suction and discharge ports of identical diameter. The twin-head pump is designed with two parallel power-heads. The pump is of the top-pull-out design, i.e. the power head (motor, pump head and impeller) can be removed for maintenance or service while the pump housing remains in the pipework.</p> <p>Each power head is fitted with an unbalanced rubber bellows seal. The shaft seal is according to EN 12756. Pipework connection is via PN 16 DIN flanges (EN 1092-2 and ISO 7005-2).</p> <p>Each power head is fitted with a fan-cooled asynchronous motor of indential size.</p> <p><b>Liquid:</b>  Pumped liquid: Water  Liquid temperature range: -13 .. 248 °F  Liquid temperature during operation: 68 °F  Density: 62.29 lb/ft<sup>3</sup></p> <p><b>Technical:</b>  Rated flow: 704 US gpm  Rated head: 26.71 ft  Actual impeller diameter: 10.2 in  Primary shaft seal: BQQE  Curve tolerance: ISO9906:2012 3B</p> <p><b>Materials:</b>  Pump housing: Cast iron  EN-JL1040  ASTM A48-40 B  Impeller: Cast iron  EN-JL1030  ASTM A48-30 B</p> <p><b>Installation:</b>  Range of ambient temperature: -4 .. 131 °F  Maximum operating pressure: 232 psi  Flange standard: DIN  Pipe connection: DN 150  Pump inlet: DN 150  Pump outlet: DN 150  Pressure stage: PN 16  (@): 31.5 in  Flange size for motor: FF265</p> <p><b>Electrical data:</b>  Motor type: SIEMENS  IE Efficiency class: IE3  Rated power - P2: 2 x 7.5 HP  Power (P2) required by pump: 7.5 HP  Main frequency: 50 Hz</p>



Company name:

Created by:

Phone:

Date:

10/10/2018

Position	Count	Description
		Rated voltage: 3 x 380-420D/660-725Y V Rated current: 12,2-11,0/7,00-6,40 A Starting current: 660-660 % Cos phi - power factor: 0.8 Rated speed: 970 rpm IE efficiency: IE3 88,0% Motor efficiency at full load: 88.0-88.0 % Motor efficiency at 3/4 load: 89.1-89.1 % Motor efficiency at 1/2 load: 89.0-89.0 % Number of poles: 6 Enclosure class (IEC 34-5): 55 Dust/Jetting Insulation class (IEC 85): F  <b>Others:</b> Minimum efficiency index, MEI : 0.62 ErP status: EuP Standalone/Prod. Net weight: 1270 lb Gross weight: 1450 lb Shipping volume: 18.4 ft <sup>3</sup> Country of origin: HU Custom tariff no.: 84137065



Company name:

Created by:

Phone:

Date:

10/10/2018

### 96110024 TPD 150-110/6 A-F-A-BQQE 50 Hz

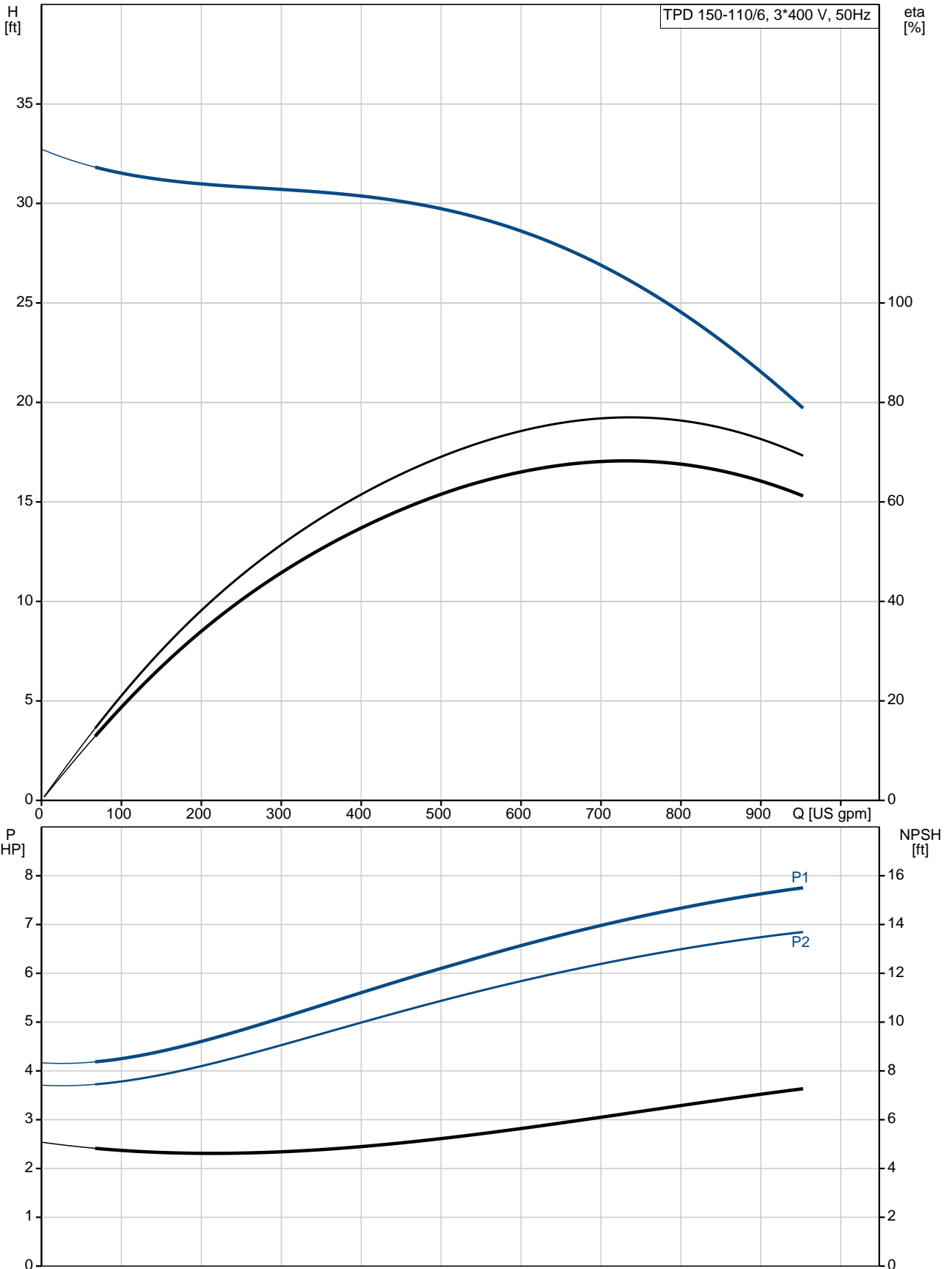

Description	Value
<b>General information:</b>	
Product name:	TPD 150-110/6 A-F-A-BQQE
Product No.:	96110024
EAN:	5700396990095
<b>Technical:</b>	
Rated flow:	704 US gpm
Rated head:	26.71 ft
Head max:	36.09 ft
Actual impeller diameter:	10.2 in
Primary shaft seal:	BQQE
Curve tolerance:	ISO9906:2012 3B
Pump version:	A
Model:	A
<b>Materials:</b>	
Pump housing:	Cast iron EN-JL1040 ASTM A48-40 B
Impeller:	Cast iron EN-JL1030 ASTM A48-30 B
Material code:	A
<b>Installation:</b>	
Range of ambient temperature:	-4 .. 131 °F
Maximum operating pressure:	232 psi
Flange standard:	DIN
Pipe connection:	DN 150
Pump inlet:	DN 150
Pump outlet:	DN 150
Pressure stage:	PN 16
(@)	31.5 in
Flange size for motor:	FF265
Connect code:	F
<b>Liquid:</b>	
Pumped liquid:	Water
Liquid temperature range:	-13 .. 248 °F
Liquid temperature during operation:	68 °F
Density:	62.29 lb/ft <sup>3</sup>
<b>Electrical data:</b>	
Motor type:	SIEMENS
IE Efficiency class:	IE3
Rated power - P2:	2 x 7.5 HP
Power (P2) required by pump:	7.5 HP
Main frequency:	50 Hz
Rated voltage:	3 x 380-420D/660-725Y V
Rated current:	12,2-11,0/7,00-6,40 A
Starting current:	660-660 %
Cos phi - power factor:	0.8
Rated speed:	970 rpm
IE efficiency:	IE3 88,0%
Motor efficiency at full load:	88.0-88.0 %
Motor efficiency at 3/4 load:	89.1-89.1 %
Motor efficiency at 1/2 load:	89.0-89.0 %
Number of poles:	6
Enclosure class (IEC 34-5):	55 Dust/Jetting
Insulation class (IEC 85):	F
Motor protection:	PTC
Motor Number:	83W15217

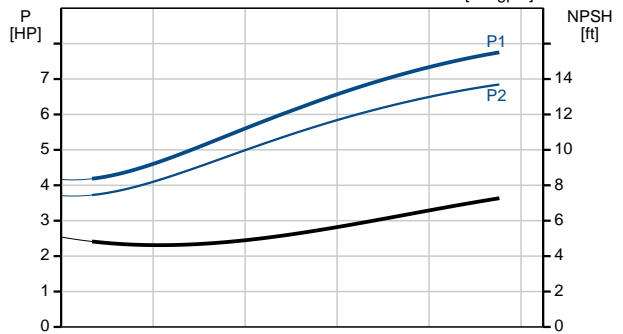
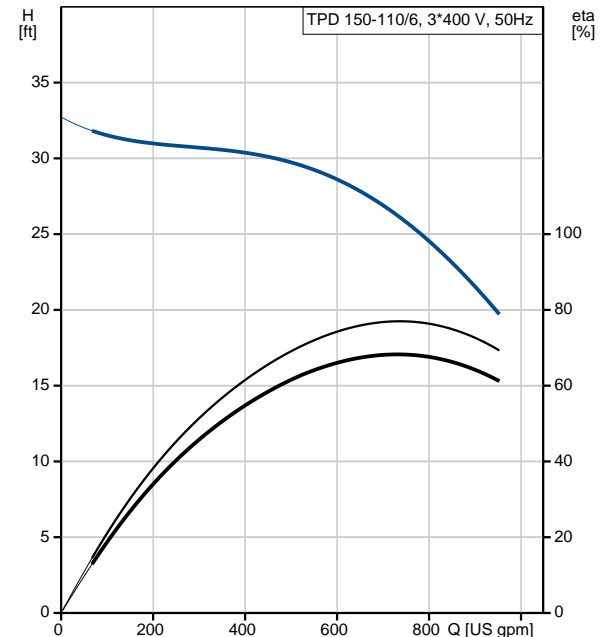



Company name:

Created by:

Phone:

Date:

10/10/2018

Description	Value
<b>Others:</b>	
Minimum efficiency index, MEI :	0.62
ErP status:	EuP Standalone/Prod.
Net weight:	1270 lb
Gross weight:	1450 lb
Shipping volume:	18.4 ft <sup>3</sup>
Country of origin:	HU
Custom tariff no.:	84137065

## 96110024 TPD 150-110/6 A-F-A-BQQE 50 Hz

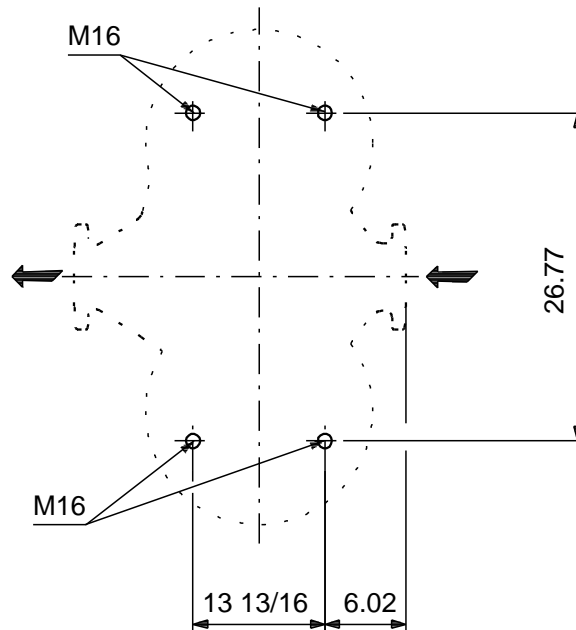
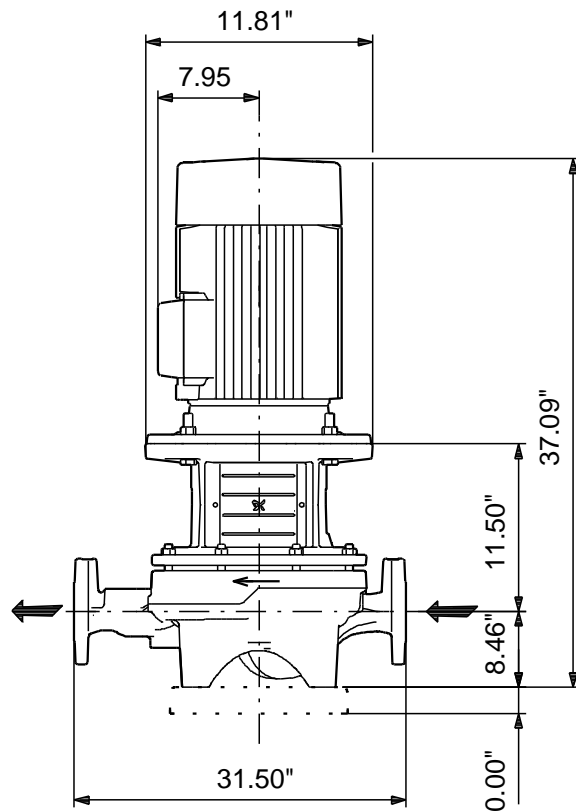
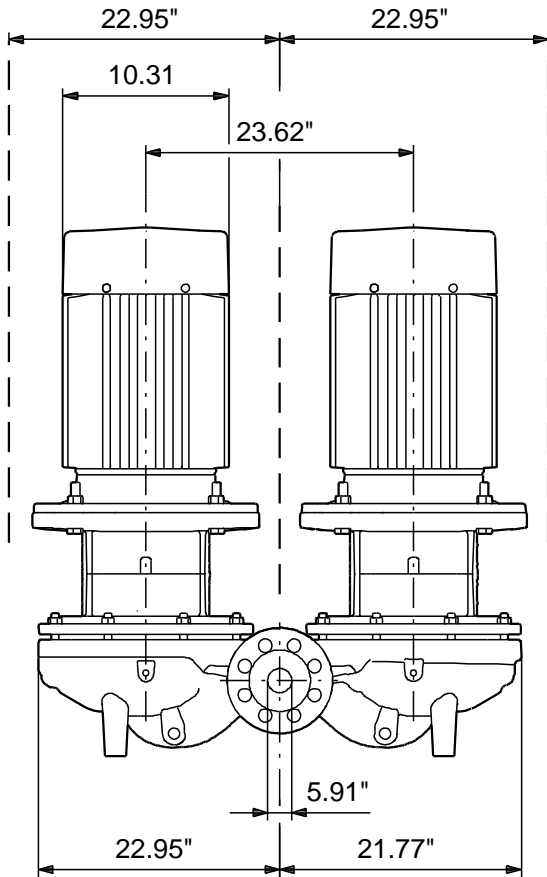

Note! All units are in [mm] unless otherwise stated.  
Disclaimer: This simplified dimensional drawing does not show all details.

## 96110024 TPD 150-110/6 A-F-A-BQQE 50 Hz



IEC TP211 THERMALLY PROTECTED WHEN THE THERMISTORS ARE  
CONNECTED TO AMPLIFIER RELAY FOR CONTROL OF MAIN SUPPLY  
THERMISTORS PTC ACCORDING TO DIN 44082

All units are [mm] unless otherwise presented.