

Position	Count	Description
	1	<p>TPD 125-70/6 A-F-A-BQQE</p>  <p>Product No.: 96109690</p> <p>Single-stage, close-coupled, volute twin-head pump with in-line suction and discharge ports of identical diameter. The twin-head pump is designed with two parallel power-heads. The pump is of the top-pull-out design, i.e. the power head (motor, pump head and impeller) can be removed for maintenance or service while the pump housing remains in the pipework.</p> <p>Each power head is fitted with an unbalanced rubber bellows seal. The shaft seal is according to EN 12756. Pipework connection is via PN 16 DIN flanges (EN 1092-2 and ISO 7005-2).</p> <p>Each power head is fitted with a fan-cooled asynchronous motor of identical size.</p> <p>Liquid:</p> <p>Pumped liquid: Water</p> <p>Liquid temperature range: -13 .. 248 °F</p> <p>Liquid temperature during operation: 68 °F</p> <p>Density: 62.29 lb/ft³</p> <p>Technical:</p> <p>Rated flow: 412 US gpm</p> <p>Rated head: 18.01 ft</p> <p>Actual impeller diameter: 8.5 in</p> <p>Primary shaft seal: BQQE</p> <p>Curve tolerance: ISO9906:2012 3B</p> <p>Materials:</p> <p>Pump housing: Cast iron EN-JL1040 ASTM A48-40 B</p> <p>Impeller: Cast iron EN-JL1030 ASTM A48-30 B</p> <p>Installation:</p> <p>Range of ambient temperature: -4 .. 131 °F</p> <p>Maximum operating pressure: 232 psi</p> <p>Flange standard: DIN</p> <p>Pipe connection: DN 125</p> <p>Pump inlet: DN 125</p> <p>Pump outlet: DN 125</p> <p>Pressure stage: PN 16</p> <p>(@): 24.41 in</p> <p>Flange size for motor: FF215</p> <p>Electrical data:</p> <p>Motor type: SIEMENS</p> <p>IE Efficiency class: IE3</p> <p>Rated power - P2: 2 x 3 HP</p> <p>Power (P2) required by pump: 3 HP</p> <p>Main frequency: 50 Hz</p>

Position	Count	Description
		<p>Rated voltage: 3 x 220-240D/380-420Y V</p> <p>Rated current: 9,15-8,30/5,30-4,80 A</p> <p>Starting current: 680-680 %</p> <p>Cos phi - power factor: 0.8</p> <p>Rated speed: 970 rpm</p> <p>IE efficiency: IE3 84,3%</p> <p>Motor efficiency at full load: 84.3-84.3 %</p> <p>Motor efficiency at 3/4 load: 84.9-84.9 %</p> <p>Motor efficiency at 1/2 load: 83.6-83.6 %</p> <p>Number of poles: 6</p> <p>Enclosure class (IEC 34-5): 55 Dust/Jetting</p> <p>Insulation class (IEC 85): F</p> <p>Others:</p> <p>Minimum efficiency index, MEI : 0.62</p> <p>ErP status: EuP Standalone/Prod.</p> <p>Net weight: 825 lb</p> <p>Gross weight: 893 lb</p> <p>Shipping volume: 39.6 ft³</p> <p>Country of origin: HU</p> <p>Custom tariff no.: 84137065</p>

96109690 TPD 125-70/6 A-F-A-BQQE 50 Hz

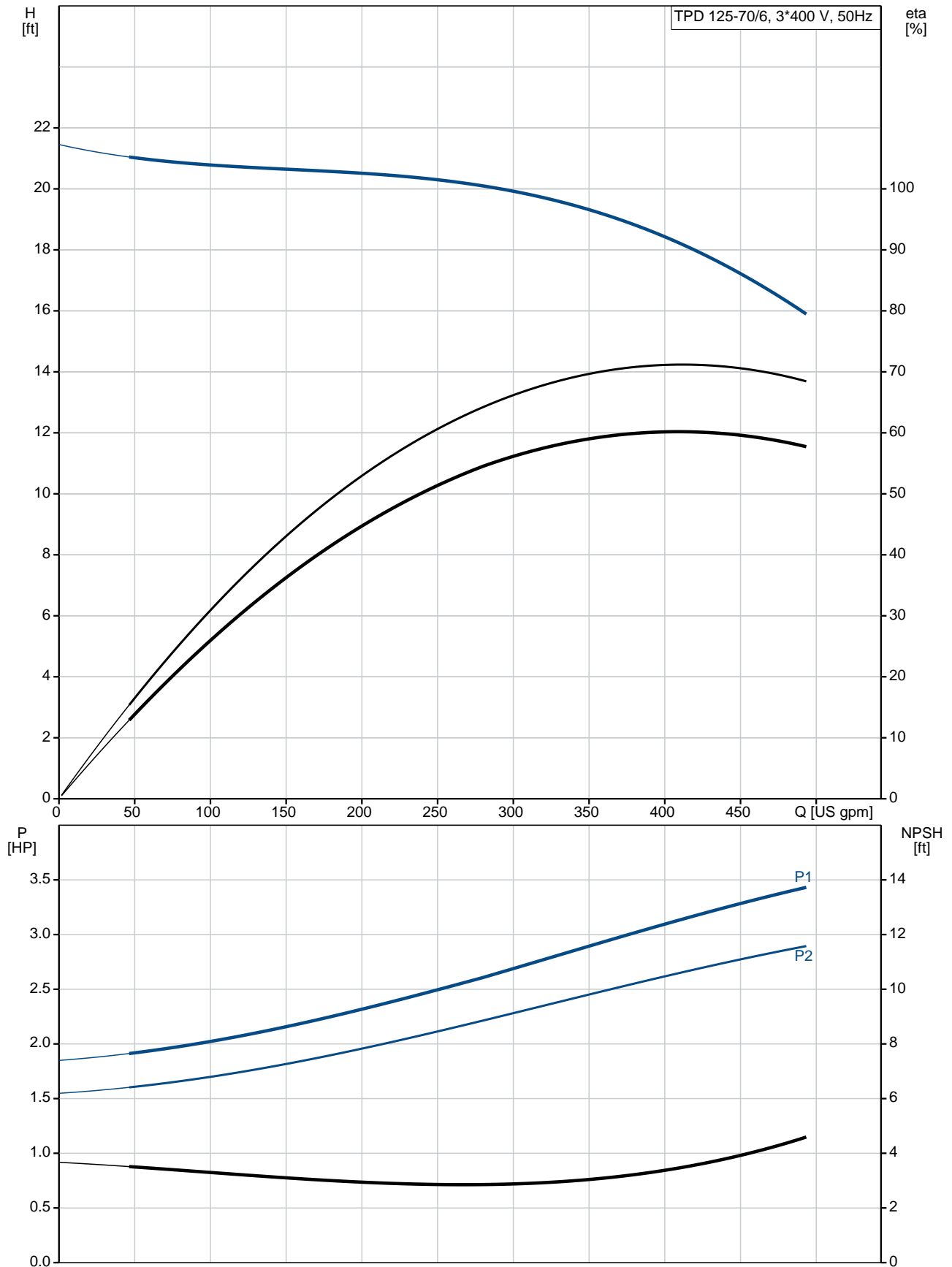

Description	Value
General information:	
Product name:	TPD 125-70/6 A-F-A-BQQE
Product No.:	96109690
EAN:	5700396986746
Technical:	
Rated flow:	412 US gpm
Rated head:	18.01 ft
Head max:	22.97 ft
Actual impeller diameter:	8.5 in
Primary shaft seal:	BQQE
Curve tolerance:	ISO9906:2012 3B
Pump version:	A
Model:	A
Materials:	
Pump housing:	Cast iron
	EN-JL1040
	ASTM A48-40 B
Impeller:	Cast iron
	EN-JL1030
	ASTM A48-30 B
Material code:	A
Installation:	
Range of ambient temperature:	-4 .. 131 °F
Maximum operating pressure:	232 psi
Flange standard:	DIN
Pipe connection:	DN 125
Pump inlet:	DN 125
Pump outlet:	DN 125
Pressure stage:	PN 16
(@)	24.41 in
Flange size for motor:	FF215
Connect code:	F
Liquid:	
Pumped liquid:	Water
Liquid temperature range:	-13 .. 248 °F
Liquid temperature during operation:	68 °F
Density:	62.29 lb/ft³
Electrical data:	
Motor type:	SIEMENS
IE Efficiency class:	IE3
Rated power - P2:	2 x 3 HP
Power (P2) required by pump:	3 HP
Main frequency:	50 Hz
Rated voltage:	3 x 220-240D/380-420Y V
Rated current:	9,15-8,30/5,30-4,80 A
Starting current:	680-680 %
Cos phi - power factor:	0.8
Rated speed:	970 rpm
IE efficiency:	IE3 84,3%
Motor efficiency at full load:	84.3-84.3 %
Motor efficiency at 3/4 load:	84.9-84.9 %
Motor efficiency at 1/2 load:	83.6-83.6 %
Number of poles:	6
Enclosure class (IEC 34-5):	55 Dust/Jetting
Insulation class (IEC 85):	F
Motor protection:	NONE
Motor Number:	83W02208
Others:	

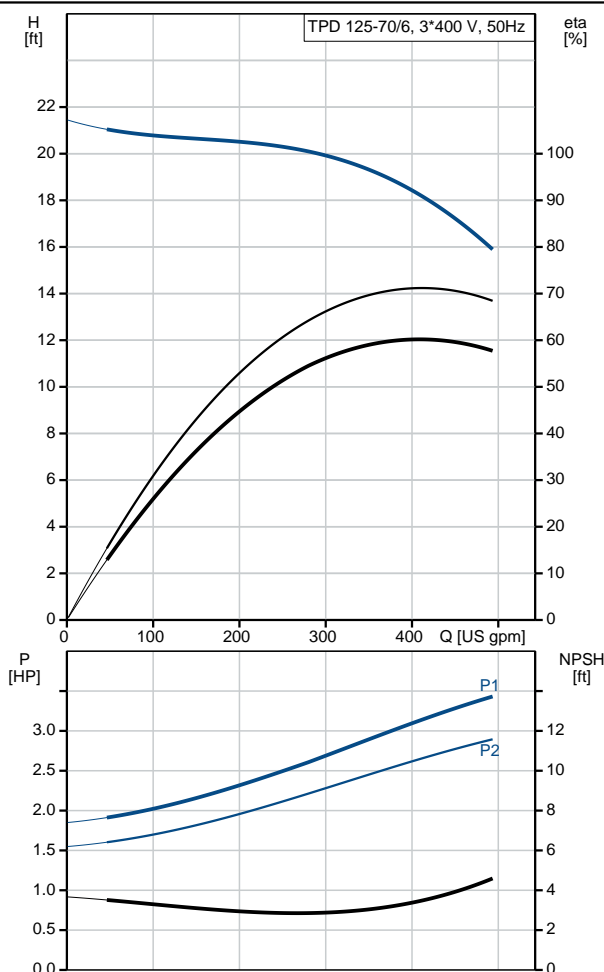



Company name:

Created by:

Phone:

Date:

10/10/2018

Description	Value
Minimum efficiency index, MEI :	0.62
ErP status:	EuP Standalone/Prod.
Net weight:	825 lb
Gross weight:	893 lb
Shipping volume:	39.6 ft³
Country of origin:	HU
Custom tariff no.:	84137065

96109690 TPD 125-70/6 A-F-A-BQQE 50 Hz

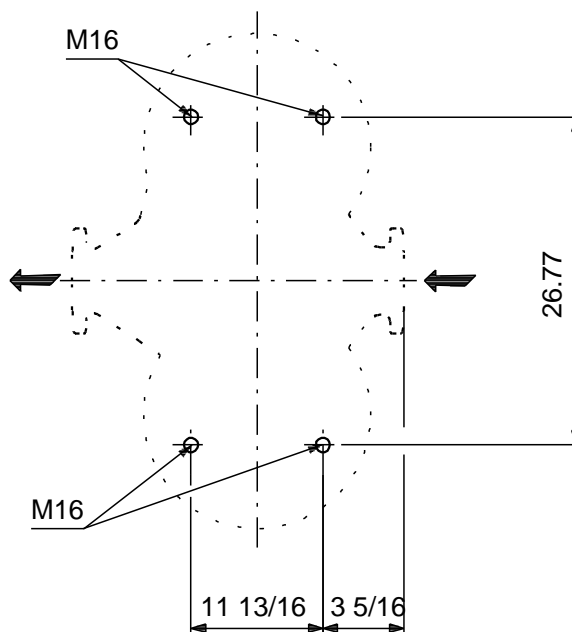
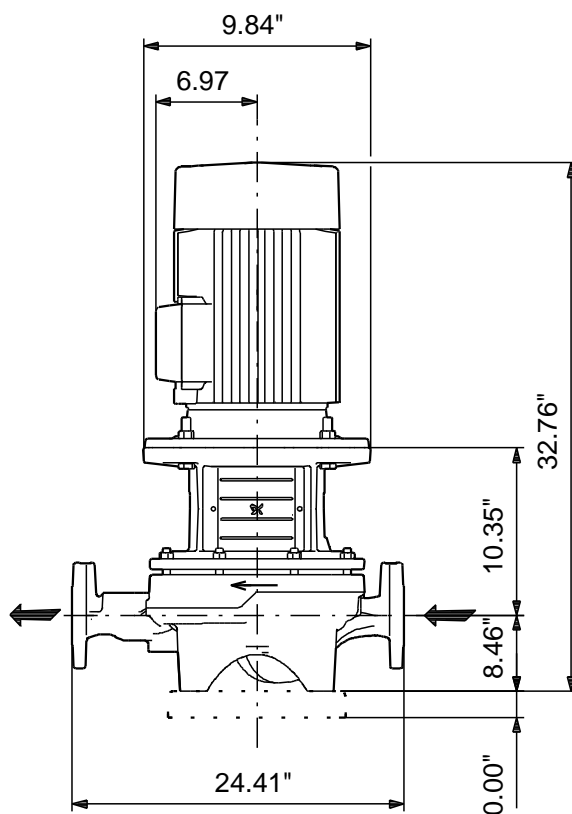
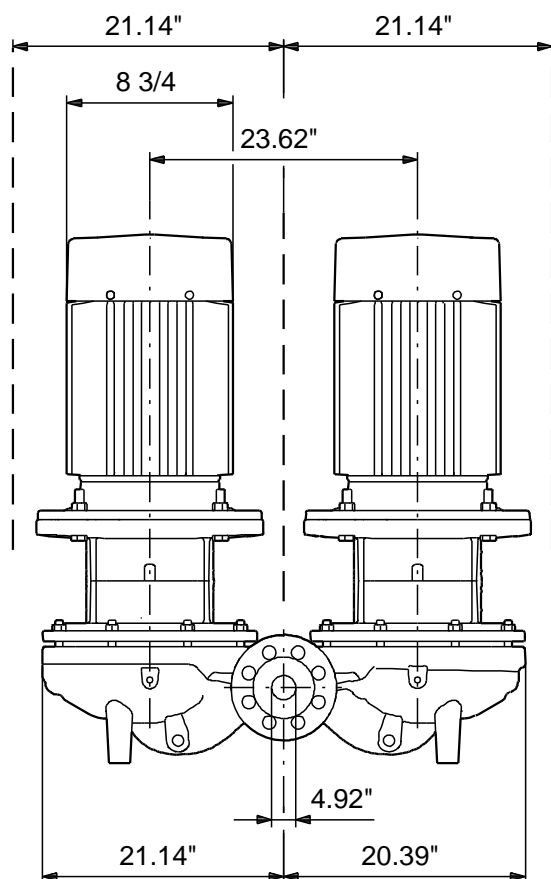

Note! All units are in [mm] unless otherwise stated.
Disclaimer: This simplified dimensional drawing does not show all details.

96109690 TPD 125-70/6 A-F-A-BQQE 50 Hz

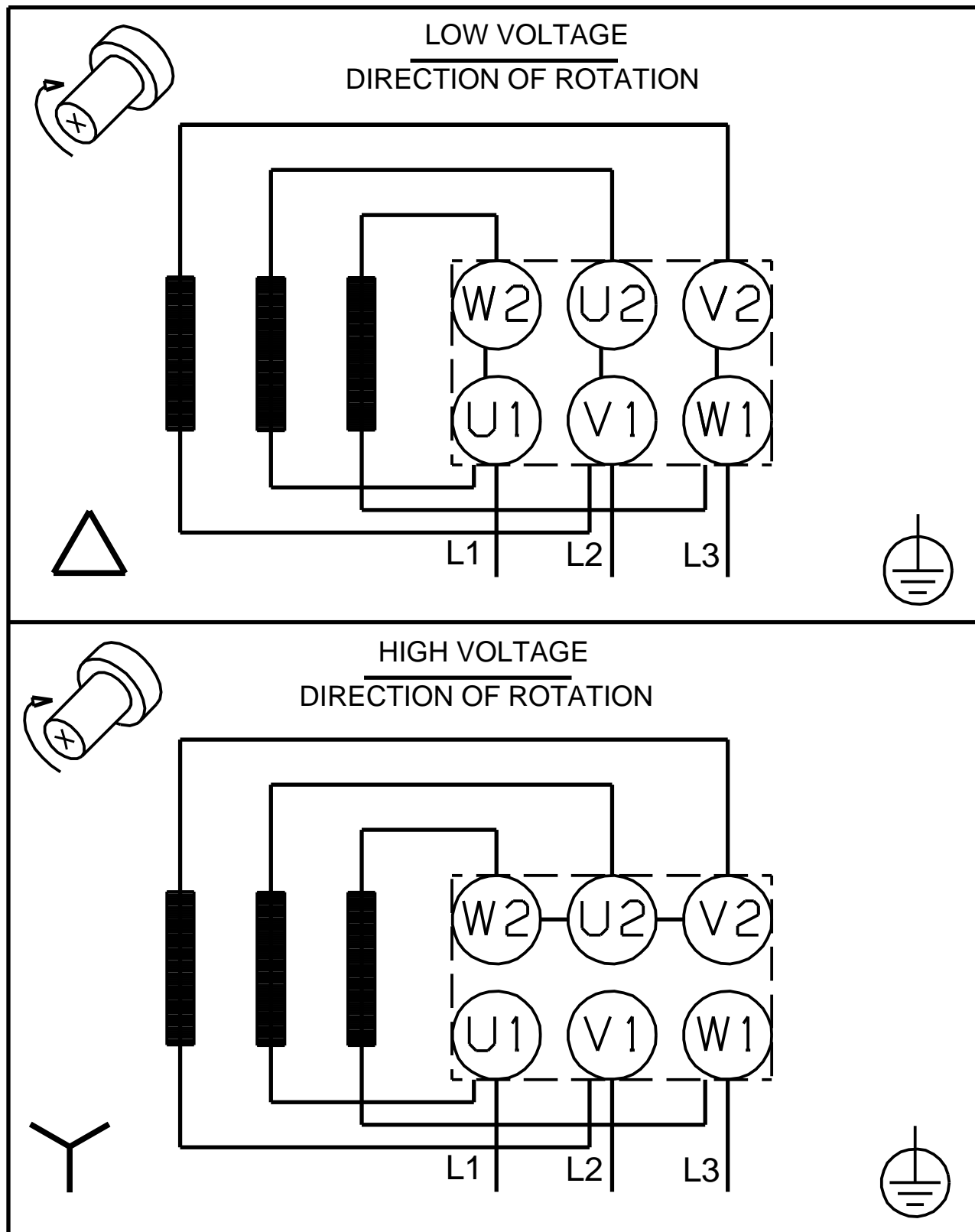

All units are [mm] unless otherwise presented.