

Qty.	Description
1	<p data-bbox="201 338 491 365">CRT 4-12 A-P-A-E-AUUE</p>  <p data-bbox="201 660 469 687">Product No.: 96100773</p> <p data-bbox="201 689 724 777">Vertical, non-self-priming, multistage, in-line, centrifugal pump for installation in pipe systems and mounting on a foundation.</p> <p data-bbox="201 808 679 835">The pump has the following characteristics:</p> <ul data-bbox="240 837 759 864" style="list-style-type: none"> - Impellers, intermediate chambers and outer <p data-bbox="201 866 887 896">Impeller: sleeve are made of Titanium.</p> <p data-bbox="201 898 1131 925">Pump housing: - Pump head cover and base are made of Titanium.</p> <ul data-bbox="240 927 668 954" style="list-style-type: none"> - The shaft seal has assembly length <p data-bbox="201 956 462 983">according to EN 12756.</p> <ul data-bbox="240 985 711 1043" style="list-style-type: none"> - Power transmission is via cast iron split coupling. <p data-bbox="201 1046 927 1104">Flange standard: - Pipework connection is via PJE flanges/couplings.</p> <p data-bbox="201 1135 940 1162">Phase: The motor is a 1-phase AC motor.</p> <p data-bbox="201 1193 277 1220">Liquid:</p> <p data-bbox="201 1223 635 1249">Pumped liquid: Water</p> <p data-bbox="201 1252 707 1279">Liquid temperature range: -20 .. 120 °C</p> <p data-bbox="201 1281 632 1308">Selected liquid temperature: 20 °C</p> <p data-bbox="201 1310 700 1337">Density: 998.2 kg/m³</p> <p data-bbox="201 1368 319 1395">Technical:</p> <p data-bbox="201 1397 821 1424">Pump speed on which pump data are based: 2900 rpm</p> <p data-bbox="201 1426 638 1453">Rated flow: 6 m³/h</p> <p data-bbox="201 1456 643 1482">Rated head: 63.7 m</p> <p data-bbox="201 1485 636 1512">Primary shaft seal: AUUE</p> <p data-bbox="201 1514 641 1541">Approvals on nameplate: CE,TR</p> <p data-bbox="201 1543 764 1570">Curve tolerance: ISO9906:2012 3B</p> <p data-bbox="201 1601 312 1628">Materials:</p> <p data-bbox="201 1630 708 1688">Pump housing: Titanium ASTM B 265</p> <p data-bbox="201 1691 708 1749">Impeller: Titanium ASTM B 265</p> <p data-bbox="201 1751 638 1778">Bush material: NONE</p> <p data-bbox="201 1809 330 1836">Installation:</p> <p data-bbox="201 1839 632 1865">Maximum ambient temperature: 40 °C</p> <p data-bbox="201 1868 734 1926">Max pressure at stated temp: 25 bar / 120 °C 25 bar / -20 °C</p> <p data-bbox="201 1928 614 1955">Flange standard: PJE</p> <p data-bbox="201 1957 663 1984">Pipe connection: 42,4 mm</p> <p data-bbox="201 1986 638 2013">Flange size for motor: FT115</p> <p data-bbox="201 2045 367 2072">Electrical data:</p>

Qty.	Description
	<p>Motor type: 90LC Rated power - P2: 2.2 kW Power (P2) required by pump: 2.2 kW 2.2 kW Mains frequency: 50 Hz Rated voltage: 1 x 220-230/240 V Rated current: 14,0-13,6/12,6 A Starting current: 330 % Cos phi - power factor: 1.00 Rated speed: 2730/2720 rpm Motor efficiency at full load: 75 % Number of poles: 2 Enclosure class (IEC 34-5): 55 Dust/Jetting Insulation class (IEC 85): F Motor No: 85215708</p> <p>Others: Minimum efficiency index, MEI η_{min}: 0.7 Net weight: 36.6 kg Gross weight: 41.6 kg</p>

96100773 CRT 4-12 A-P-A-E-AUUE 50 Hz

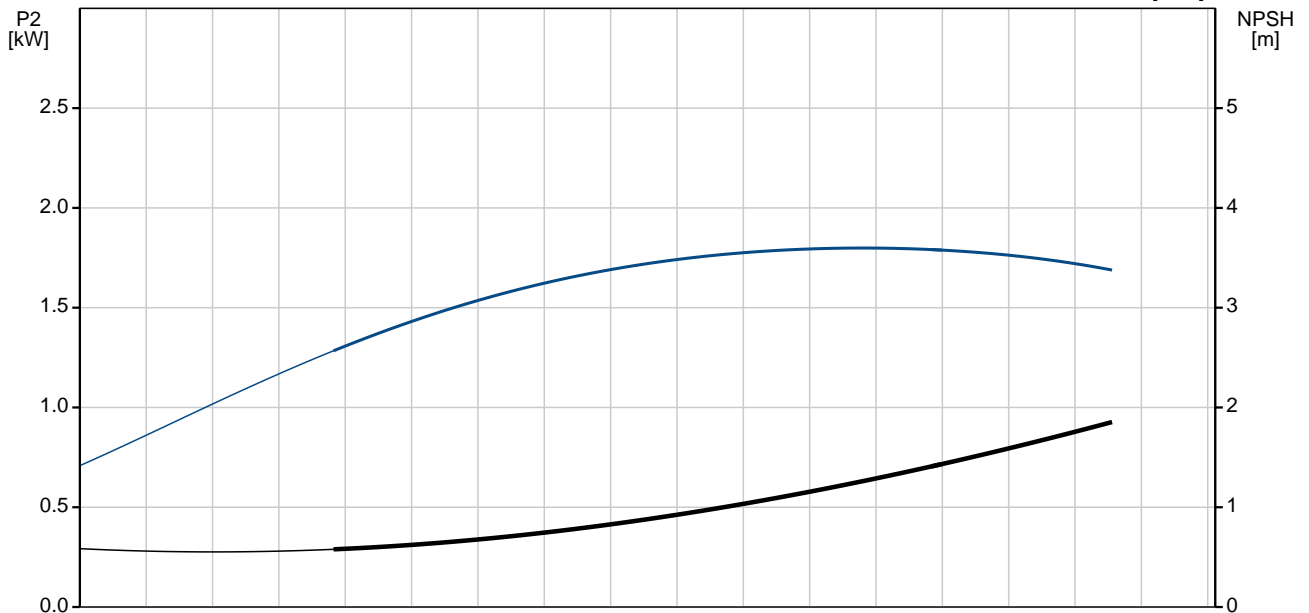
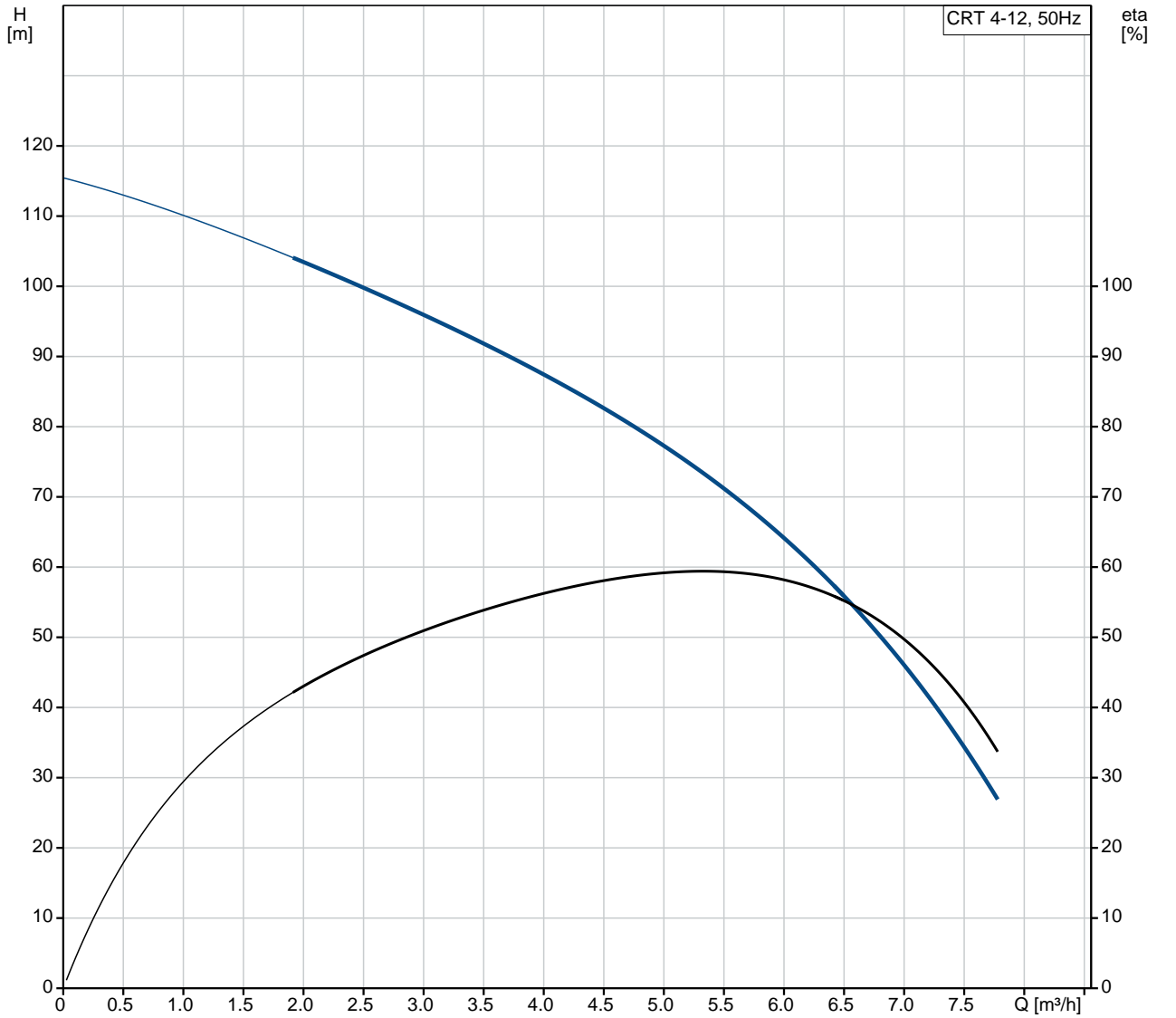

Description	Value
General information:	
Product name:	CRT 4-12 A-P-A-E-AUUE
Product No:	96100773
EAN number:	5700395848885
Price:	
Technical:	
Pump speed on which pump data are based:	2900 rpm
Rated flow:	6 m ³ /h
Rated head:	63.7 m
Maximum head:	121 m
Head max:	121 m
Stages:	12
Impellers:	12
Primary shaft seal:	AUUE
Approvals on nameplate:	CE,TR
Curve tolerance:	ISO9906:2012 3B
Pump version:	A
Model:	A
Materials:	
Pump housing:	Titanium
Pump housing:	ASTM B 265
Impeller:	Titanium
Impeller:	ASTM B 265
Material code:	A
Code for rubber:	E
Bush material:	NONE
Installation:	
Maximum ambient temperature:	40 °C
Max pressure at stated temp:	25 bar / 120 °C
Max pressure at stated temp:	25 bar / -20 °C
Flange standard:	PJE
Pipe connection:	42,4 mm
Flange size for motor:	FT115
Connect code:	P
Liquid:	
Pumped liquid:	Water
Liquid temperature range:	-20 .. 120 °C
Selected liquid temperature:	20 °C
Density:	998.2 kg/m ³
Electrical data:	
Motor type:	90LC
Rated power - P2:	2.2 kW
Power (P2) required by pump:	2.2 kW
Power (P2) required by pump:	2.2 kW
Mains frequency:	50 Hz
Rated voltage:	1 x 220-230/240 V
Rated current:	14,0-13,6/12,6 A
Starting current:	330 %
Cos phi - power factor:	1.00
Rated speed:	2730/2720 rpm
Motor efficiency at full load:	75 %
Number of poles:	2
Enclosure class (IEC 34-5):	55 Dust/Jetting
Insulation class (IEC 85):	F
Motor protec:	PTO
Motor No:	85215708
Others:	

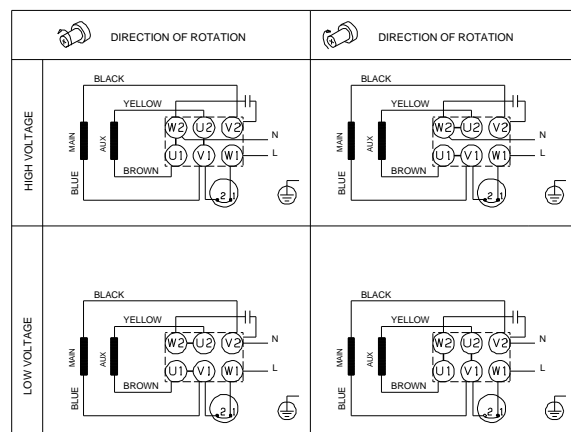
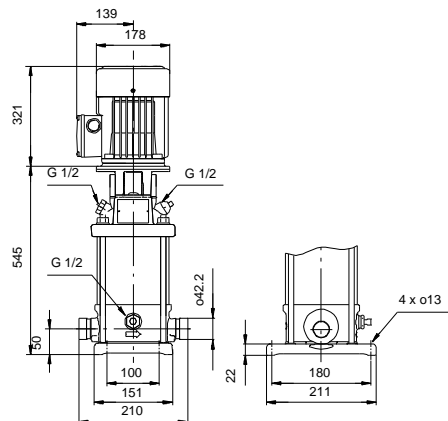
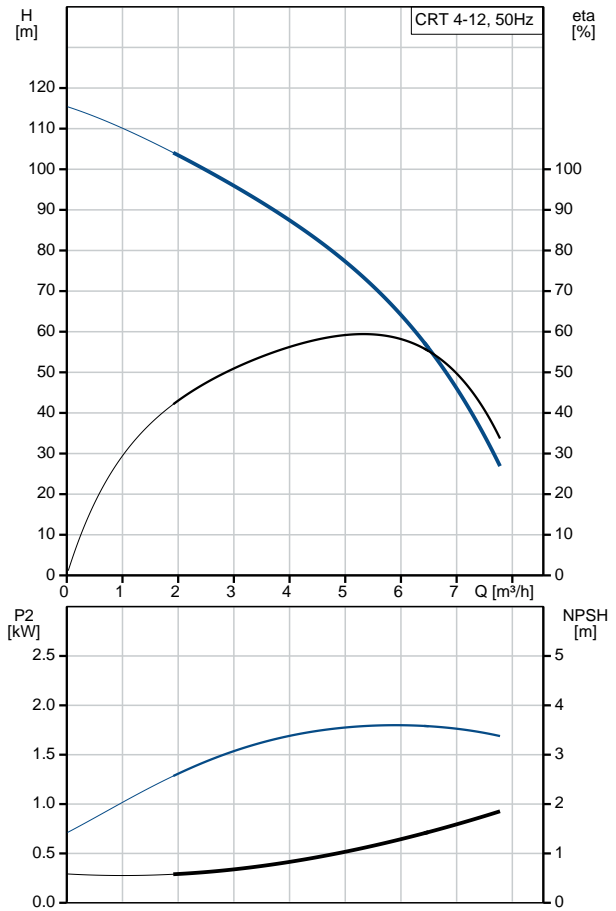



Company name:

Created by:

Phone:

Date:

19/01/2021

Description	Value
Minimum efficiency index, MEI %:	0.7
Net weight:	36.6 kg
Gross weight:	41.6 kg

96100773 CRT 4-12 A-P-A-E-AUUE 50 Hz

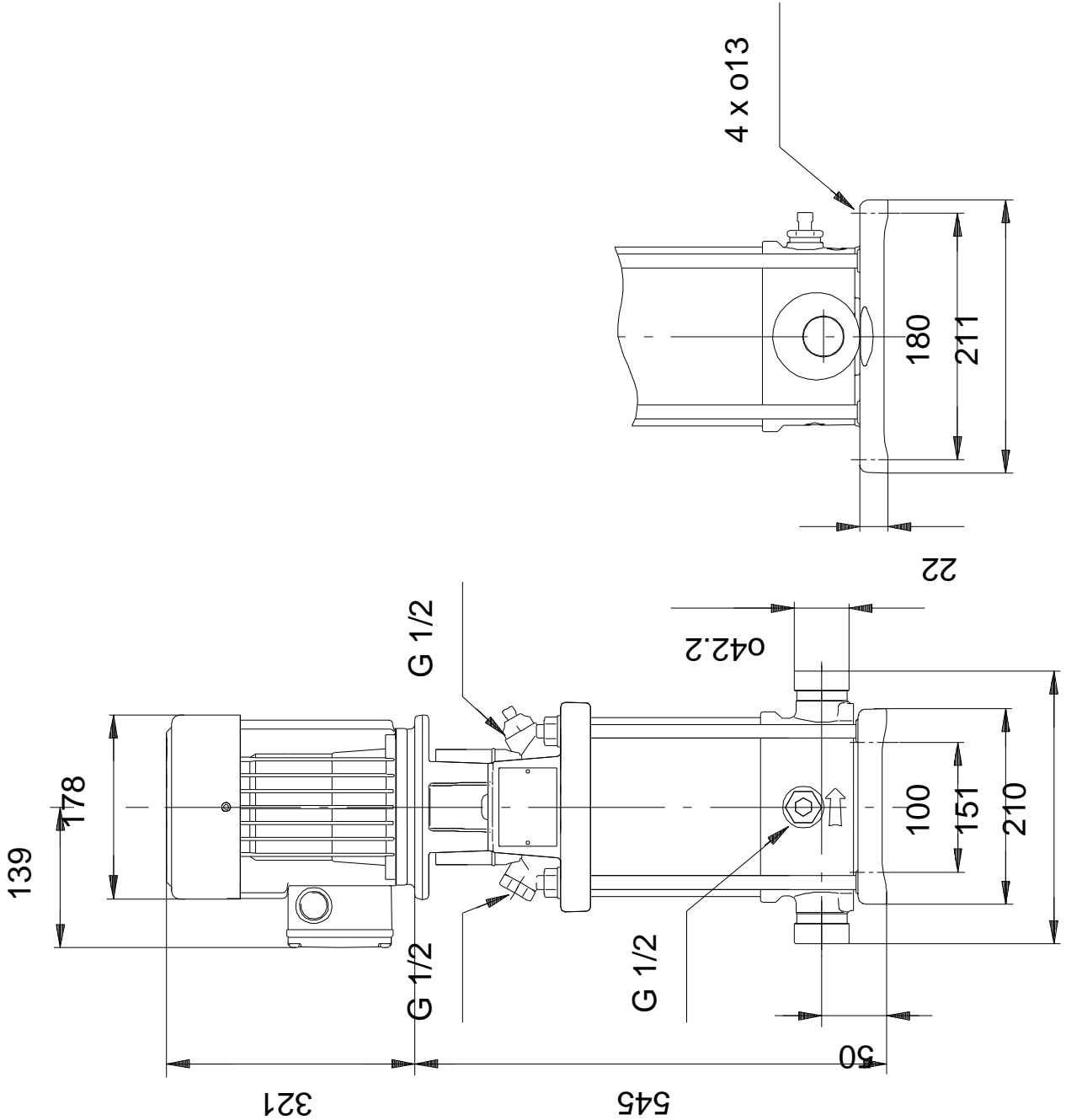

Note! All units are in [mm] unless others are stated.
Disclaimer: This simplified dimensional drawing does not show all details.

96100773 CRT 4-12 A-P-A-E-AUUE 50 Hz

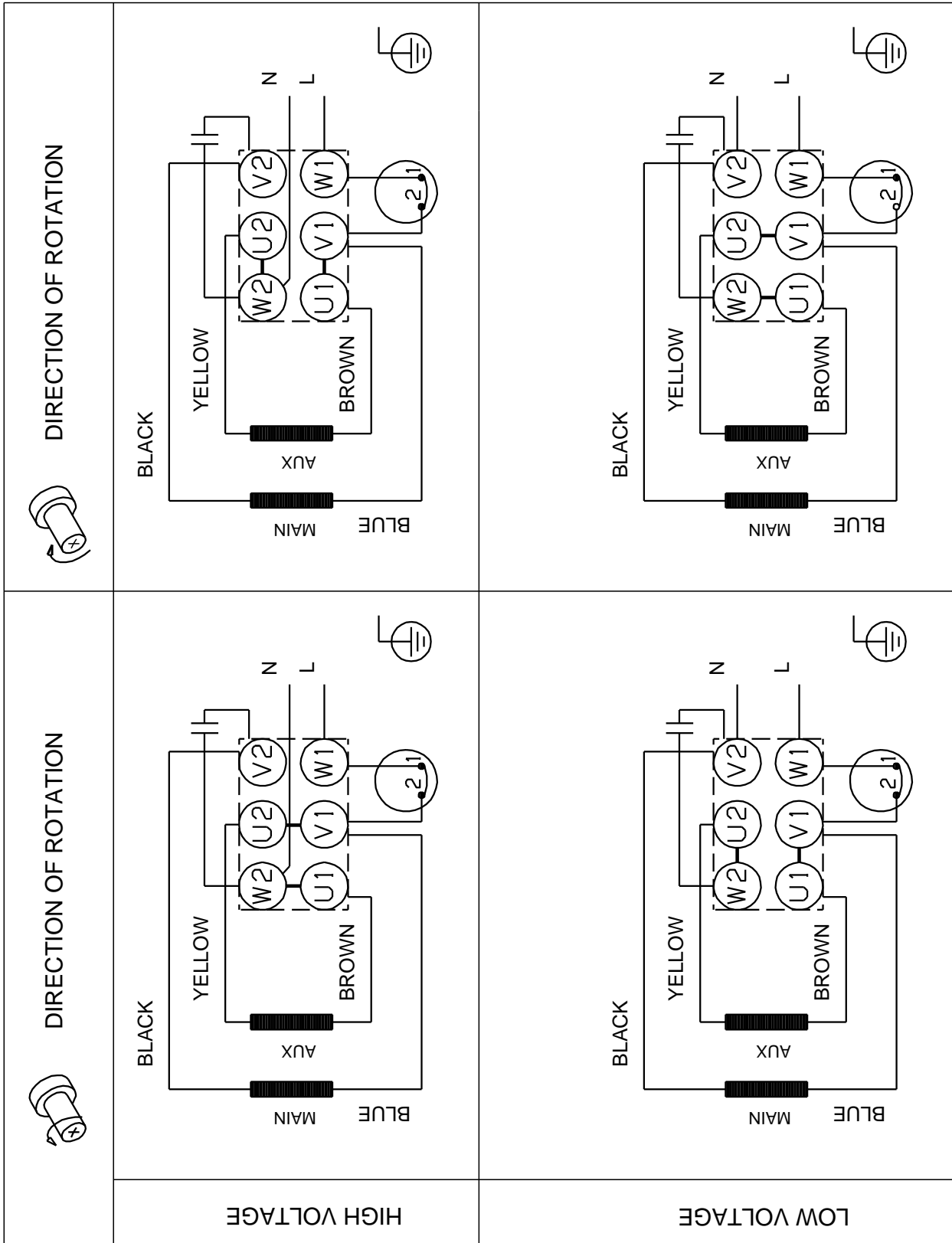

Note! All units are in [mm] unless others are stated.