

| Position | Qty. | Description   |
|----------|------|---|
|          | 1    | <p><b>TPD 50-160/2 A-F-A-BQQE</b></p>  <p>Product No.: <a href="#">96087061</a></p> <p>Single-stage, close-coupled, volute twin-head pump with in-line suction and discharge ports of identical diameter. The twin-head pump is designed with two parallel power-heads. The pump is of the top-pull-out design, i.e. the power head (motor, pump head and impeller) can be removed for maintenance or service while the pump housing remains in the pipework.</p> <p>Each power head is fitted with an unbalanced rubber bellows seal. The shaft seal is according to EN 12756. Pipework connection is via PN 16 DIN flanges (EN 1092-2 and ISO 7005-2).</p> <p>Each power head is fitted with a fan-cooled asynchronous motor of identical size.</p> <p><b>Liquid:</b></p> <p>Pumped liquid: Water</p> <p>Liquid temperature range: -25 .. 120 °C</p> <p>Liquid temperature during operation: 20 °C</p> <p>Density: 998.2 kg/m³</p> <p><b>Technical:</b></p> <p>Rated flow: 17 m³/h</p> <p>Rated head: 12 m</p> <p>Actual impeller diameter: 110 mm</p> <p>Primary shaft seal: BQQE</p> <p>Curve tolerance: ISO9906:2012 3B</p> <p><b>Materials:</b></p> <p>Pump housing: Cast iron<br/>EN-JL1040<br/>ASTM A48-40 B</p> <p>Impeller: Cast iron<br/>EN-JL1030<br/>ASTM A48-30 B</p> <p><b>Installation:</b></p> <p>Range of ambient temperature: -30 .. 60 °C</p> <p>Maximum operating pressure: 16 bar</p> <p>Flange standard: DIN</p> <p>Pipe connection: DN 50</p> <p>Pump inlet: DN 50</p> <p>Pump outlet: DN 50</p> <p>Pressure rating: PN 16</p> <p>(@): 340 mm</p> <p>Flange size for motor: FF165</p> <p><b>Electrical data:</b></p> <p>Motor type: 80C</p> <p>IE Efficiency class: IE3</p> <p>Rated power - P2: 2 x 1.1 kW</p> <p>Power (P2) required by pump: 1.1 kW</p> <p>Mains frequency: 50 Hz</p> |

| Position | Qty. | Description   |
|----------|------|---|
|          |      | <p>Rated voltage: 3 x 220-240D/380-415Y V</p> <p>Rated current: 4.35/2.50 A</p> <p>Starting current: 450-500 %</p> <p>Cos phi - power factor: 0.83-0.76</p> <p>Rated speed: 2840-2870 rpm</p> <p>Efficiency: IE3 82,7%</p> <p>Motor efficiency at full load: 82.7 %</p> <p>Motor efficiency at 3/4 load: 84.6 %</p> <p>Motor efficiency at 1/2 load: 85.4 %</p> <p>Number of poles: 2</p> <p>Enclosure class (IEC 34-5): 55 Dust/Jetting</p> <p>Insulation class (IEC 85): F</p> <p><b>Others:</b></p> <p>Minimum efficiency index, MEI : 0.70</p> <p>ErP status: EuP Standalone/Prod.</p> <p>Net weight: 89 kg</p> <p>Gross weight: 103 kg</p> <p>Shipping volume: 0.39 m³</p> <p>Country of origin: HU</p> <p>Custom tariff no.: 84137065</p> |

## 96087061 TPD 50-160/2 A-F-A-BQQE 50 Hz

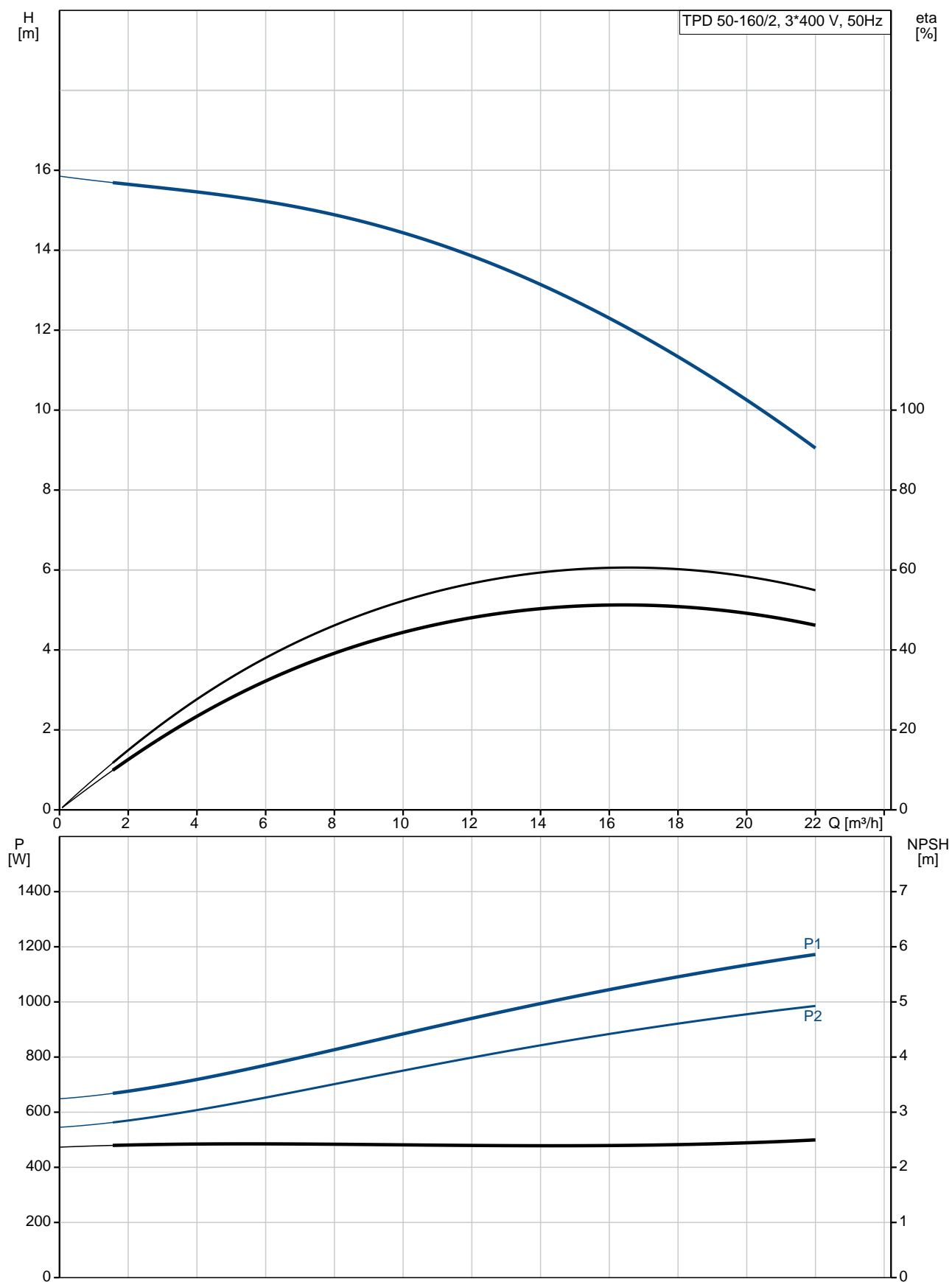

| Description                          | Value                   |
|--------------------------------------|-------------------------|
| <b>General information:</b>          |                         |
| Product name:                        | TPD 50-160/2 A-F-A-BQQE |
| Product No:                          | 96087061                |
| EAN number:                          | 5700395310177           |
| Price:                               | 2.865,00 GBP            |
| <b>Technical:</b>                    |                         |
| Rated flow:                          | 17 m³/h                 |
| Rated head:                          | 12 m                    |
| Head max:                            | 160 dm                  |
| Actual impeller diameter:            | 110 mm                  |
| Primary shaft seal:                  | BQQE                    |
| Curve tolerance:                     | ISO9906:2012 3B         |
| Pump version:                        | A                       |
| Model:                               | A                       |
| <b>Materials:</b>                    |                         |
| Pump housing:                        | Cast iron               |
|                                      | EN-JL1040               |
|                                      | ASTM A48-40 B           |
| Impeller:                            | Cast iron               |
|                                      | EN-JL1030               |
|                                      | ASTM A48-30 B           |
| Material code:                       | A                       |
| <b>Installation:</b>                 |                         |
| Range of ambient temperature:        | -30 .. 60 °C            |
| Maximum operating pressure:          | 16 bar                  |
| Flange standard:                     | DIN                     |
| Pipe connection:                     | DN 50                   |
| Pump inlet:                          | DN 50                   |
| Pump outlet:                         | DN 50                   |
| Pressure rating:                     | PN 16                   |
| (@)                                  | 340 mm                  |
| Flange size for motor:               | FF165                   |
| Connect code:                        | F                       |
| <b>Liquid:</b>                       |                         |
| Pumped liquid:                       | Water                   |
| Liquid temperature range:            | -25 .. 120 °C           |
| Liquid temperature during operation: | 20 °C                   |
| Density:                             | 998.2 kg/m³             |
| <b>Electrical data:</b>              |                         |
| Motor type:                          | 80C                     |
| IE Efficiency class:                 | IE3                     |
| Rated power - P2:                    | 2 x 1.1 kW              |
| Power (P2) required by pump:         | 1.1 kW                  |
| Mains frequency:                     | 50 Hz                   |
| Rated voltage:                       | 3 x 220-240D/380-415Y V |
| Rated current:                       | 4.35/2.50 A             |
| Starting current:                    | 450-500 %               |
| Cos phi - power factor:              | 0.83-0.76               |
| Rated speed:                         | 2840-2870 rpm           |
| Efficiency:                          | IE3 82,7%               |
| Motor efficiency at full load:       | 82.7 %                  |
| Motor efficiency at 3/4 load:        | 84.6 %                  |
| Motor efficiency at 1/2 load:        | 85.4 %                  |
| Number of poles:                     | 2                       |
| Enclosure class (IEC 34-5):          | 55 Dust/Jetting         |
| Insulation class (IEC 85):           | F                       |
| Motor protec:                        | NONE                    |
| Motor No:                            | 87120286                |

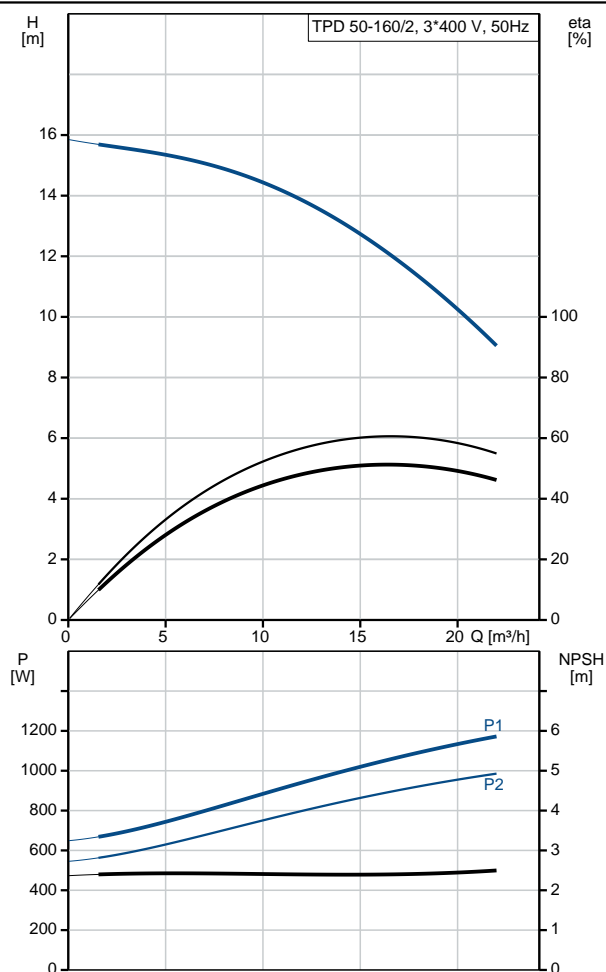



Company name:

Created by:

Phone:

Date:

11/10/2018

| Description                     | Value                |
|---------------------------------|----------------------|
| <b>Others:</b>                  |                      |
| Minimum efficiency index, MEI : | 0.70                 |
| ErP status:                     | EuP Standalone/Prod. |
| Net weight:                     | 89 kg                |
| Gross weight:                   | 103 kg               |
| Shipping volume:                | 0.39 m <sup>3</sup>  |
| Country of origin:              | HU                   |
| Custom tariff no.:              | 84137065             |

## 96087061 TPD 50-160/2 A-F-A-BQQE 50 Hz

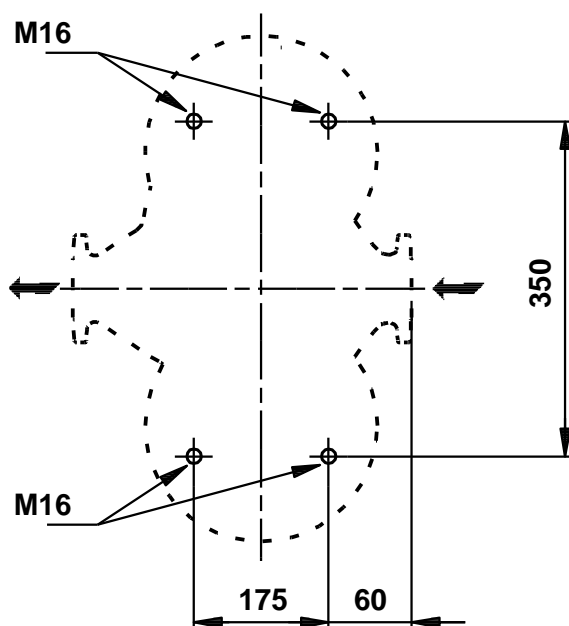
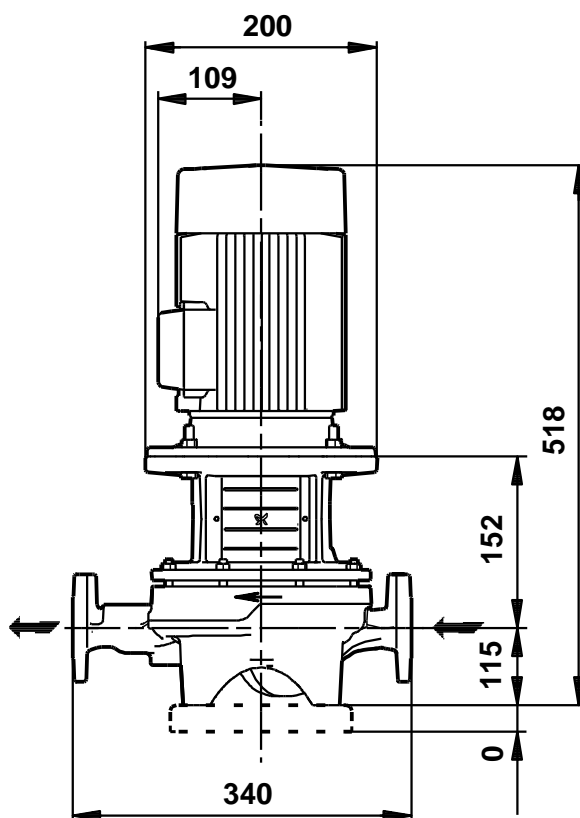
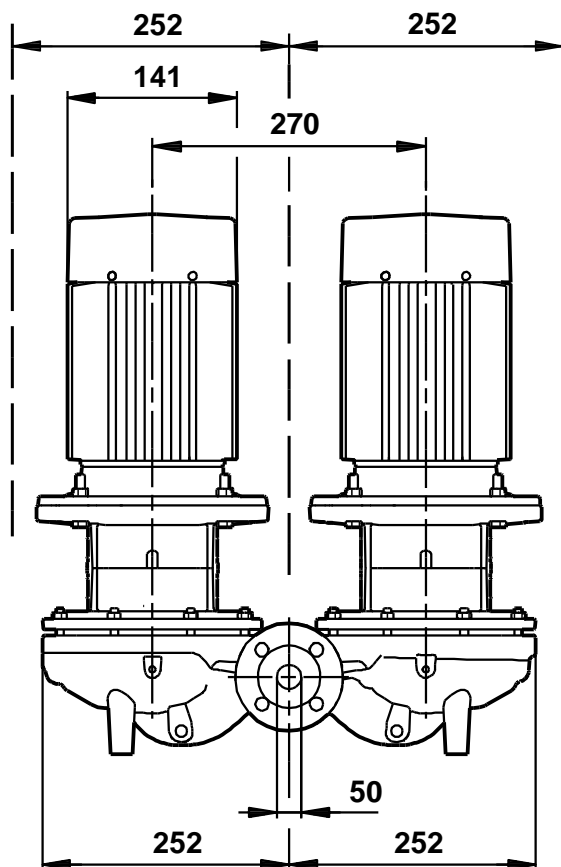

Note! All units are in [mm] unless others are stated.  
Disclaimer: This simplified dimensional drawing does not show all details.

## 96087061 TPD 50-160/2 A-F-A-BQQE 50 Hz

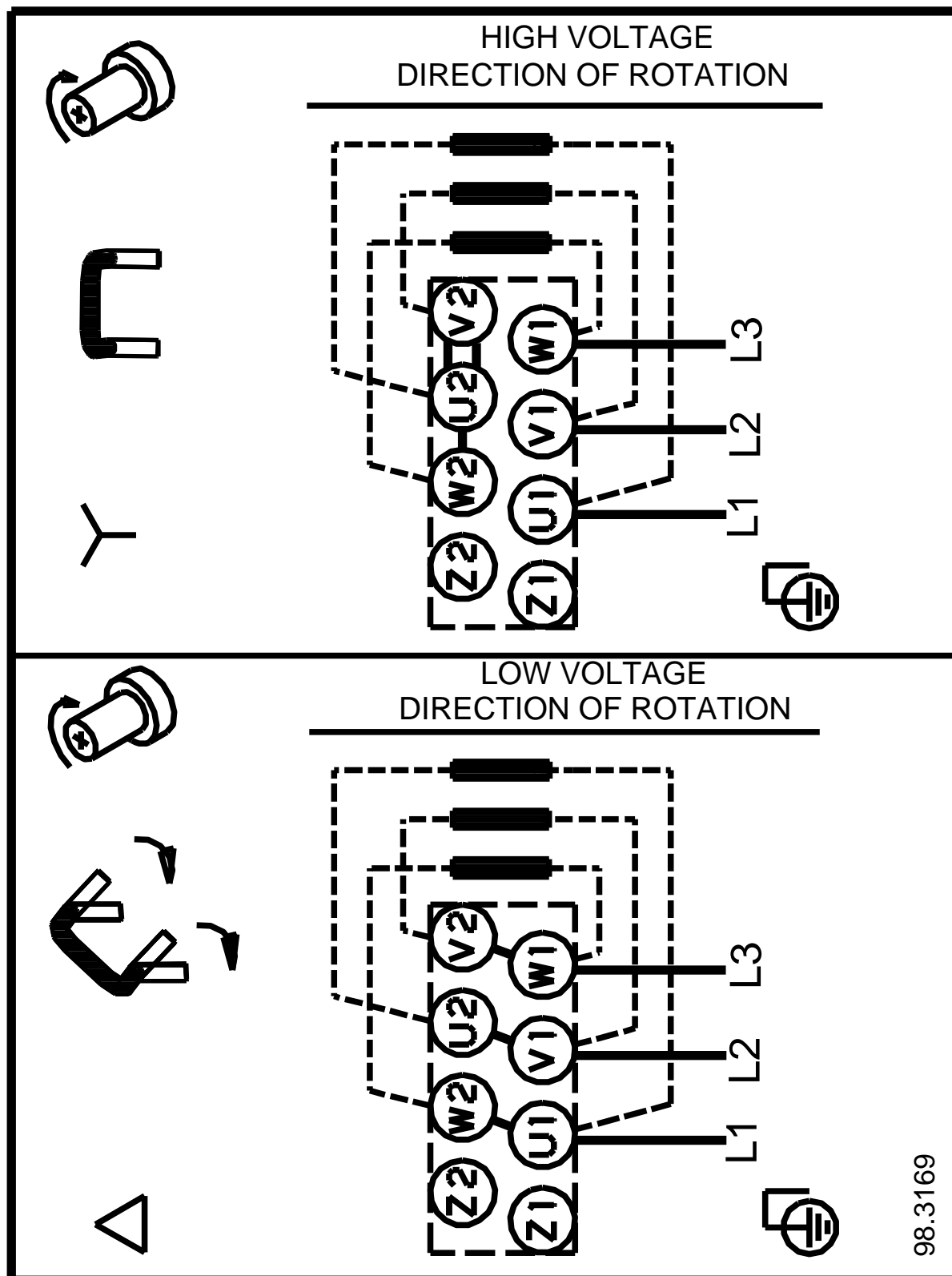

98.3169

Note! All units are in [mm] unless others are stated.